

8HP90A 1091 030 xxx, 8HP90AHIS 1091 034 xxx
 8HP90A74 1091 040 xxx
 8 SPEED AWD (Full Electronic Control)



AUTOMATIC CHOICE



THE AUTOMATIC TRANSMISSION PARTS WAREHOUSE

A

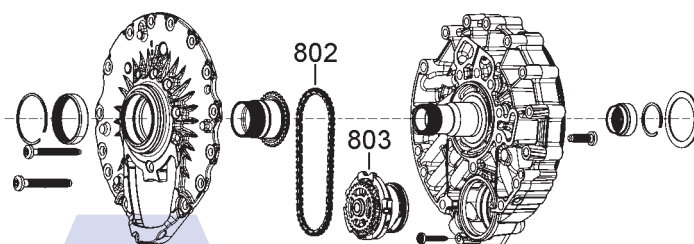

Oil Pump

B

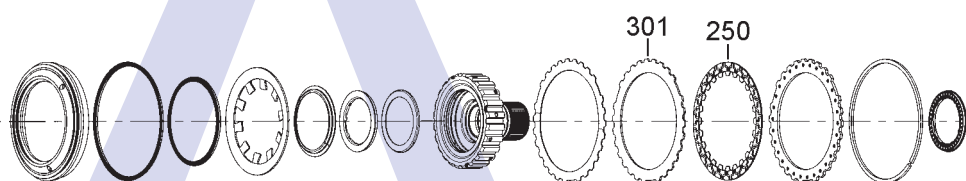

'A' Clutch

C

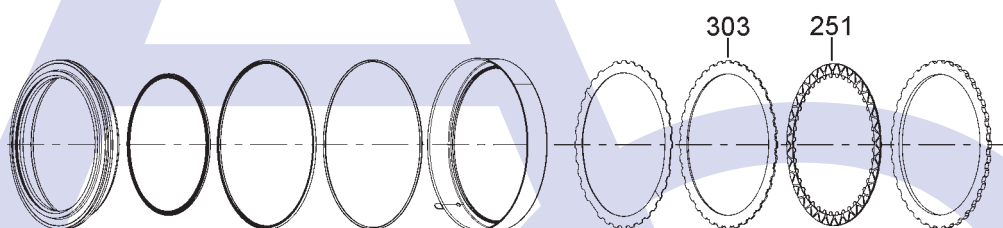

'B' Clutch

D

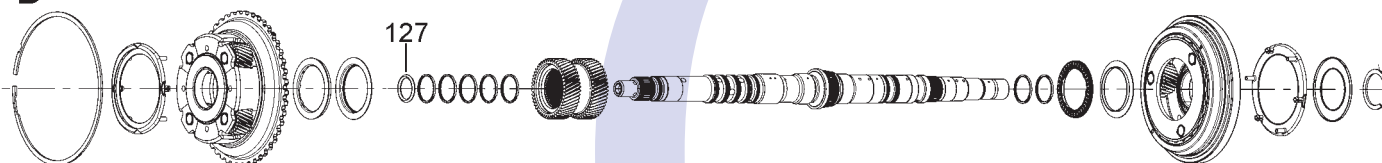

Planetary Gear Set No.1

Planetary Gear Set No. 2

E

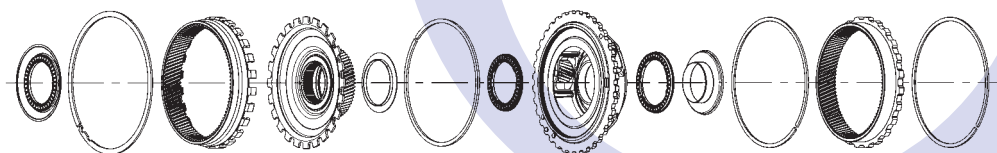

Planetary Gear Set No.3

F

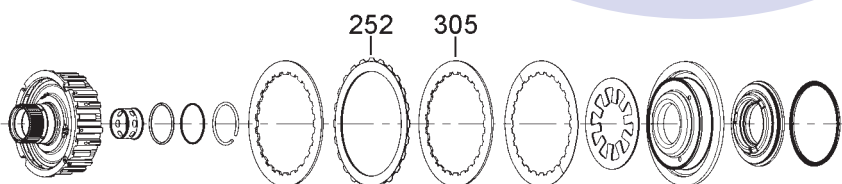

'E' Clutch

8HP90A 1091 030 xxx, 8HP90AHIS 1091 034 xxx
 8HP90A74 1091 040 xxx
 8 SPEED AWD (Full Electronic Control)



AUTOMATIC CHOICE



THE AUTOMATIC TRANSMISSION PARTS WAREHOUSE

G

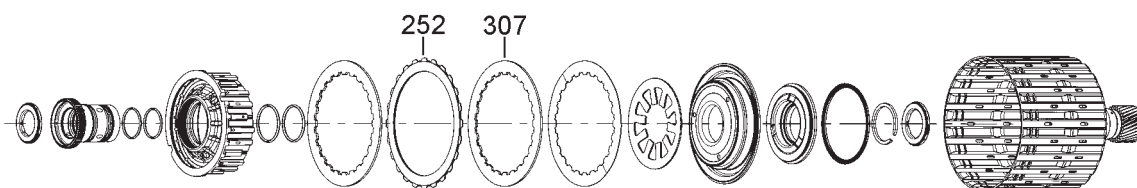

'C' Clutch

H

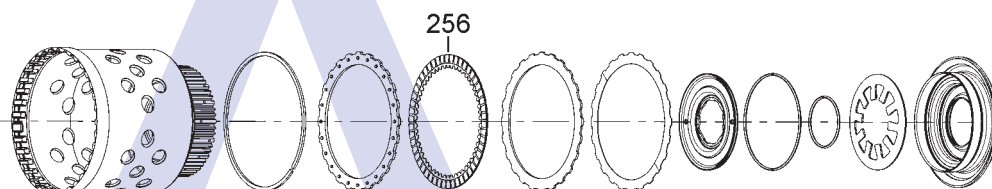

'D' Clutch

J

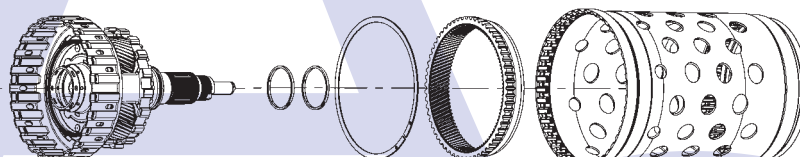

Planetary Gear Set No. 4

K

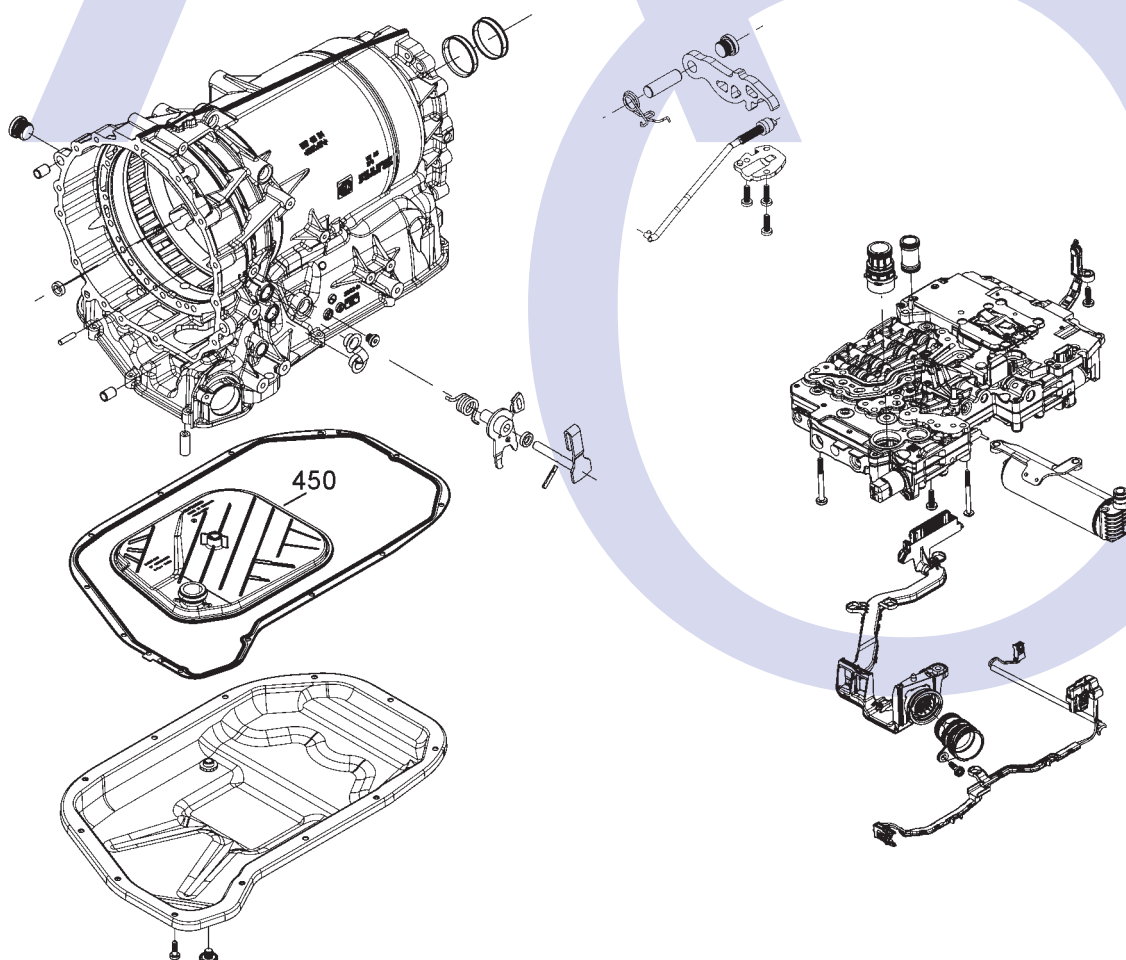

8HP90A 1091 030 xxx, 8HP90AHIS 1091 034 xxx
8HP90A74 1091 040 xxx
8 SPEED AWD (Full Electronic Control)



AUTOMATIC CHOICE



THE AUTOMATIC TRANSMISSION PARTS WAREHOUSE

L

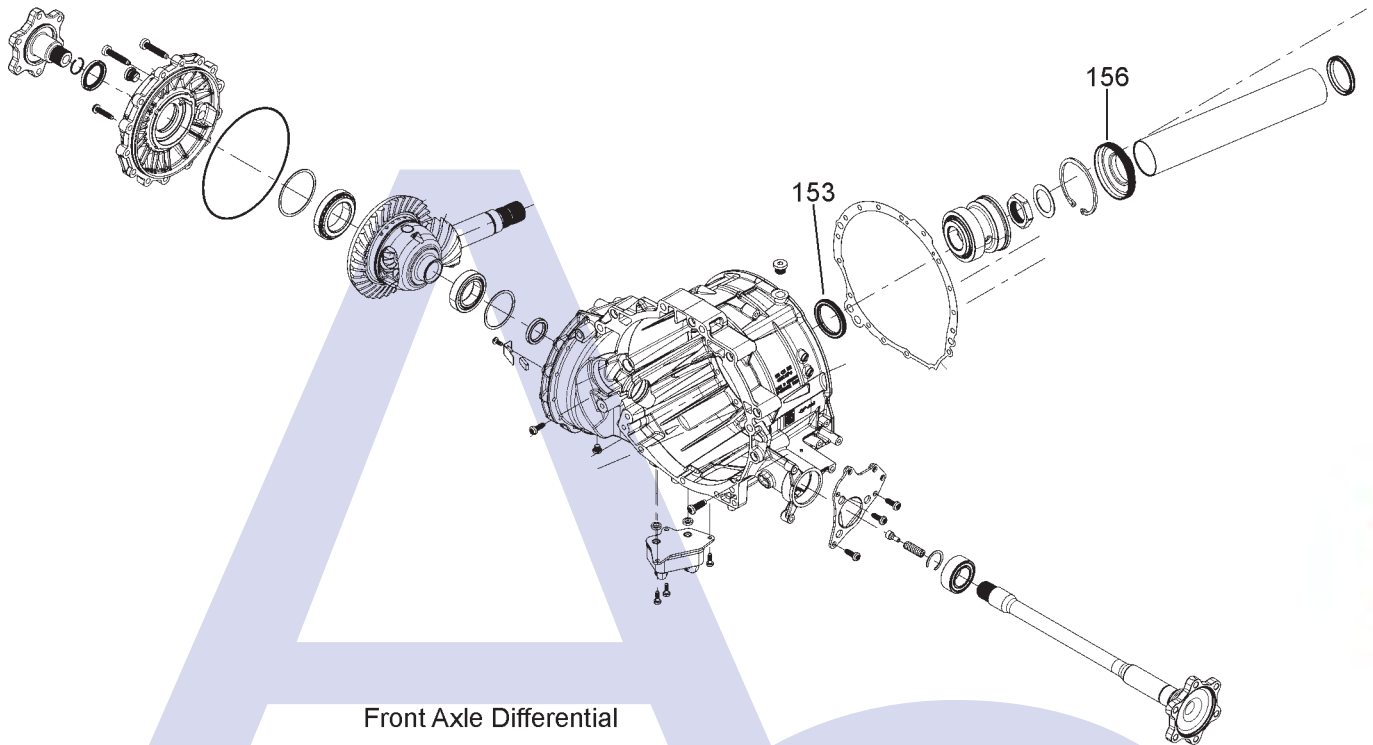

Front Axle Differential

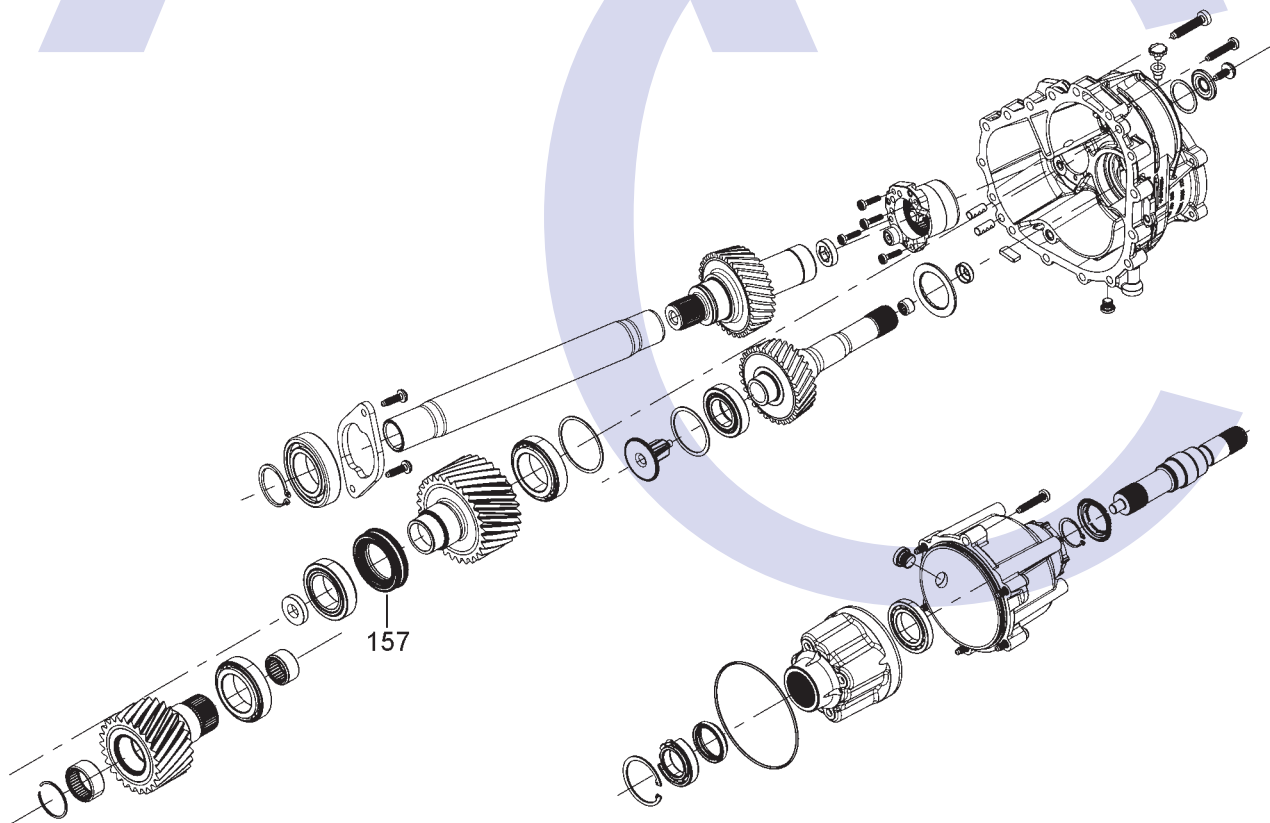

Front Axle Output

Rear Axle Output

8HP90A 1091 030 xxx, 8HP90AHIS 1091 034 xxx

8HP90A74 1091 040 xxx

8 SPEED AWD (Full Electronic Control)



AUTOMATIC CHOICE



THE AUTOMATIC TRANSMISSION PARTS WAREHOUSE

ILL NO.	DESCRIPTION	YEARS	QTY	PART NO
KITS				
GASKETS				
RUBBER COMPONENTS				
127D	'O' Ring, Input Shaft Lock Up....	All	1	8HP45.OR02
METAL CLAD SEALS				
153L	Converter Seal (Transtec®).....	All	1	8HP55A.MCS01
156L	Font Axle Diff, Pinion Shaft	10-ON	1	6HP28A.MCS01
157L	Front Axle Output, Input Gear...	10-ON	1	8HP55A.MCS02
MOULDED PISTONS				
SEALING RINGS				
FRICTION PLATES				
250B	'A' Clutch	All	6	8HP70.FRP01
251C	'B' Clutch	All	5	8HP90.FRP02
252F	'E' Clutch (Outer Teeth).....	All	7	8HP70.FRP03
253G	'C' Clutch (Outer Teeth).....	All	7	8HP70.FRP03
256H	'D' Clutch.....	All	5	8HP70.FRP04
STEEL PLATES				
301B	'A' Clutch	All	6	8HP70.STP01
303C	'B' Clutch	All	5	8HP70.STP02
305F	'E' Clutch (Inner Teeth).....	All	7	8HP70.STP03
307G	'C' Clutch (Inner Teeth)	All	7	8HP70.STP03
PRESSURE PLATES				
SPRINGS & CIRCLIPS				
FILTERS				
450K	Filter, (OEM).....	10-ON	1	8HP55A.FIL01

ILL NO.	DESCRIPTION	YEARS	QTY	PART NO
BUSHINGS				
THRUST WASHERS & BEARINGS				
ELECTRICAL COMPONENTS				
VALVE BODY PARTS				
HARD PARTS				
802A	Drive Chain, Oil Pump	All	1	8HP55A.CH01
803A	Oil Pump	All	1	8HP45.PUM01
SPECIAL ITEMS				
NI	LifeGuardFluid8 Transmission Fluid			
	(1 x 1 Ltr Bottle)	All	AR	OIL.67
	(1 x 10 Ltr Canister)	All	AR	OIL.77
	(1 x 20 Ltr Canister)	All	AR	OIL.68
	(1 x 209 Ltr Barrel).....	All	AR	OIL.65
TOOLS & MANUALS				

8 SPEED AWD (Full Electronic Control)



AUTOMATIC CHOICE



THE AUTOMATIC TRANSMISSION PARTS WAREHOUSE

[illegible][illegible]