

# 8 SPEED RWD (Full Electronic Control)



AUTOMATIC CHOICE



THE AUTOMATIC TRANSMISSION PARTS WAREHOUSE

A

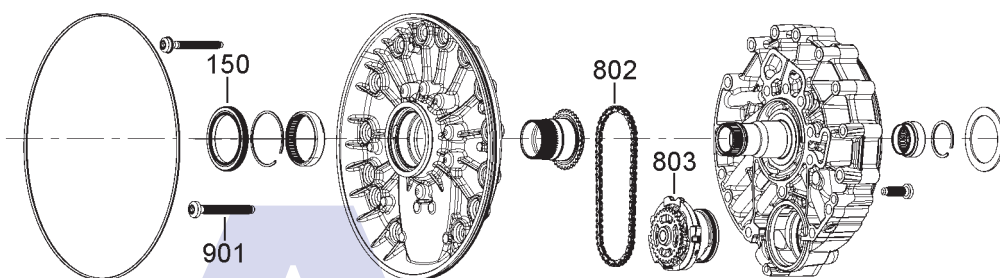

Oil Pump

B

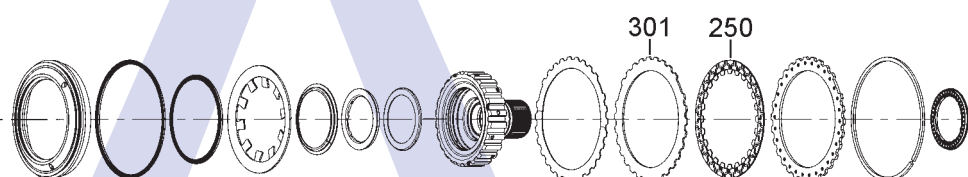

'A' Clutch

C

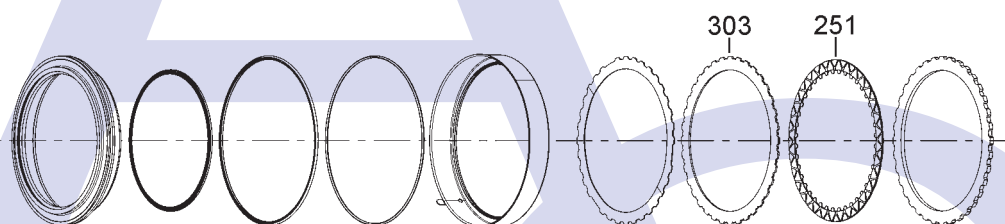

'B' Clutch

D

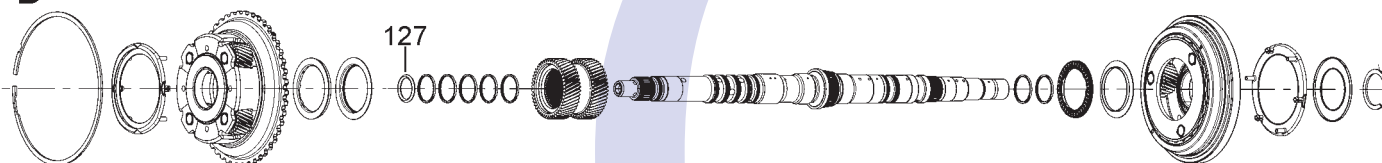

Planetary Gear Set No.1

Planetary Gear Set No. 2

E

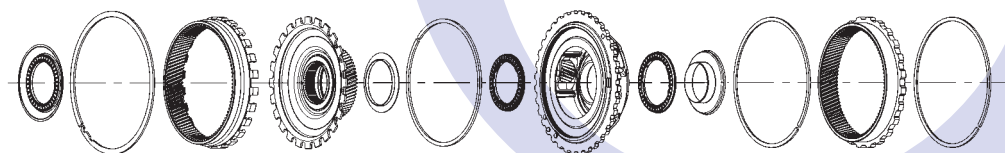

Planetary Gear Set No.3

F

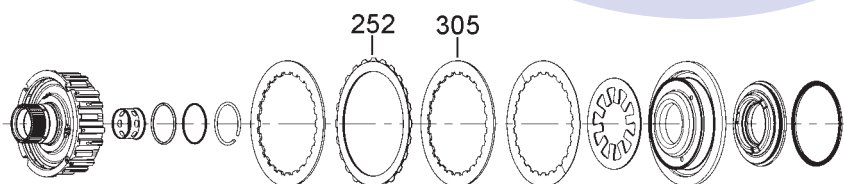

'E' Clutch

# 8 SPEED RWD (Full Electronic Control)



AUTOMATIC CHOICE



THE AUTOMATIC TRANSMISSION PARTS WAREHOUSE

G

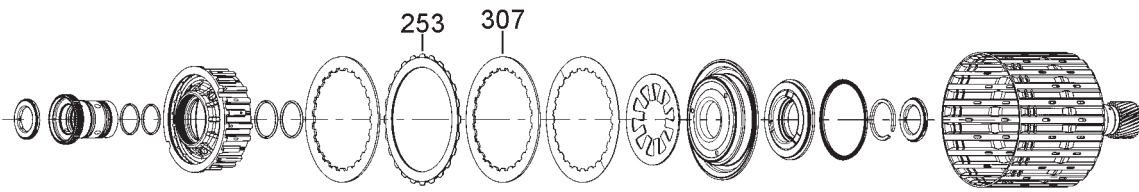

'C' Clutch

H

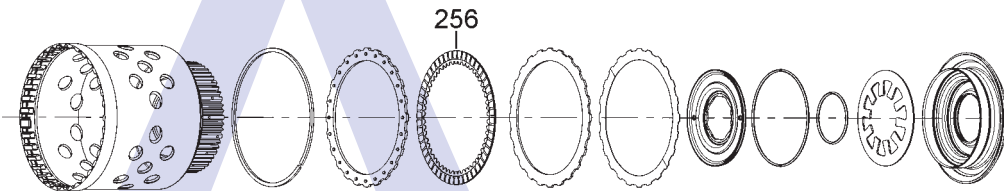

'D' Clutch

J

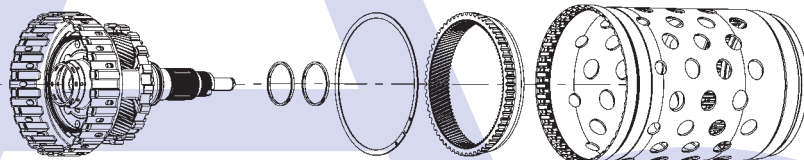

Planetary Gear Set No. 4

K

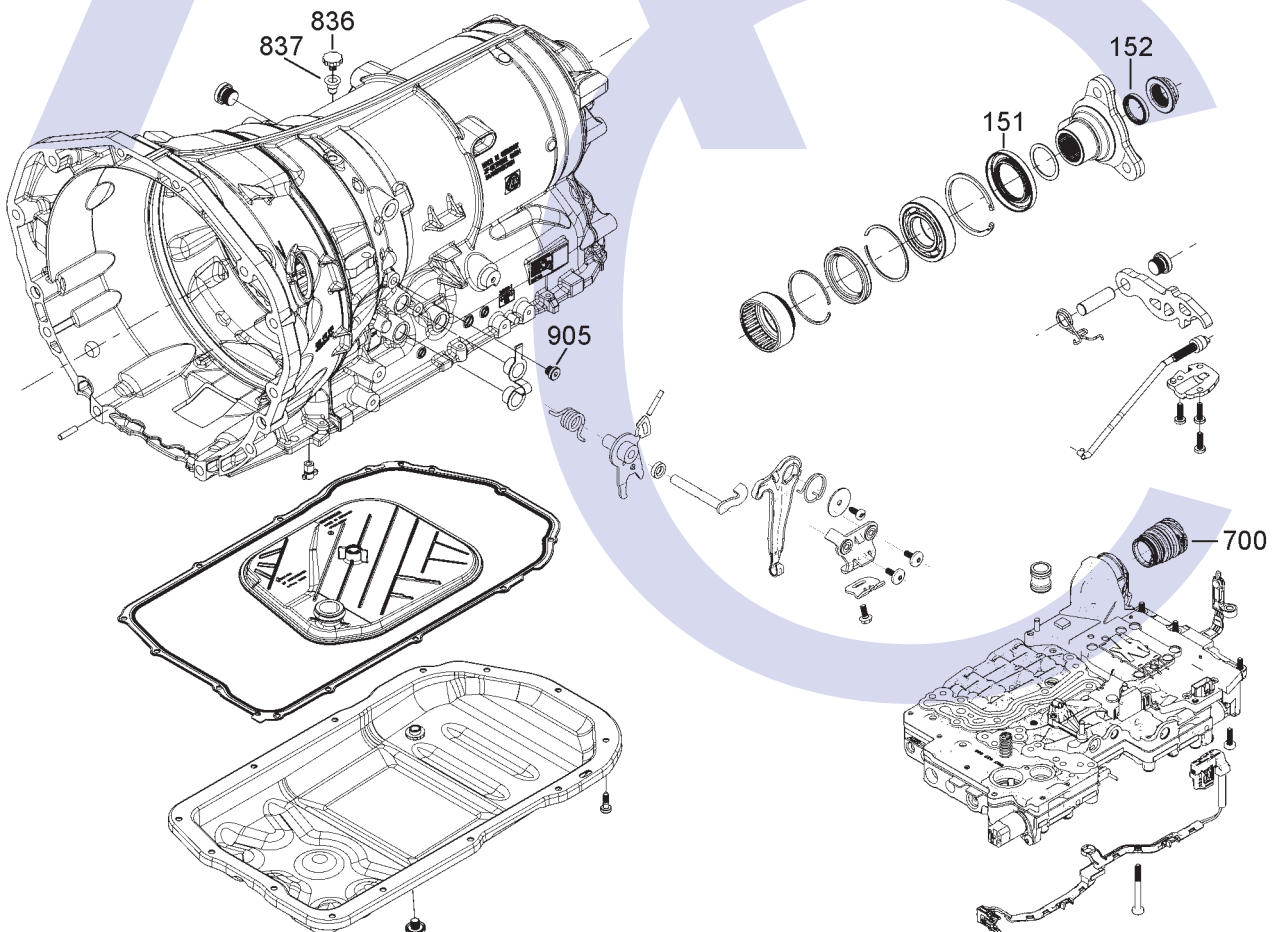

## 8 SPEED RWD (Full Electronic Control)



AUTOMATIC CHOICE

ILL NO.	DESCRIPTION	YEARS	QTY	PART NO
<b>KITS</b>				
<b>GASKETS</b>				
<b>RUBBER COMPONENTS</b>				
127D	'O' Ring, Input Shaft Lock Up.... All		1	8HP45.OR02
<b>METAL CLAD SEALS</b>				
150A	Converter to Centring Plate (OE) .....	All	1	8HP45.MCS01
150A	Converter to Centring Plate (Transtec®) .....	All	1	8HP45.MCS11
151K	Extension Housing (OE) .....	All	1	6HP26.MCS02
151K	Extension Housing (Transtec®) All		1	8HP45.MCS12
152K	Yoke Spline Seal (Transtec®) ... All		1	8HP45.MCS14
<b>MOULDED PISTONS</b>				
<b>SEALING RINGS</b>				
<b>FRICTION PLATES</b>				
250B	'A' Clutch .....	All	6	8HP70.FRP01
251C	'B' Clutch .....	All	5	8HP90.FRP02
252F	'E' Clutch (Outer Teeth) .....	All	7	8HP70.FRP03
253G	'C' Clutch (Outer Teeth) .....	All	7	8HP70.FRP03
256H	'D' Clutch .....	All	5	8HP70.FRP04
<b>STEEL PLATES</b>				
301B	'A' Clutch .....	All	6	8HP70.STP01
303C	'B' Clutch .....	All	5	8HP70.STP02
305F	'E' Clutch (Inner Teeth) .....	All	7	8HP70.STP03
307G	'C' Clutch (Inner Teeth) .....	All	7	8HP70.STP03
<b>PRESSURE PLATES</b>				
<b>SPRINGS &amp; CIRCLIPS</b>				
<b>FILTERS</b>				

ILL NO.	DESCRIPTION	YEARS	QTY	PART NO
<b>BUSHINGS</b>				
<b>THRUST WASHERS &amp; BEARINGS</b>				
<b>ELECTRICAL COMPONENTS</b>				
700K	Case Connector/Guide Sleeve . All		1	8HP45.ELE01
<b>VALVE BODY PARTS</b>				
<b>HARD PARTS</b>				
802A	Drive Chain, Oil Pump .....	All	1	8HP55.CH01
803A	Oil Pump .....	All	1	8HP45.PUM01
836K	Plastic Breather Cap .....	All	1	5HP19.CAP01
837K	Plastic Breather Tube .....	All	1	5HP19.BRE01
<b>SPECIAL ITEMS</b>				
901A	Bolt, Pump to Case (M8x70 Aluminium) .....	All	7	8HP45.NUT01
905K	Screw Plug, Casing (M10x1) .... All		1	4HP20.PLU01
NI	LifeGuardFluid8 Transmission Fluid (1 x 1 Ltr Bottle) .....	All	AR	OIL.67
	(1 x 10 Ltr Canister) .....	All	AR	OIL.77
	(1 x 20 Ltr Canister) .....	All	AR	OIL.68
	(1 x 209 Ltr Barrel) .....	All	AR	OIL.65
<b>TOOLS &amp; MANUALS</b>				



THE AUTOMATIC TRANSMISSION PARTS WAREHOUSE

**8HP90 1091 010 xxx**

## 8 SPEED RWD (Full Electronic Control)



## AUTOMATIC CHOICE



# THE AUTOMATIC TRANSMISSION PARTS WAREHOUSE

ILL NO.	DESCRIPTION	YEARS	QTY	PART NO
------------	-------------	-------	-----	---------