

ZF 5HP19 HLA (PORSCHE) Code: 1060 060 xxx

5 SPEED AWD (Full Electronic Control)



AUTOMATIC CHOICE



THE AUTOMATIC TRANSMISSION PARTS WAREHOUSE

A

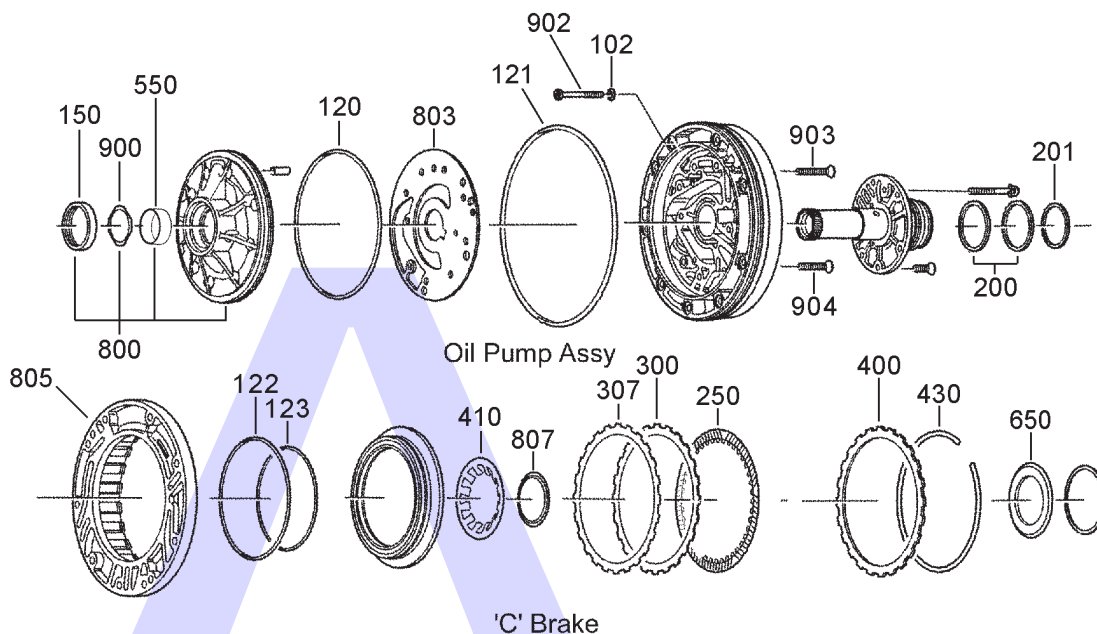

'C' Brake

B

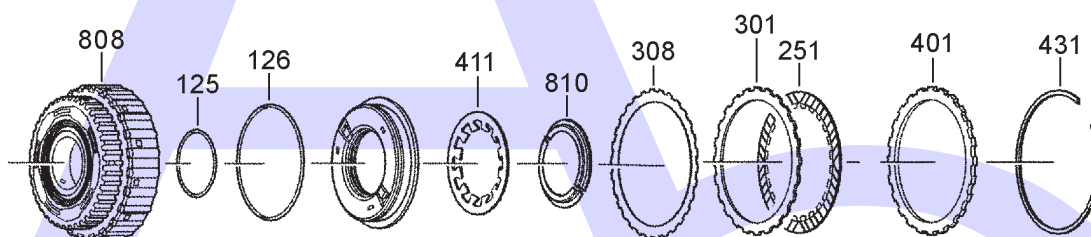

'B' Clutch Assy

C

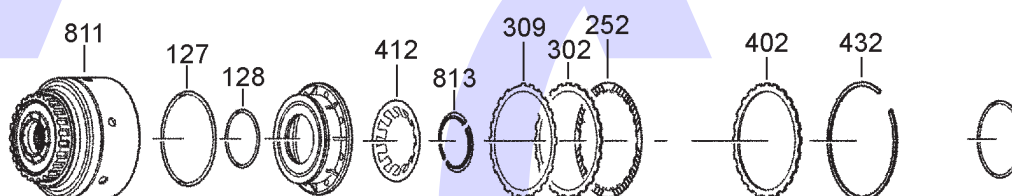

'A' Clutch Assy

D

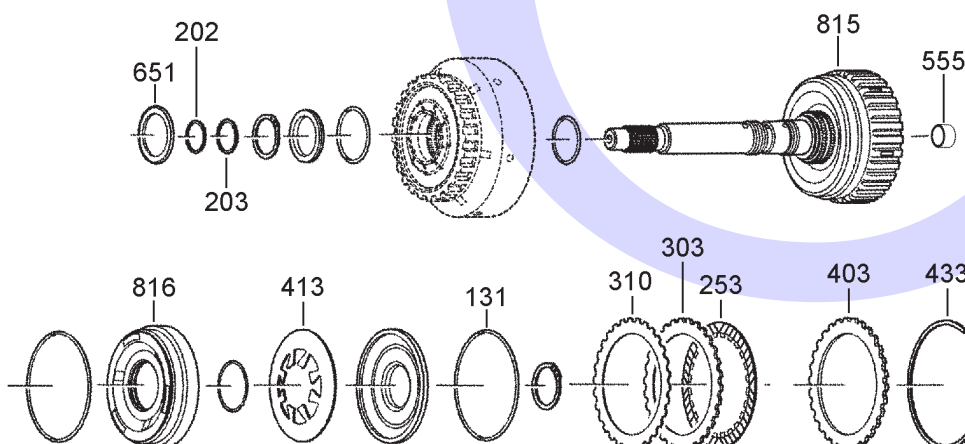

'E' Clutch Assy

ZF 5HP19 HLA (PORSCH) Code: 1060 060 xxx

5 SPEED AWD (Full Electronic Control)



AUTOMATIC CHOICE



THE AUTOMATIC TRANSMISSION PARTS WAREHOUSE

E

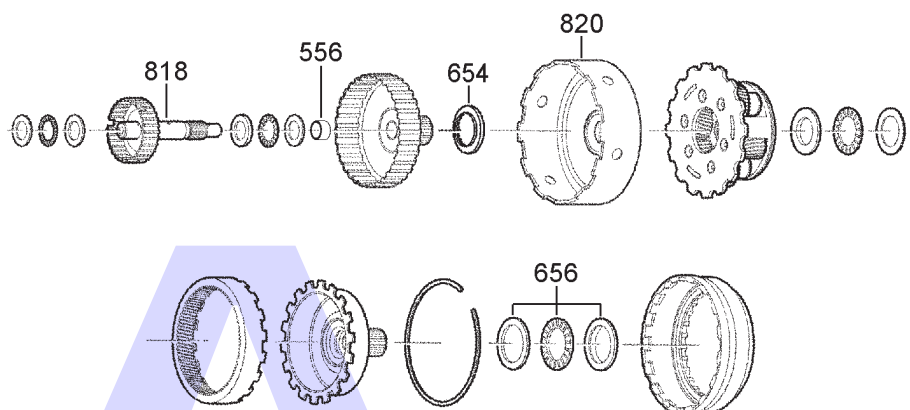

Front Planetary Assy

F

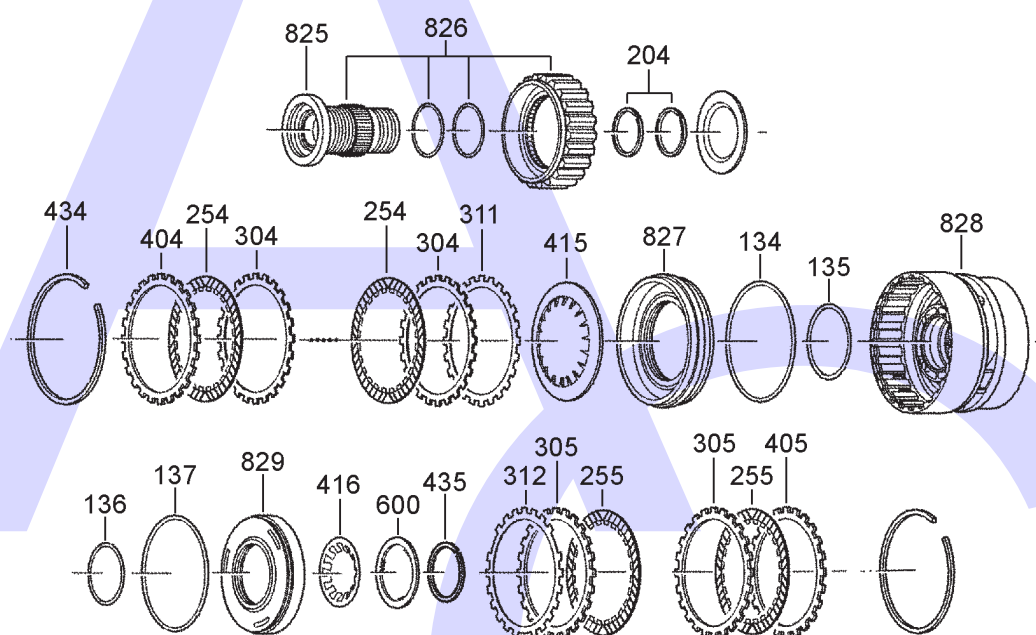

'D' & 'G' Brake Assy

G

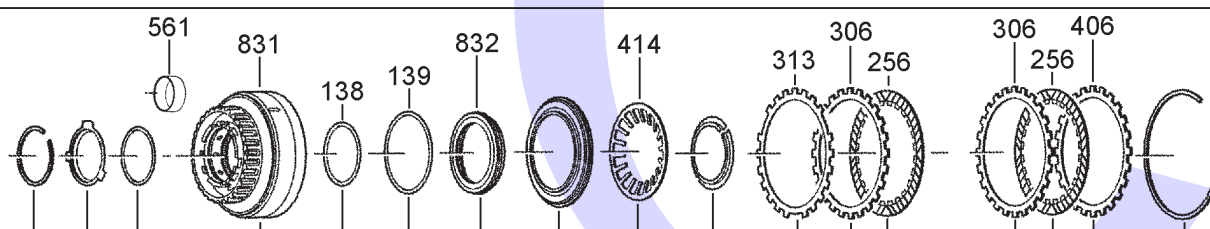

'F' Brake Assy

H

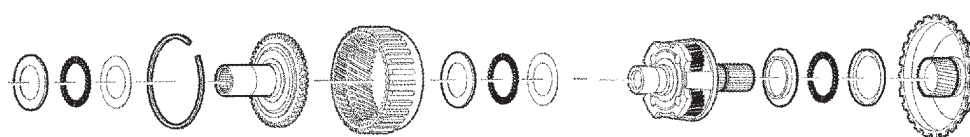

Rear Planetary Assy

ZF 5HP19 HLA (PORSCHE) Code: 1060 060 xxx

5 SPEED AWD (Full Electronic Control)



AUTOMATIC CHOICE



THE AUTOMATIC TRANSMISSION PARTS WAREHOUSE

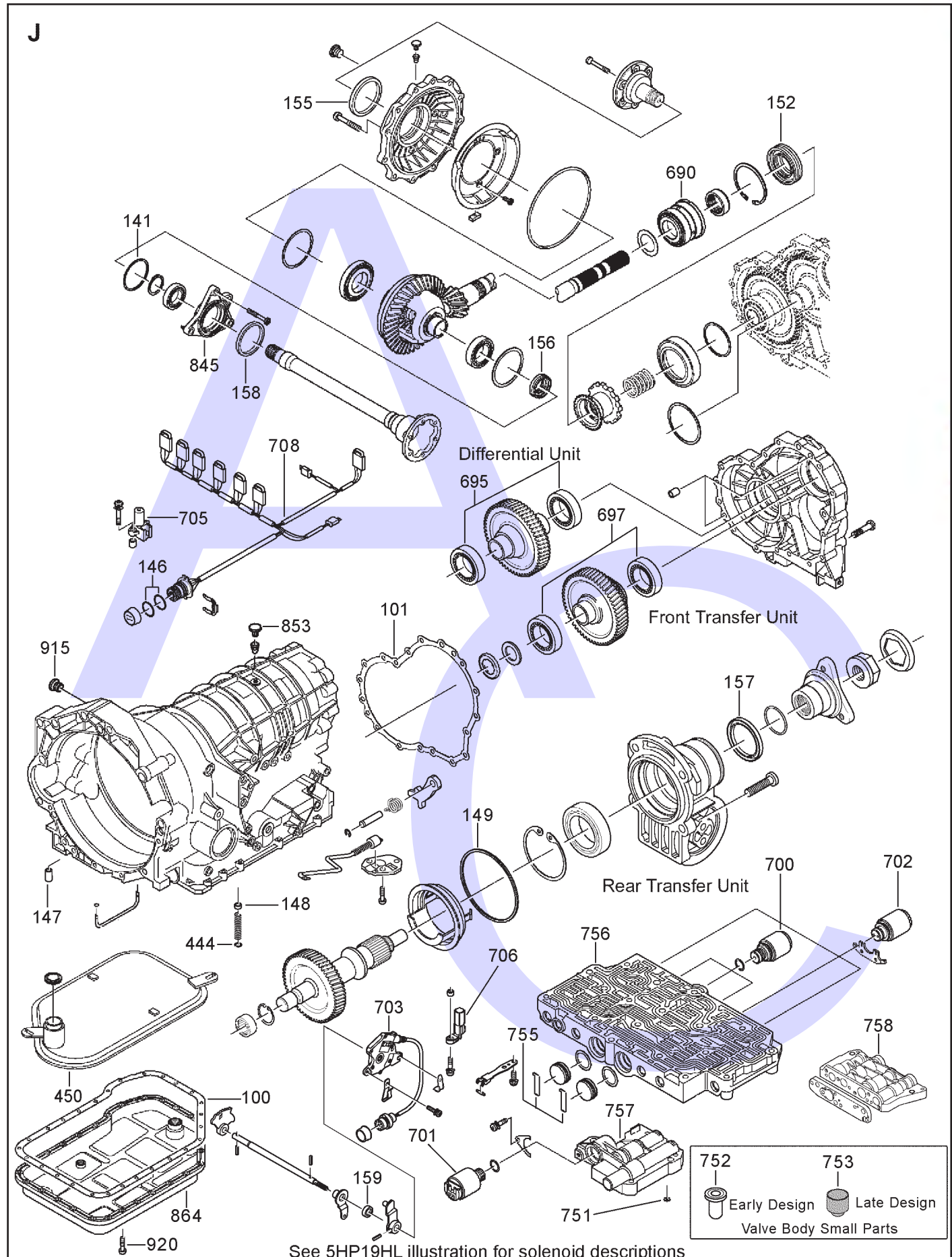

ZF 5HP19 HLA (PORSCHE) Code: 1060 060 xxx

5 SPEED AWD (Full Electronic Control)



AUTOMATIC CHOICE



THE AUTOMATIC TRANSMISSION PARTS WAREHOUSE

ILL NO.	DESCRIPTION	YEARS	QTY	PART NO
KITS				
Kit	Overhaul Kit (OEM)..... All		1	5HP19.OHK04
Kit	Supplement Kit (Precision) (For Use With Standard Audi Kit) All		1	5HP19.OHK53
GASKETS				
100J	Pan Gasket (OEM)..... All		1	5HP19.GAS03
100J	Pan Gasket (AM) All		1	5HP19.GAS53
101J	Transfer Case to Main Case All		1	5HP19.GAS07
102A	Pump Bolt Sealing Washer All		9	5HP18.GAS04
NI	Valve Body Gasket..... All		1	5HP19.GAS05
RUBBER COMPONENTS				
120A	Pump to Stator 'O' Ring All		1	5HP19.OR01
121A	Stator to Case 'O' Ring All		1	5HP19.OR03
122A	'O' Ring, 'C' Brake Outer All		1	5HP19.OR11
123A	'O' Ring, 'C' Brake Inner All		1	5HP18.OR05
125B	'O' Ring, 'B' Clutch Inner All		1	5HP19.OR08
126B	'O' Ring, 'B' Clutch Outer All		1	6HP26.OR04
127C	'O' Ring, 'A' Clutch Outer All		1	5HP19.OR17
128C	'O' Ring, 'A' Clutch Inner All		1	5HP19.OR16
131D	'O' Ring, 'E' Clutch Damper..... All		1	5HP19.OR09
134F	'O' Ring, 'D' Clutch Outer All		1	5HP19.OR11
135F	'O' Ring, 'D' Clutch Inner All		1	5HP19.OR12
136F	'O' Ring, 'G' Brake Inner..... All		1	5HP19.OR08
137F	'O' Ring, 'G' Brake Outer..... All		1	5HP19.OR07
138G	'O' Ring, 'F' Brake Inner All		1	5HP19.OR09
139G	'O' Ring, 'F' Clutch Outer..... All		1	5HP19.OR08
141J	'O' Ring, Speedo Drive Housing to Case All		1	5HP19.OR10
146J	Case Connector 'O' Ring All		2	5HP18.OR03
147J	V. Body to Case Sealing Rubber (Long)..... All		5	5HP19.RUB01
148J	V. Body to Case Sealing Rubber (Short)..... All		3	5HP19.RUB02
149J	'O' Ring, Rear Transfer Unit..... All		1	5HP19.OR14
METAL CLAD SEALS				
150A	Converter Seal All		1	4HP18.MCS01
152J	Transfer Shaft Seal (OEM) (37.50mm x 88mm x 16mm)..... All		1	5HP19.MCS04
152J	Transfer Shaft Seal (AM) (37.50mm x 88mm x 16mm)..... All		1	5HP19.MCS54
155J	Left Hand Outer D. Shaft Seal (60mm x 80mm x 7.50mm)..... All		1	5HP19.MCS07
156J	Output Seal, Inner (OE) (34mm x 46/48mm x 12/16mm) All		1	5HP19.MCS11
156J	Output Seal, Inner (AM) (34mm x 46/48mm x 12/16mm) All		1	5HP19.MCS61
157J	Flange Seal, Rear Transfer..... All		1	5HP19.MCS12
158J	Left Hand Outer D. Shaft Seal (55mm x 42mm x 8mm)..... All		1	5HP19.MCS15
159J	Selector Shaft Seal (12mm x 22mm x 5mm)..... All		1	4HP20.MCS08
MOULDED PISTONS				
SEALING RINGS				
200A	Stator Support (Large) All		2	5HP19.SSR01
201A	Stator Support (Small) All		1	5HP19.SSR02
202D	Input Shaft Front (Small)..... All		1	5HP19.SSR03
203D	Input Shaft Rear (Large) All		1	5HP18.SSR04
204F	'D/'G' Carrier..... All		2	5HP18.SSR06

ILL NO.	DESCRIPTION	YEARS	QTY	PART NO
FRICTION PLATES				
Kit	Friction Kit All		1	5HP19.FRK02
Kit	Friction Kit (Alto) All		1	5HP19.FRK51
250A	'C' Brake..... All		5	5HP19.FRP02
250A	'C' Brake (Alto)..... All		5	5HP19.FRP53
251B	'B' Clutch All		2	5HP19.FRP01
251B	'B' Clutch (Alto) All		2	5HP19.FRP52
252C	'A' Clutch All		5	4HP18.FRP03
252C	'A' Clutch (Alto) All		5	5HP19.FRP51
253D	'E' Clutch All		5	5HP19.FRP04
253D	'E' Clutch (Alto) All		5	5HP19.FRP54
254F	'D' Brake..... All		5	4HP18.FRP02
254F	'D' Brake (Alto)..... All		5	5HP19.FRP51
255F	'G' Brake All		4	5HP18.FRP03
255F	'G' Brake (Alto)..... All		4	5HP19.FRP55
256G	'F' Clutch All		5	5HP18.FRP03
256G	'F' Clutch (Alto)..... All		5	5HP19.FRP55
STEEL PLATES				
Kit	Steel Plate Kit All		1	5HP19.STK02
Kit	Steel Plate Kit (Alto)..... All		1	5HP19.STK51
300A	'C' Brake..... All		5	4HP20.STP05
301B	'B' Clutch All		2	5HP19.STP04
302C	'A' Clutch All		5	5HP19.STP02
303D	'E' Clutch All		5	5HP19.STP05
304F	'D' Brake..... All		6	5HP19.STP02
305F	'G' Brake All		4	5HP19.STP07
306G	'F' Clutch All		5	5HP19.STP03
307A	'C' Brake Waved Steel All		1	5HP19.STP10
308B	'B' Clutch Waved Steel..... All		1	5HP19.STP11
309C	'A' Clutch Waved Steel..... All		1	5HP18.STP04
310D	'E' Clutch Waved Steel..... All		1	5HP19.STP13
311F	'D' Brake Waved Steel All		1	5HP19.STP18
312F	'G' Brake Waved Steel All		1	5HP19.STP17
313G	'F' Clutch Waved Steel All		1	5HP19.STP17
PRESSURE PLATES				
400A	Pressure Plate 'C' Brake (4.00mm)..... All		1	5HP19.PP01
401B	Pressure Plate 'B' Clutch All		1	5HP19.PP02
402C	Pressure Plate 'A' Clutch All		1	5HP19.PP03
403D	Pressure Plate 'E' Clutch All		1	5HP19.PP04
404F	Pressure Plate 'D' Brake..... All		1	5HP19.PP03
405F	Pressure Plate 'G' Brake..... All		1	5HP19.PP06
406G	Pressure Plate 'F' Brake All		1	5HP19.STP03
SPRINGS & CIRCLIPS				
410A	Diaphragm Spring 'C' Brake..... All		1	5HP19.DIA01
411B	Diaphragm Spring 'B' Clutch All		1	5HP19.DIA02
412C	Diaphragm Spring 'A' Clutch All		1	5HP19.DIA03
413D	Diaphragm Spring 'E' Clutch All		1	5HP19.DIA04
414G	Diaphragm Spring 'F' Clutch All		1	5HP19.DIA05
415F	Diaphragm Spring 'D' Brake..... All		1	5HP19.DIA06
416F	Diaphragm Spring 'G' Brake All		1	5HP19.DIA07
430A	Circlip - 'C' Brake Retaining (2.80mm)		AR	5HP19.CIR01
430A	Circlip - 'C' Brake Retaining (2.60mm)		AR	5HP19.CIR02
430A	Circlip - 'C' Brake Retaining (2.40mm)		AR	5HP19.CIR03
430A	Circlip - 'C' Brake Retaining (2.20mm)		AR	5HP19.CIR04
430A	Circlip - 'C' Brake Retaining (2.00mm)		AR	5HP19.CIR05
430A	Circlip - 'C' Brake Retaining (1.80mm)		AR	5HP19.CIR06
430A	Circlip - 'C' Brake Retaining (1.60mm)		AR	5HP19.CIR07

ZF 5HP19 HLA (PORSCHE) Code: 1060 060 xxx

5 SPEED AWD (Full Electronic Control)



AUTOMATIC CHOICE



THE AUTOMATIC TRANSMISSION PARTS WAREHOUSE

ILL NO.	DESCRIPTION	YEARS	QTY	PART NO
SPRINGS & CIRCLIPS Cont...				
430A	Circlip - 'C' Brake Retaining (1.40mm)	AR	5HP19.CIR08	
431B	Circlip - 'B' Clutch Retaining (2.00mm)	AR	5HP19.CIR09	
431B	Circlip - 'B' Clutch Retaining (1.80mm)	AR	5HP19.CIR10	
431B	Circlip - 'B' Clutch Retaining (1.60mm)	AR	5HP19.CIR11	
431B	Circlip - 'B' Clutch Retaining (1.40mm)	AR	5HP19.CIR12	
431B	Circlip - 'B' Clutch Retaining (1.20mm)	AR	5HP19.CIR13	
431B	Circlip - 'B' Clutch Retaining (1.00mm)	AR	5HP19.CIR14	
432C	Circlip - 'A' Clutch Retaining (2.80mm)	AR	5HP19.CIR15	
432C	Circlip - 'A' Clutch Retaining (2.60mm)	AR	5HP19.CIR16	
432C	Circlip - 'A' Clutch Retaining (2.40mm)	AR	5HP19.CIR17	
432C	Circlip - 'A' Clutch Retaining (2.20mm)	AR	5HP19.CIR18	
432C	Circlip - 'A' Clutch Retaining (2.00mm)	AR	5HP19.CIR19	
432C	Circlip - 'A' Clutch Retaining (1.80mm)	AR	5HP19.CIR20	
432C	Circlip - 'A' Clutch Retaining (1.60mm)	AR	5HP19.CIR21	
432C	Circlip - 'A' Clutch Retaining (1.40mm)	AR	5HP19.CIR22	
432C	Circlip - 'A' Clutch Retaining (1.20mm)	AR	5HP19.CIR23	
432C	Circlip - 'A' Clutch Retaining (1.00mm)	AR	5HP19.CIR24	
433D	Circlip - 'E' Clutch Retaining (2.80mm)	AR	5HP19.CIR25	
433D	Circlip - 'E' Clutch Retaining (2.60mm)	AR	5HP19.CIR26	
433D	Circlip - 'E' Clutch Retaining (2.40mm)	AR	5HP19.CIR27	
433D	Circlip - 'E' Clutch Retaining (2.20mm)	AR	5HP19.CIR28	
433D	Circlip - 'E' Clutch Retaining (2.00mm)	AR	5HP19.CIR29	
433D	Circlip - 'E' Clutch Retaining (1.80mm)	AR	5HP19.CIR30	
433D	Circlip - 'E' Clutch Retaining (1.60mm)	AR	5HP19.CIR31	
433D	Circlip - 'E' Clutch Retaining (1.50mm)	AR	5HP19.CIR32	
433D	Circlip - 'E' Clutch Retaining (1.40mm)	AR	5HP19.CIR33	
433D	Circlip - 'E' Clutch Retaining (1.20mm)	AR	5HP19.CIR34	
433D	Circlip - 'E' Clutch Retaining (1.00mm)	AR	5HP19.CIR35	
434F	Circlip - 'D' Brake Retaining (4.20mm)	AR	5HP19.CIR36	
434F	Circlip - 'D' Brake Retaining (4.00mm)	AR	5HP19.CIR37	
435F	'G' Brake Thrust Ret Circlip..... All	1	5HP18.CIR02	
444J	V.B. to Case			
	Rubber Seal Retaining Clip..... All	3	5HP19.CIR38	
FILTERS				
450J	Filter, Oil Pick Up All	1	5HP19.FIL05	
NI	Valve Body Oil Screen All	1	5HP19.FIL04	
BUSHINGS				
Kit	Bushing Kit..... All	1	5HP19.BK01	
550A	Pump Body Bush (Standard Size) All	1	5HP19.BUS11	
550A	Pump Body Bush (Oversize OD) (Pump requires machining)			
	(Sonnax® Click here for Info) ... All	1	5HP19.BUS01	
550A	Pump Body Bush (Oversize OD & Undersize ID) (Pump requires machining & Bush requires machining after fitting to fit converter neck)			
	(Sonnax® Click here for Info) ... All	1	5HP19.BUS02	
555D	Bushing, 'E' Clutch Rear (15mm OD x 12mm ID x 10.20mm)			
 All	1	5HP19.BUS03	
556E	Bushing, Sun Gear Shaft (15mm OD x 12mm ID x 10.20mm)			
 All	1	5HP19.BUS03	
561G	'F' Clutch Drum (Bronze)..... All	1	5HP18.BUS05	
561G	'F' Clutch Drum (Sonnax)..... All	1	5HP18.BUS07	

ILL NO.	DESCRIPTION	YEARS	QTY	PART NO
THRUST WASHERS & BEARINGS				
600F	'G' Brake Thrust Plate..... All	1	5HP18.THW01	
650A	Bearing Radial, Rear of Stator Support..... All	1	5HP19.TOR02	
651D	Bearing Radial, 'A' to 'B' Clutch. All	1	5HP19.TOR03	
654E	Bearing Radial, Sun Gear Shaft to Sun Gear Shell..... All	1	5HP19.BE04	
656E	Bearing Kit, Shaft to Carrier All	1	5HP18.TK05	
690J	Pinion Bearing Assy..... All	1	5HP19.BE05	
695J	Bearing, Helical Gear (Front Transfer Unit) (Front & Rear) All	2	4HP20.BE02	
697J	Bearing, Pinnion Gear (Front Transfer Unit) (Front & Rear) All	2	4HP20.BE02	
ELECTRICAL COMPONENTS				
700J	Solenoid (PWM)..... All	3	4HP20.SOL02	
701J	Solenoid Main Pressure Reg All	1	5HP19.SOL04	
702J	Solenoid Shift (On Off)..... All	3	5HP30.SOL02	
703J	Range Sensor..... All	1	5HP19.ELE10	
705J	Turbine Speed Sensor (Inductive) (Fits on Valve Body)..... All	1	5HP18.ELE01	
706J	Output Speed Sensor (Inductive) (Fits on Casing)..... All	1	4HP20.ELE01	
708J	Valve Body Loom All	1	5HP19.ELE12	
VALVE BODY PARTS				
751J	Orifice Disc/Valve (Pressure Reg Body) All	1	5HP19.VA07	
752J	Damper Plug (Rubber) (Early Design) All	3	5HP19.ACC01	
753J	Damper Plug (Aluminium) (Late Design) All	3	5HP19.ACC02	
755J	Retainer Valve Body End Plug.. All	2	5HP19.RET03	
756J	Lower Rear Valve Body Housing All	1	5HP19.VB02	
757J	Pressure Regulator Housing All	1	5HP19.VB12	
758J	Valve Body Housing, Upper Front All	1	5HP19.VB13	
NI	Pressure Regulator Spring..... All	1	5HP19.SPR04	
Kit	Pressure Regulator Valve (Early E17 Valve Body) (Requires Toolkit 5HP19.VA03)			
	(Sonnax® Click Here for Info)... All	1	5HP19.VA06	
Kit	Toolkit for 5HP19.VA06 (Sonnax®)..... All	1	5HP19.VA03	
Kit	Pressure Regulator Valve (Late E18.2 Valve Body) (Requires Toolkit 5HP19.VA05)			
	(Sonnax® Click Here for Info)... All	1	5HP19.VA04	
Kit	Toolkit for 5HP19.VA04 (Sonnax®)..... All	1	5HP19.VA05	
Kit	Replacement Reamer for Toolkit 5HP19.VA05 (Sonnax®)..... All	1	5HP19.VA18	
NI	Valve Body Oil Screen All	1	5HP19.FIL04	
NI	Encapsulated Plastic Ball Valve (Fit in Rear of Front Lower Valve Body)			
 All	1	4HP22.VA01	
NI	'F' Accumulator Spring All	1	4HP14.SPR23	
NI	Housing, Valve Body Lower Front All	1	5HP19.VA02	
NI	Orifice Disc/Valve 9In Vave Body) (1.00mm)..... All	AR	4HP18.VA03	
NI	Accumulator Piston (Small Fits in Duct Plate) All	3	5HP24.VA06	
Kit	Pressure Regulator Valve (Type 2 Valve Body) (TransGo® Click Here for Info) . All	1	5HP19.VA19	

ZF 5HP19 HLA (PORSCHE) Code: 1060 060 xxx

5 SPEED AWD (Full Electronic Control)



AUTOMATIC CHOICE



THE AUTOMATIC TRANSMISSION PARTS WAREHOUSE

ILL NO.	DESCRIPTION	YEARS	QTY	PART NO
HARDWARE				
800A	Short Pump Assy	All	1	5HP19.PUM01
803A	Pump Wear Plate.....	All	1	5HP19.SP01
805A	'C' Brake Cylinder (5 Lined Plates).....	All	1	5HP19.DRU10
807A	Retainer, 'C' Brake Diaphragm..	All	1	5HP19.RET04
808B	'B' Clutch Cylinder.....	All	1	5HP19.DRU11
810B	Retainer, 'B' Clutch Diaphragm.	All	1	5HP19.RET04
811C	'A' Clutch Cylinder (5Plate)	All	1	5HP19.DRU03
813C	Retainer 'A' Clutch	All	1	5HP19.RET01
815D	'E' Clutch Cylinder.....	All	1	5HP19.DRU13
816D	Piston, 'E' Clutch	All	1	5HP19.PIS04
818E	Intermediate Shaft.....	All	1	5HP18.SH02
820E	Drive Shell/Sun Gear	All	1	5HP19.POT02
825F	Carrier & OWC Inner.....	All	1	5HP19.OWC02
826F	O.W.C. Assy 'D'/'G' Carrier.....	All	1	5HP19.OWC01
827F	Piston 'D' Brake (aluminium).....	All	1	5HP18.PIS03
829F	Piston 'G' Brake (aluminium)....	All	1	5HP19.PIS02
831G	'F' Clutch Cylinder (Modified * see next page).....	All	1	5HP19.DRU04
832G	Piston 'F' Clutch	All	1	5HP19.PIS01
835G	'F' Clutch Assembly (Complete) All		1	5HP19.DRU09
845J	Housing, L/H Axle Seal	All	1	5HP19.COV02
853J	Plastic Breather Cap	All	1	5HP19.CAP01
864J	Oil Pan	All	1	5HP19.PAN01
<p>* Modified Items May Require Replacement of Extra Components To Make Them Compatible With Existing Transmissions, Please Furnish Transmission Code and Ask Us To Check Compatibility</p>				
SPECIAL ITEMS				
900A	Washer - Oil Dam (Fits Behind T.C. Seal)	All	1	5HP19.THW01
902A	Bolt, Stator (M6 x 65mm).....	All	9	5HP19.NUT08
903A	Bolt, Pump to Stator (48mm)	All	1	5HP19.NUT04
904A	Bolt, Pump to Stator (40mm)	All	8	5HP19.NUT03
915J	Screw Plug, (M10x1).....	All	1	4HP20.PLU01
920J	Bolt, Oil Pan to Case.....	All	27	5HP19.NUT05
NI	Repair Manual (OEM)	All		5HP19.MAN02
NI	Factory Repair Manual (ATSG). All			5HP19.MAN04
NI	LifeGuardFluid5 x 1Ltr Bottle (Esso LT71141)	All	AR	OIL.50
NI	LifeGuardFluid5 x 20Ltr Canister (Esso LT71141)	All	AR	OIL.51
NI	LifeGuardFluid5 x 209Ltr Drum (Esso LT71141)	All	AR	OIL.52