

ZF 4HP18FLE (AUDI/PORSCHE) Code: 1050 012 xxx

4 SPEED 2WD (Electronic Control)



AUTOMATIC CHOICE



THE AUTOMATIC TRANSMISSION PARTS WAREHOUSE

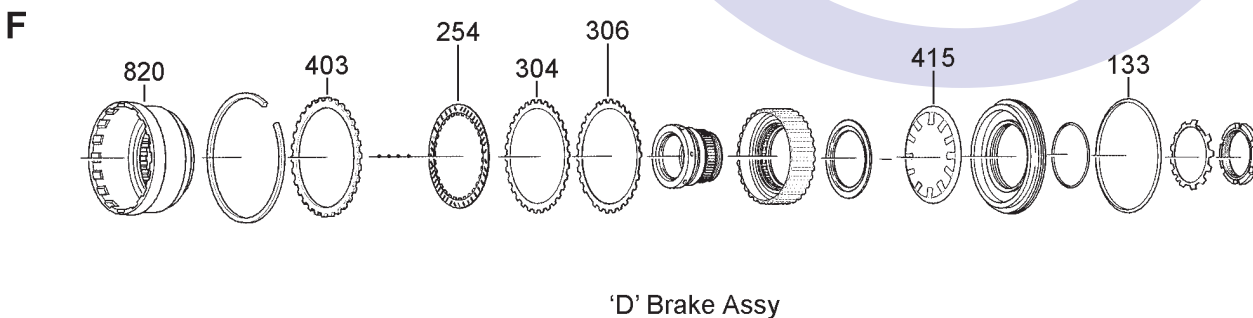
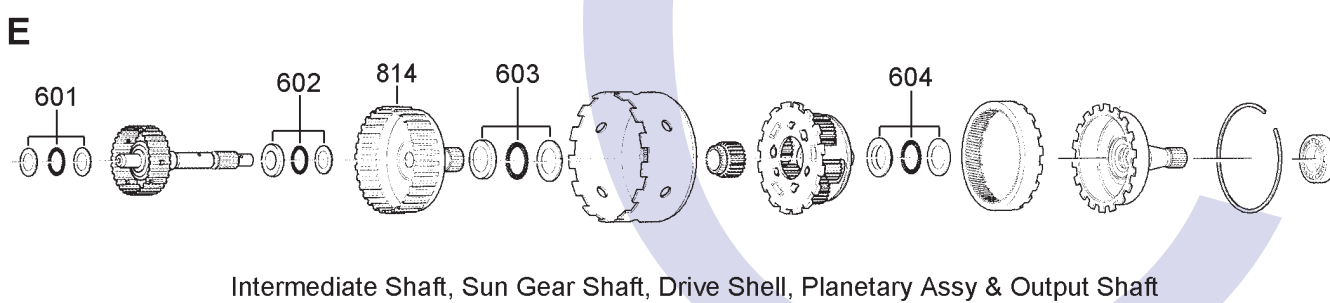
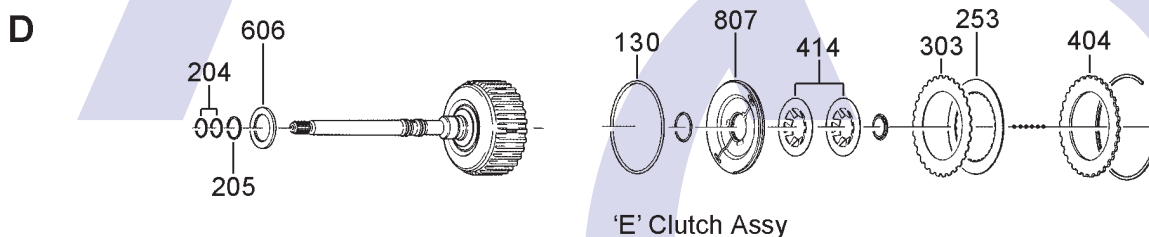
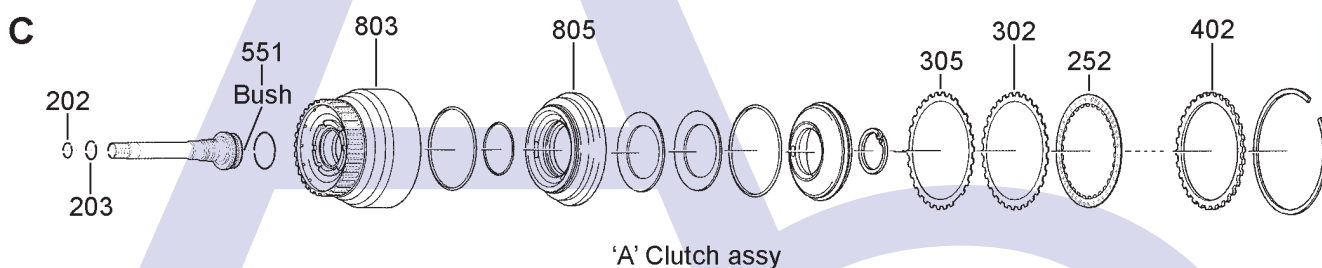
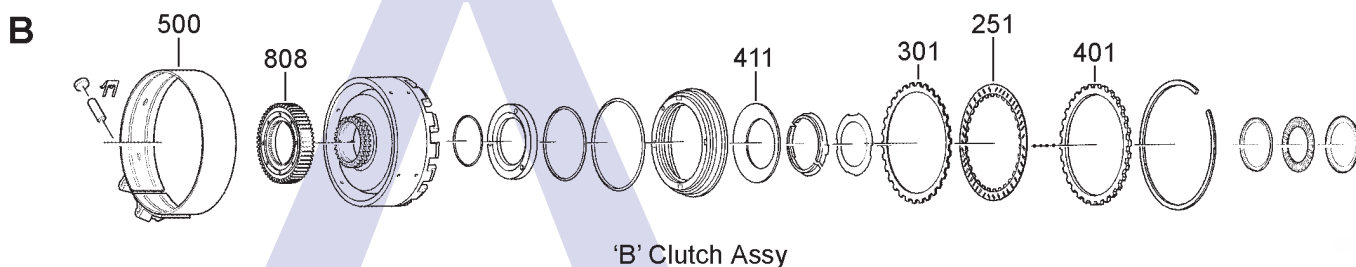
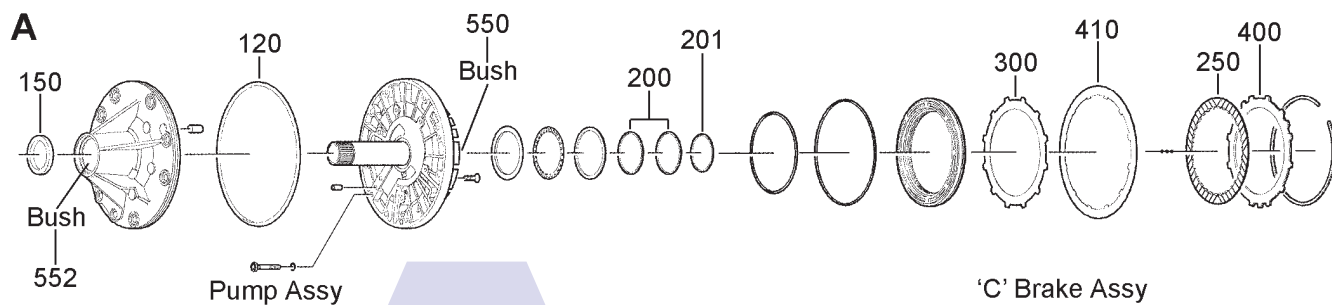

ZF 4HP18FLE (AUDI/PORSCHE) Code: 1050 012 xxx

4 SPEED 2WD (Electronic Control)



AUTOMATIC CHOICE



THE AUTOMATIC TRANSMISSION PARTS WAREHOUSE

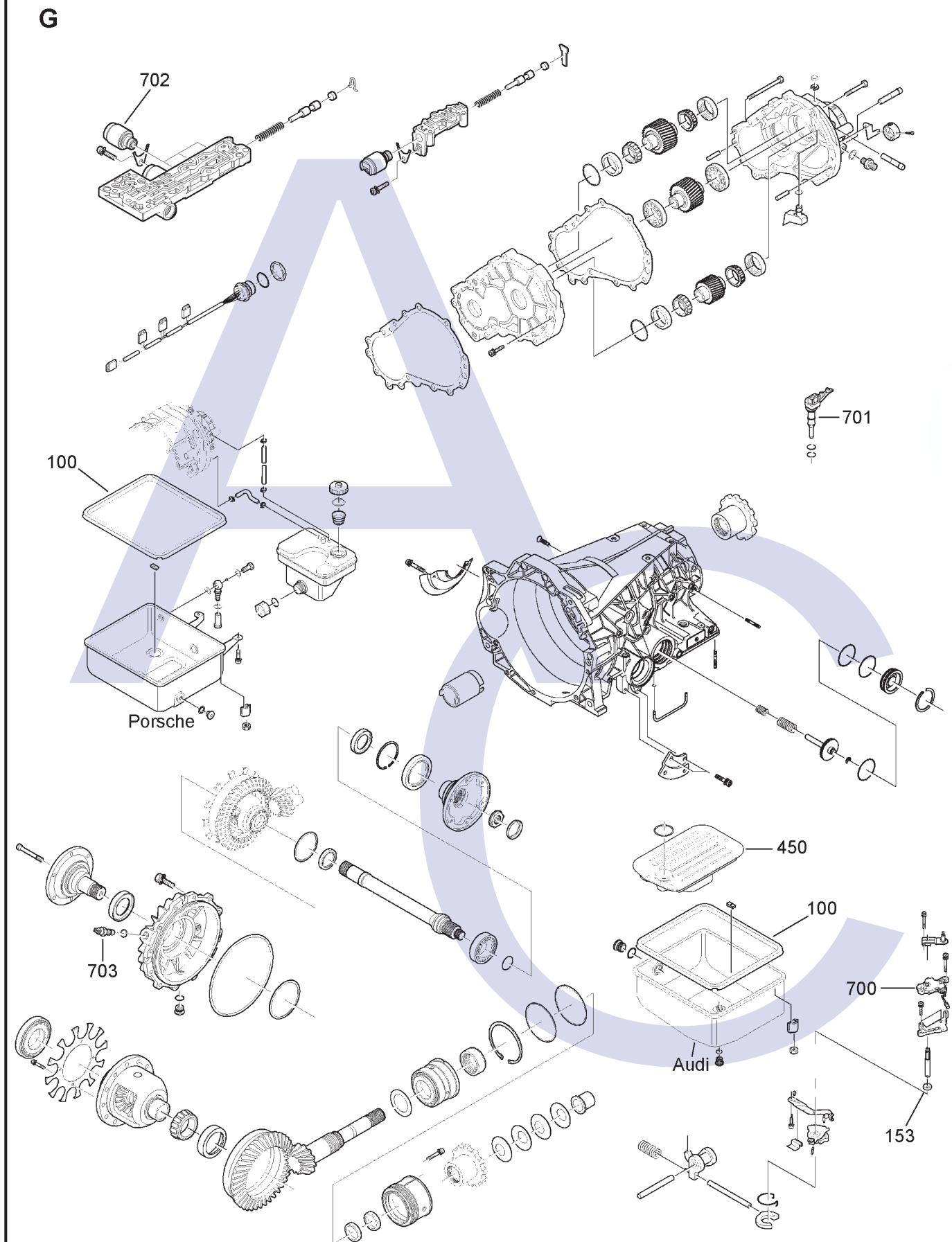

ZF 4HP18FLE (AUDI/PORSCHE) Code: 1050 012 xxx

4 SPEED 2WD (Electronic Control)



AUTOMATIC CHOICE



THE AUTOMATIC TRANSMISSION PARTS WAREHOUSE

ILL NO.	DESCRIPTION	YEARS	QTY	PART NO
KITS				
Kit	Overhaul Kit (Audi OEM)	92-ON	1	4HP18.OHK05
Kit	Overhaul Kit (Porsche OEM)	92-ON	1	4HP18.OHK08
Kit	Overhaul Kit (Precision) (Transmission Only)	91-ON	1	4HP18.OHK53
GASKETS				
100G	Pan Gasket (OEM).....	92-ON	1	4HP18.GAS05
100G	Pan Gasket (AM)	92-ON	1	4HP18.GAS55
Ni	Valve Body Gasket.....	92-ON	1	4HP18.GAS08
RUBBER COMPONENTS				
120A	Pump Outer 'O' Ring.....	92-ON	1	5HP18.OR02
130D	'O' Ring, 'E' Clutch Outer	92-ON	1	6HP19.OR01
133F	'O' Ring, 'D' Clutch Outer	92-ON	1	5HP19.OR11
METAL CLAD SEALS				
150A	Converter Seal	92-ON	1	4HP18.MCS01
153G	Selector Shaft	92-ON	1	CTX.MCS13
SEALING RINGS				
Kit	Sealing Ring Kit (OEM).....	92-ON	1	4HP18.SRK01
Kit	Sealing Ring Kit (Bryco).....	92-ON	1	4HP18.SRK02
200A	Stator Support (Front).....	92-ON	2	4HP18.SSR06
201A	Stator Support (Rear).....	92-ON	1	4HP14.SSR03
202C	Turbine Shaft Front (Small).....	92-ON	1	4HP18.SSR04
203C	Turbine Shaft Rear (Large)	92-ON	1	4HP18.SSR07
204D	Motor Shaft Front (Plastic).....	92-ON	2	4HP18.SSR02
205D	Motor Shaft Rear (Large)	92-ON	1	4HP18.SSR08
FRICTION PLATES				
Kit	Friction Kit	92-ON	1	4HP18.FRK01
Kit	Friction Kit (Alto)	92-ON	1	4HP18.FRK52
Kit	Friction Kit (Borg Warner)	87-ON	1	4HP18.FRK02
250A	'C' Brake (Borg Warner)	92-ON	4	3HP22.FRP23
251B	'B' Clutch (OEM)	92-ON	3	4HP18.FRP05
251B	'B' Clutch (Pattern)	92-ON	3	4HP18.FRP15
252C	'A' Clutch (OEM)	92-ON	5	4HP18.FRP03
252C	'A' Clutch (Pattern)	92-ON	5	4HP18.FRP12
253D	'E' Clutch (OEM)	92-ON	5	4HP18.FRP04
253D	'E' Clutch (Pattern)	92-ON	5	4HP18.FRP14
253D	'E' Clutch (Alto)	92-ON	5	4HP18.FRP54
254F	'D' Brake (OEM).....	92-ON	6	4HP18.FRP02
254F	'D' Clutch (Pattern)	92-ON	6	4HP18.FRP12
STEEL PLATES				
Kit	Steel Plate Kit	92-ON	1	4HP18.STK01
Kit	Steel Plate Kit (Alto).....	92-ON	1	4HP18.STK52
300A	'C' Brake.....	92-ON	4	3HP22.STP03
301B	'B' Clutch	92-ON	3	4HP18.STP01
302C	'A' Clutch	92-ON	5	4HP18.STP01
303D	'E' Clutch	92-ON	5	4HP18.STP02
304F	'D' Brake.....	92-ON	6	4HP18.STP01
305C	'A' Clutch Waved Plate.....	92-ON	1	4HP18.STP03
306F	'D' Clutch Waved Plate	92-ON	1	5HP19.STP15

ILL NO.	DESCRIPTION	YEARS	QTY	PART NO
PRESSURE PLATES				
400A	'C' Brake Pressure Plate	92-ON	1	4HP18.PP01
401B	'B' Clutch Pressure Plate	92-ON	1	4HP18.PP02
402C	'A' Clutch Pressure Plate	92-ON	1	4HP18.PP02
403F	'D' Clutch Pressure Plate	92-ON	1	4HP18.PP02
404D	'E' Clutch Pressure Plate (Alto). 87-ON	87-ON	1	4HP18.PP03
SPRINGS & CIRCLIPS				
410A	'C' Brake Diaphragm Spring.....	92-ON	1	4HP18.DIA01
411B	'B' Clutch Diaphragm Spring.....	92-ON	1	4HP18.DIA02
414D	'E' Clutch Diaphragm Spring.....	92-ON	2	4HP18.DIA04
415F	'D' Brake Diaphragm Spring.....	92-ON	1	4HP18.DIA05
FILTERS				
450G	Filter	92-ON	1	4HP18.FIL02
BANDS				
500B	Band (OEM)	92-ON	1	4HP18.BAN02
BUSHES				
550A	Stator Support (Rear).....	92-ON	1	4HP18.BUS01
551C	Turbine Shaft (Bronze).....	92-ON	1	4HP14.BUS12
552A	Pump Body Bush	92-ON	1	4HP18.BUS04
ELECTRONIC COMPONENTS				
Kit	Valve Body Solenoids (Audi Only)	92-ON	1	4HP18.SOL10
700G	Range Switch (Audi Only)	92-ON	1	4HP18.ELE04
701G	Vehicle Speed Sensor (Audi Only)	92-ON	1	4HP18.ELE02
702G	Shift Solenoid (Audi Only)	92-ON	3	5HP18.SOL01
703G	Output Speed Sensor (Fits on Diff Cover)	92-ON	1	4HP18.ELE01
THRUST WASHERS & BEARINGS				
601E	Thrust Bearing Kit ('E' Clutch to Int. Shaft)	92-ON	1	4HP18.TK01
602E	Thrust Bearing Kit (Int. Shaft to Sun Gear Shaft) ...	92-ON	1	4HP18.TK05
603E	Thrust Bearing Kit (Sun Gear Shaft to Drive Shell)	92-ON	1	4HP18.TK03
604E	Thrust Bearing Kit (Planetary to O. Shaft)	92-ON	1	5HP18.TK04
606D	Thrust Bearing 'A' to 'E' Clutch..	92-ON	1	4HP18.TOR04
VALVE BODY PARTS				
NI	Spring Pressure Reg (Outer)	92-ON	1	5HP19.SPR03
NI	Encapulated Plastic Ball Valve (Fits in Main Valve Body)	92-ON	1	4HP22.VA01
NI	'E' Clutch Accumulator Spring (Codes: 1050 012 004)	92-ON	1	4HP14.SPR23
NI	Orifice Plate 9In Vave Body) (2.20mm).....	92-ON	AR	4HP18.VA02
	(1.00mm).....	92-ON	AR	4HP18.VA03
	(1.40mm).....	92-ON	AR	4HP18.VA04

ZF 4HP18FLE (AUDI/PORSCHE) Code: 1050 012 xxx

4 SPEED 2WD (Electronic Control)



AUTOMATIC CHOICE



THE AUTOMATIC TRANSMISSION PARTS WAREHOUSE

ILL NO.	DESCRIPTION	YEARS	QTY	PART NO
HARD PARTS				
803C	'A' Clutch Drum	92-ON	1	4HP18.DRU03
805C	'A' Clutch Piston	91-ON	1	4HP18.PIS01
807D	'E' Clutch Piston	92-ON	1	4HP18.PIS04
808B	'C'-'B' One Way Clutch Assy	92-ON	1	4HP18.OWC03
814E	Sun Gear Shaft	92-ON	1	5HP19.SH01
820F	Spider CL.Bell	92-ON	1	5HP19.PL01
NI	Cushion Spring 'C2' Servo (Pack of two)	92-ON	1	4HP18.SER02
SPECIAL ITEMS				
NI	ATSG Repair Manual	91-ON		4HP18.MAN02
NI	ATSG Diagnostic Guide	91-ON		4HP18.MAN03
NI	ATSG Diagnostic Guide (on CD). 91-ON			4HP18.MAN04

ILL NO.	DESCRIPTION	YEARS	QTY	PART NO