

VW 097

4 SPEED IN LINE FWD (Electronic Control)



AUTOMATIC CHOICE



THE AUTOMATIC TRANSMISSION PARTS WAREHOUSE

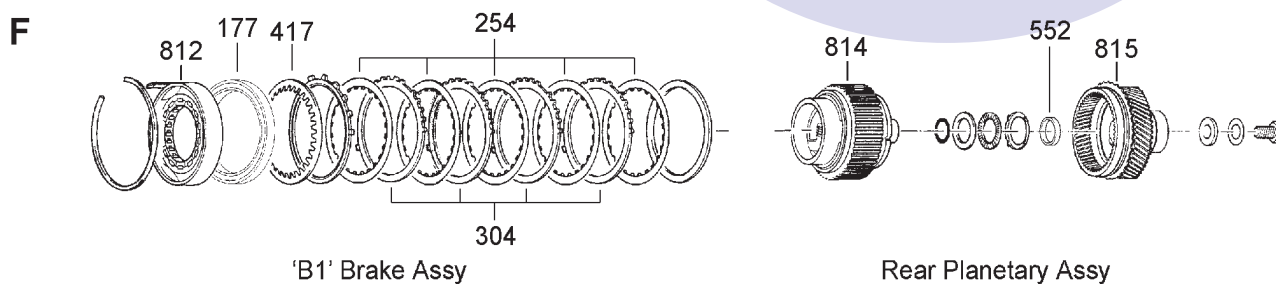
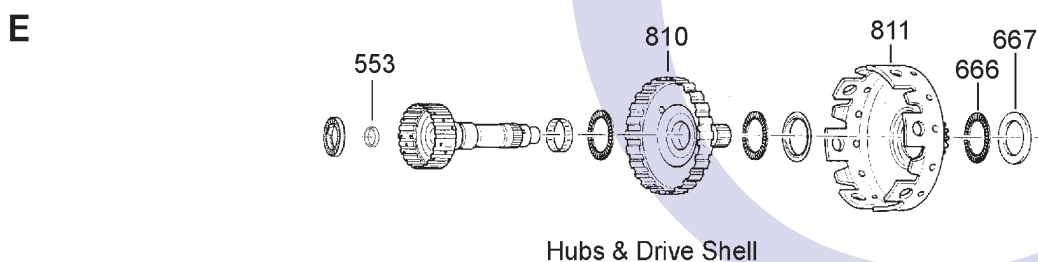
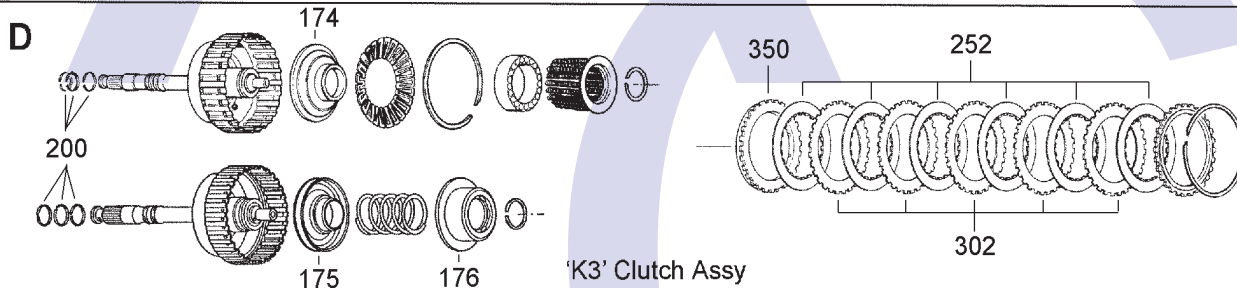
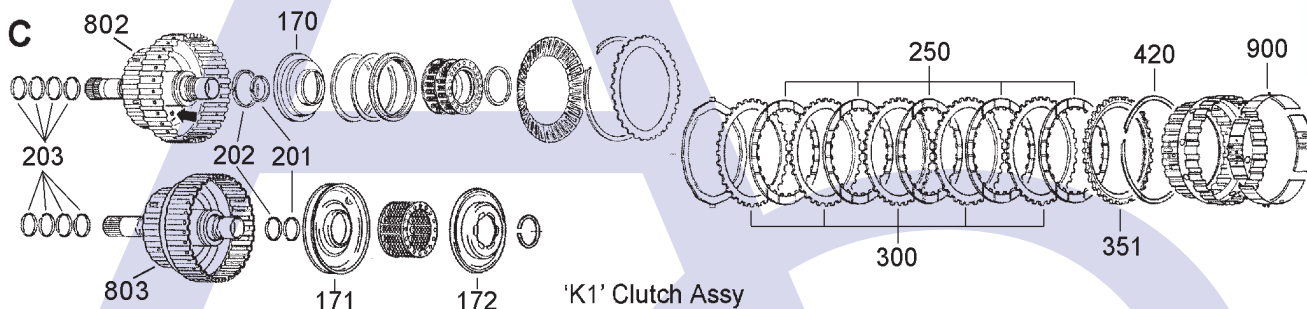
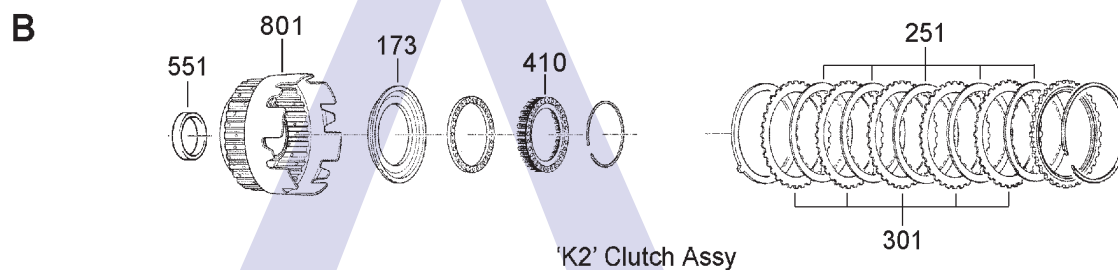
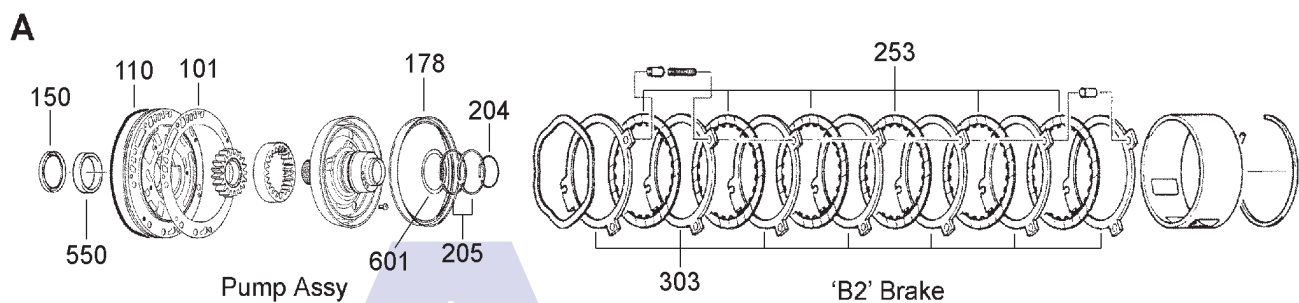

VW 097

4 SPEED IN LINE FWD (Electronic Control)



AUTOMATIC CHOICE



THE AUTOMATIC TRANSMISSION PARTS WAREHOUSE

G

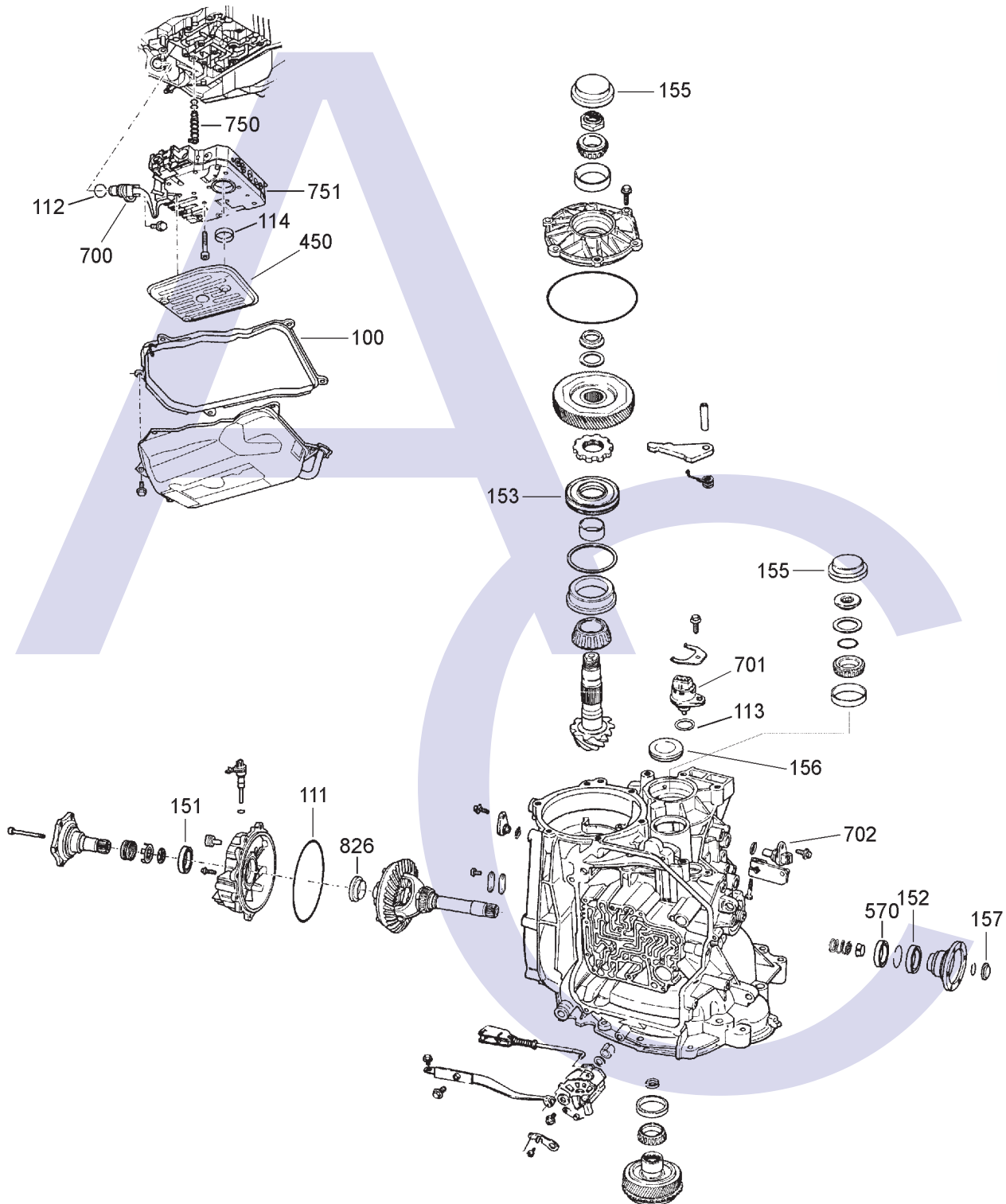

Case & Valve Body Components

VW 097

4 SPEED IN LINE FWD (Electronic Control)



AUTOMATIC CHOICE



THE AUTOMATIC TRANSMISSION PARTS WAREHOUSE

ILL NO.	DESCRIPTION	YEARS	QTY	PART NO
KITS				
Kit	Overhaul Kit (Transtec) (Without Pistons).....	90-ON	1	AG4.OHK02
Kit	Overhaul Kit (Precision) (Without Pistons).....	90-ON	1	AG4.OHK56
GASKETS				
100G	Pan Gasket	90-94	1	AG4.GAS01
101A	Pump Gasket	90-94	1	AG4.GAS02
NI	Solenoid Gasket.....	90-ON	7	AG4.GAS07
RUBBER COMPONENTS				
110A	Pump 'O' Ring.....	90-ON	1	AR4.OR01
111G	Side Cover 'O' Ring	90-ON	1	AR4.OR01
112G	Internal Loom Case Connector 'O' Ring.....	90-ON	1	AG4.OR07
113G	Multi Function 'O' Ring.....	90-ON	1	AG4.OR06
114G	Seal, Oil Filter	90-ON	1	AG4.GAS12
NI	Oil Cooler to Bolt 'O' Ring	90-ON	2	AG4.OR02
NI	Oil Cooler to Case 'O' Ring	90-ON	2	AG4.OR03
NI	Dipstick Tube 'O' Ring.....	90-ON	1	AG4.OR04
METAL CLAD SEALS				
150A	Converter Seal	90-ON	1	AG4.MCS01
151G	Drive Shaft Seal L/H	90-ON	1	AG4.MCS06
152G	Drive Shaft Seal R/H.....	90-ON	1	AG4.MCS07
153G	Pinion Seal.....	90-ON	1	AG4.MCS04
NI	Selector Shaft Seal	90-ON	2	AD4.MCS03
155G	End Sealing Cap (Large)	90-ON	2	AR4.CAP01
156G	End Sealing Cap (Small).....	90-ON	1	AR4.CAP02
157G	Drive Shaft End Plug.....	90-ON	2	AD4.MCS05
PISTONS				
NI	Piston Kit (5 Pieces).....	-01/93	1	AG4.PISKIT
NI	Piston Kit (7 Pieces).....	01/93-	1	AG4.PISKIT01
170C	'K1' Piston	-01/93	1	AR4.PIS01
171C	'K1' Piston	01/93-	1	AG4.PIS06
172C	'K1' Damper Piston	01/93-	1	AG4.SPR01
173B	'K2' Piston	90-ON	1	AG4.PIS02
174D	'K3' Piston	-01/93	1	AG4.PIS03
175D	'K3' Piston	01/93-	1	AG4.PIS07
176D	'K3' Damper Piston	01/93-	1	AG4.SPR02
177F	'B1' Piston	90-ON	1	AG4.PIS04
178A	'B2' Piston	90-ON	1	AG4.PIS05
SEALING RINGS				
Kit	Sealing Ring Kit (Transtec)	90-ON	1	AR4.SRK01
Kit	Sealing Ring Kit (Bryco).....	90-ON	1	AR4.SRK02
200D	Turbine Shaft	90-ON	3	AG4.SSR01
201C	Input Shaft Rear (Small)	90-ON	1	AG4.SSR02
202C	Input Shaft Rear (Large)	90-ON	1	AG4.SSR03
203C	Input Shaft Front	90-ON	4	AG4.SSR03
204A	Stator Support Rear	90-ON	1	AG4.SSR04
205A	Stator Support Front	90-ON	2	AG4.SSR05

ILL NO.	DESCRIPTION	YEARS	QTY	PART NO
FRICTION PLATES				
Kit	Friction Plate (96mm OD 'E3' Clutch)	90-ON	1	AR4.FRK01
Kit	Friction Plate (Alto) (96mm OD 'E3' Clutch)	90-95	1	AR4.FRK51
Kit	Friction Plate (104mm OD 'E3' Clutch)	90-ON	1	AR4.FRK02
250C	Forward Clutch ('K1') (122mm OD x 1.60mm x 24T) ..	90-ON	4-5	AR4.FRP11
250C	Forward Clutch ('K1') (Alto) (122mm OD x 1.60mm x 24T) ..	90-ON	4-5	AR4.FRP51
251B	Direct Clutch ('K2') (122mm OD x 1.60mm x 24T) ..	90-ON	4-5	AR4.FRP11
251B	Direct Clutch ('K2') (Alto) (122mm OD x 1.60mm x 24T) ..	90-ON	4-5	AR4.FRP51
252D	3-4 Clutch ('K3') (96mm OD x 1.60mm x 22T)	90-ON	4-6	AR4.FRP14
252D	3-4 Clutch ('K3') (104mm OD x 1.60mm x 22T) ..	90-ON	6	AR4.FRP15
252D	3-4 Clutch ('K3') (Alto) (104mm OD x 1.60mm x 22T) ..	90-ON	6	AR4.FRP55
253A	2-4 Brake ('B2') (154mm x 1.60mm x 32T).....	90-ON	4-6	AR4.FRP12
253A	2-4 Brake ('B2') (Alto) (154mm x 1.60mm x 32T).....	90-ON	4-6	AR4.FRP52
254F	Low & Reverse Brake ('B1') (146mm OD x 1.60mm x 50T) ..	90-ON	4-5	AR4.FRP13
254F	Low & Reverse Brake ('B1') (Alto) (146mm OD x 1.60mm x 50T) ..	90-ON	4-5	AR4.FRP53
STEEL PLATES				
Kit	Steel Plate (Alto).....	89-95	1	AG4.STK51
300C	Forward Clutch ('K1') (104MM ID x 2.00mm x 32T)	90-93	4-5	AR4.STP01
300C	Forward Clutch ('K1') (104MM ID x 1.50mm x 32T)	94-ON	4-5	AR4.STP09
301B	Direct Clutch ('K2') (104mm ID x 2.00mm x 32T)	90-ON	4-5	AR4.STP01
302D	3-4 Clutch ('K3') (72mm ID x 2.00mm x 26T)	90-ON	4-6	AR4.STP04
302D	3-4 Clutch ('K3') (72mm ID x 1.60mm x 28T)	90-ON	4-6	AR4.STP05
302D	3-4 Clutch ('K3') (72mm ID x 2.00mm x 28T)	90-ON	4-6	AR4.STP10
303A	2-4 Brake ('B2') (136mm ID x 2.00mm x 3T)	90-ON	AR	AR4.STP02
303A	2-4 Brake ('B2') (136mm ID x 2.15mm x 3T)	90-ON	AR	AR4.STP13
303A	2-4 Brake ('B2') (136mm ID x 2.40mm x 3T)	90-ON	AR	AR4.STP14
303A	2-4 Brake ('B2') (136mm ID x 2.66mm x 3T)	90-ON	AR	AR4.STP15
303A	2-4 Brake ('B2') (136mm ID x 3.00mm x 3T)	90-ON	AR	AR4.STP16
303A	2-4 Brake ('B2') (136mm ID x 3.50mm x 3T)	90-ON	AR	AR4.STP07
303A	2-4 Brake ('B2') (136mm ID x 3.75mm x 3T)	90-ON	AR	AR4.STP08
304F	Low & Reverse Brake ('B1') (129mm ID x 2.00mm x 12T)	90-ON	4-5	AR4.STP03
PRESSURE PLATES				
350D	Pressure Plate 'K3' Bottom (Replacement for OEM)	11/92-	1	AG4.PP01
351C	Pressure Plate 'K1' Top.....	90-ON	1	AR4.PP01

VW 097

4 SPEED IN LINE FWD (Electronic Control)



AUTOMATIC CHOICE



THE AUTOMATIC TRANSMISSION PARTS WAREHOUSE

ILL NO.	DESCRIPTION	YEARS	QTY	PART NO
SPRINGS & CIRCLIPS				
410B	Spring Assy, 'K2' Clutch	90-ON	1	AG4.SPR05
417F	'B1' Brake Diaphragm Spring....	90-ON	1	AG4.DIA01
420C	Circlip 'K1' Clutch Retaining			
	(1.60mm).....	90-ON	1	AG4.CIR02
	(1.80mm).....	90-ON	1	AG4.CIR03
	(2.00mm).....	90-ON	1	AG4.CIR01
	(2.20mm).....	90-ON	1	AG4.CIR04
FILTERS				
NI	Filter Kit.....	90-ON	1	AG4.FILKIT02
450G	Filter	90-ON	1	AG4.FIL01
BUSHINGS				
Kit	Bush Kit (7 Pieces)	90-ON	1	AD4.BK01
550A	Pump Bush	90-ON	1	AG4.BUS01
551B	Bush 'K2' Drum	90-ON	1	AG4.BUS02
552F	Bush Planetary to O.Shaft	90-ON	1	AG4.BUS03
553E	Bush 'K3' Drum to Hub	90-ON	1	AG4.BUS04
570G	Bearing, Drive Flange	90-ON	1	AG4.BE07
THRUST WASHERS & BEARINGS				
600B	Thrust Washer 'K1' to 'K2'			
	(1.00mm Brown Plastic).....	90-ON	1	AG4.THW01
600B	Thrust Washer 'K1' to 'K2'			
	(1.20mm Green Plastic).....	90-ON	1	AG4.THW02
600B	Thrust Washer 'K1' to 'K2'			
	(1.40mm Natural Plastic)	90-ON	1	AG4.THW03
600B	Thrust Washer 'K1' to 'K2'			
	(1.60mm Black Plastic)	90-ON	1	AG4.THW04
600B	Thrust Washer 'K1' to 'K2'			
	(1.80mm Grey Plastic)	90-ON	1	AG4.THW05
601A	Thrust Washer			
	(Pump Stator to 'K2').....	90-ON	1	AR4.THW01
666E	Radial Needle Bearing			
	Large S.Gear to Small S.Gear..	90-ON	1	AG4.TOR01
667E	Thrust Plate for AG4.TOR01.....	90-ON	1	AG4.TOR02
ELECTRICAL COMPONENTS				
700G	Solenoid Loom (OEM)	90-ON	1	AG4.ELE03
700G	Solenoid Loom (Aftermarket)	90-ON	1	AG4.ELE33
700G	Solenoid Loom (Rostra®)			
	(10 Pin Universal Type).....	90-ON	1	AG4.ELE14
701G	Multi Function Switch			
	(Rectangular Connector).....	90-ON	1	AG4.ELE05
701G	Multi Function Switch			
	(Rectangular connector rounded at one end, with squared off end facing mounting hole)	90-ON	1	AG4.ELE06
701G	Multi Function Switch			
	(Rectangular connector rounded at one end, with squared off end at 90 deg to mounting hole)	90-ON	1	AG4.ELE10
702G	Speed Sensor	90-ON	AR	AG4.ELE11
NI	EPC Solenoid.....	90-ON	1	AG4.SOL01
NI	EPC Solenoid (Aftermarket).....	90-ON	1	AG4.SOL11
NI	Shift Solenoid.....	90-ON	6	AG4.SOL02
NI	Shift Solenoid (Aftermarket).....	90-ON	6	AG4.SOL12
NI	Plug, Vehicle Loom to Transmission Harness (Fits on Vehicle Loom)	90-ON	1	AG4.ELE15

ILL NO.	DESCRIPTION	YEARS	QTY	PART NO
VALVE BODY PARTS				
Kit	Sure Cure Kit® (Sonnax®) Requires the following tools (AG4.VA06, AG4.VA14, AG4.VA09 & AG4.VA05) (Click Here for Details).....	90-ON	1	AG4.SCK02
Kit	Shift Valve End Plug Kit, Replaces OEM (Sonnax® Click here for Info) ...	90-ON	1	AG4.PLU02
Kit	Oversized Solenoid Regulator Valve (Requires Tool AG4.VA09) (Sonnax ®).....	90-ON	1	AG4.VA08
Kit	Reamer, Jig & Guide Pin for AG4.VA08 (Sonnax ®) ↑	90-ON	1	AG4.VA09
Kit	Oversize Boost Regulator Valve (Requires Tool AG4.VA14) (Sonnax ®).....	90-ON	1	AG4.VA13
Kit	Reamer, Jig, Guide Pin & Adjustment Tool for AG4.VA13 (Sonnax ®) ↑	90-ON	1	AG4.VA14
Kit	Oversized Main Regulator Valve (Requires Tool AG4.VA06) (Sonnax ®).....	90-ON	1	AG4.VA15
Kit	Reamer, Jig & Guide Pin for AG4.VA15 (Sonnax ®) ↑	90-ON	1	AG4.VA06
750G	'F1' Feed Tube (52mm Long)....	90-ON	1	AG4.TU04
751G	Valve Body Assembly (Transmission Code Required)			
NI	Plastic Ratcheting Pressure Regulator Control Valve Plug (Requires Tool AG4.TOOL07) ...	90-ON	1	AG4.PLU03
NI	Plastic Ratcheting Pressure Regulator Control Valve Plug (Does Not Require Tool)	90-ON	1	AG4.PLU05
NI	Plastic Valve Retaining Plug (12mm OD, Tan Smallest).....	90-ON	AR	AG4.PLU01
NI	Spring, Valve Body Check ball..	90-ON	1	AG4.SPR03
↑ Also Requires Valve Body Reaming Fixture AG4.VA05				
HARD PARTS				
801B	'K2' Clutch Drum Assy Exchange.....	90-ON	1	AG4.DRU09
802C	'K1' Clutch Drum Assy Exchange (Early Single Piston Type).....	90-ON	1	AG4.DRU03
803C	'K1' Clutch Drum Assy Exchange (Late Double Piston Type)	L92-ON	1	AG4.DRU06
810E	Hub & Shaft 'K1' Clutch.....	90-ON	1	AG4.HUB01
811E	Drive Shell.....	90-ON	1	AG4.POT01
812F	One Way Clutch Assembly	90-ON	1	AG4.OWC01
814F	Planetary Set (OEM) (Box Code Needed)	90-94	1	AG4.PL05
NI	Sun Gear for AG4.PL05	90-94	1	AG4.SUN01
814F	Planetary Set (Check Codes) ...	94-ON	1	AG4.PL06
815F	Anulus/Drive Gear (51/44 T)	90-ON	1	AG4.PL08
826G	Differential to Flange.....	90-ON	1	AG4.SP06
SPECIAL ITEMS				
900C	'K1' Clutch Support Ring (Plastic 4 per Trans Wide).....	-01/93	4	AR4.RET01
900C	'K1' Clutch Support Ring (Precision) (Plastic 4 per Trans Narrow)	01/93-	4	AG4.RET01
900C	'K1' Clutch Support Ring (Transec) (Plastic 4 per Trans Narrow)	01/93-	4	AG4.RET02
NI	Plastic Valve Body Plug Kit.....	90-ON	1	AG4.PLU02
NI	Adaptor Kit for External Cooler (Sonnax® Click Here for Info) ...	90-ON	1	AG4.COO01

VW 097

4 SPEED IN LINE FWD (Electronic Control)



A
U
T
O
M
A
T
I
C

C
H
O
I
C
E



T
H
E

A
U
T
O
M
A
T
I
C

T
R
A
N
S
M
I
S
S
I
O
N

P
A
R
T
S

W
A
R
E
H
O
U
S
E

ILL NO.	DESCRIPTION	YEARS	QTY	PART NO
TOOLS & MANUALS				
NI	ATSG Rebuild Manual	90-ON		AG4.MAN01
NI	Transonline Tech Manual	90-ON		AG4.MAN03
NI	Valve Body Reaming Fixture (Sonnax ®, Multiple Applications)			AG4.VA05
Click here to view special tools for this transmission				

ILL NO.	DESCRIPTION	YEARS	QTY	PART NO
-----------------	-------------	-------	-----	---------