

# TH180, TH180C (THM3L30, MD-2)

3 SPEED RWD With & Without Lock Up



AUTOMATIC CHOICE



THE AUTOMATIC TRANSMISSION PARTS WAREHOUSE

A

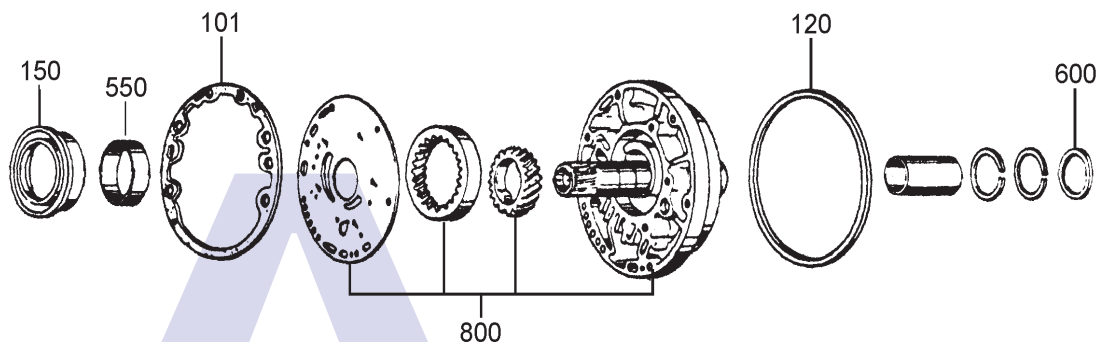

Pump Assembly

B

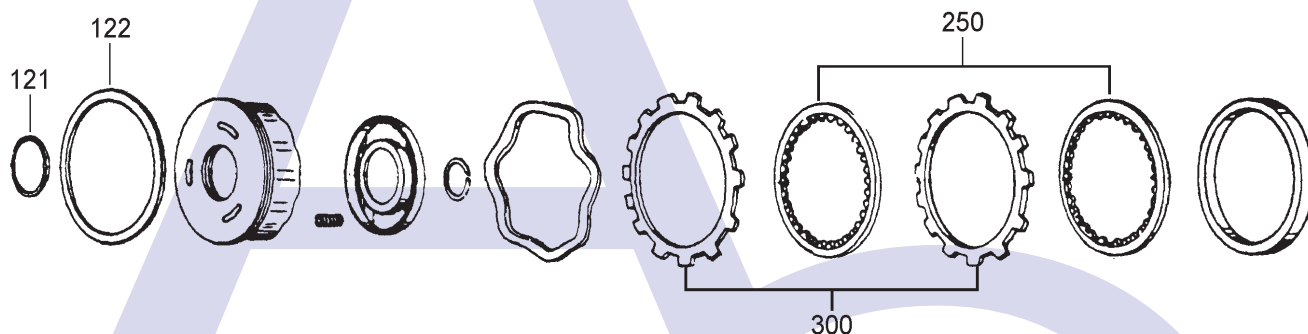

Reverse Clutch

C

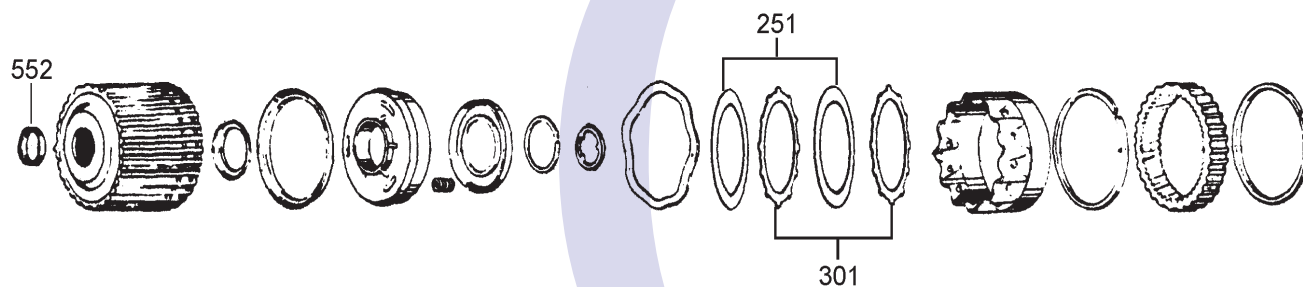

Intermediate Clutch

D

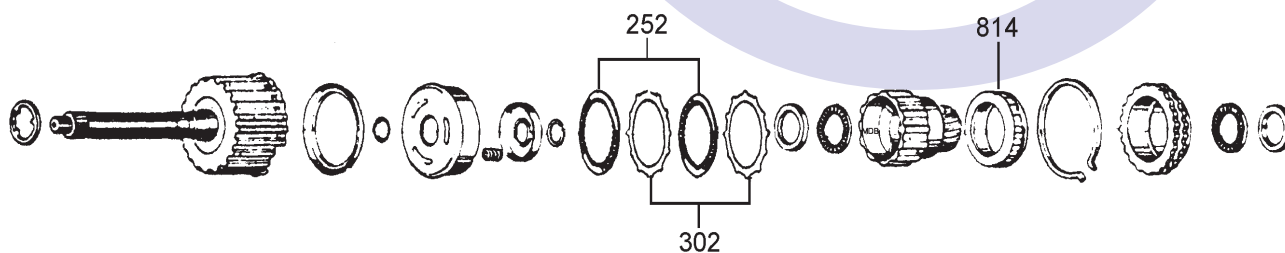

High Clutch

# TH180, TH180C (THM3L30, MD-2)

## 3 SPEED RWD With & Without Lock Up



AUTOMATIC CHOICE



THE AUTOMATIC TRANSMISSION PARTS WAREHOUSE

E

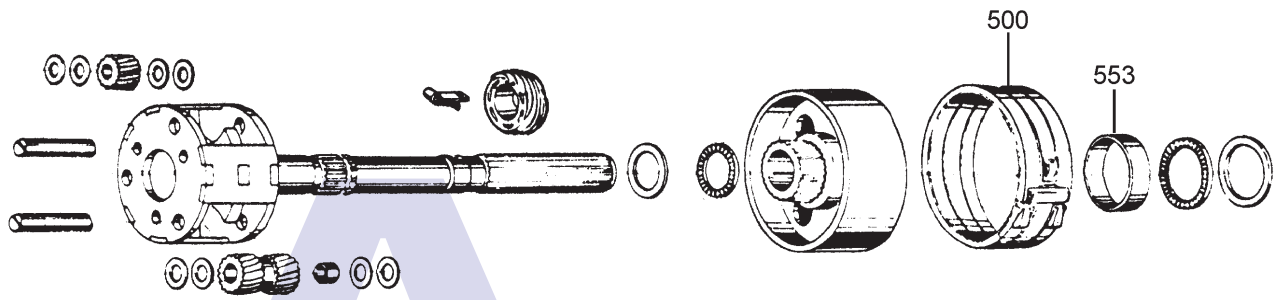

PLanetary Assembly

F

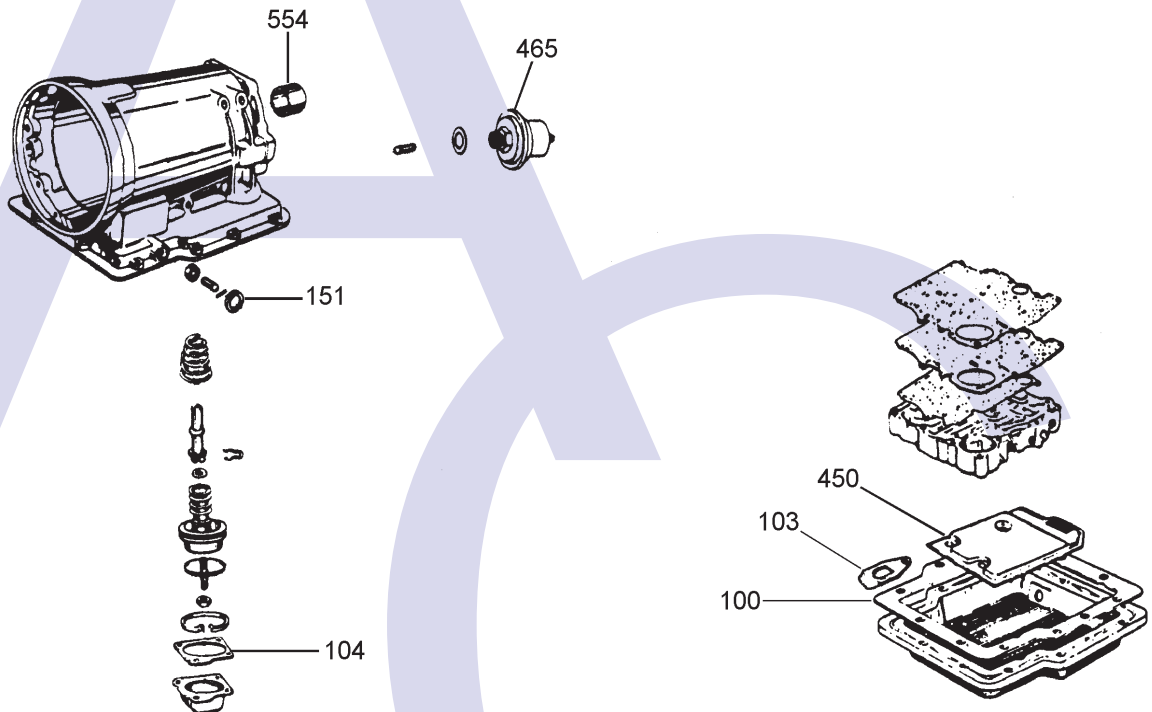

Case, Servo Assembly & Valve Body

G

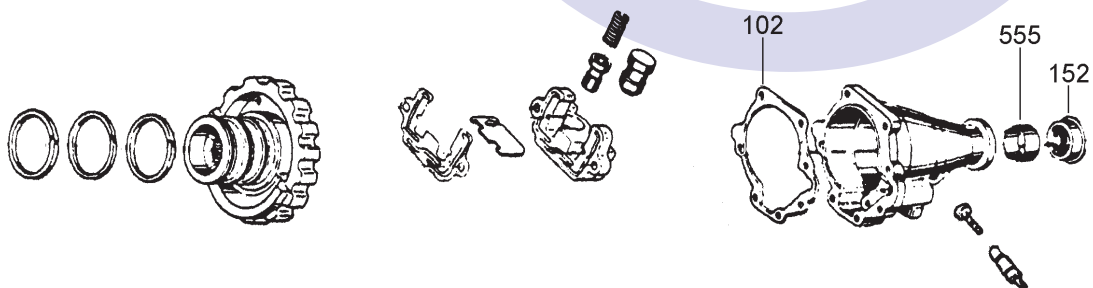

Output Shaft & Governor Assembly

# TH180, TH180C (THM3L30, MD-2)

## 3 SPEED RWD With & Without Lock Up



AUTOMATIC CHOICE



THE AUTOMATIC TRANSMISSION PARTS WAREHOUSE

ILL NO.	DESCRIPTION	YEARS	QTY	PART NO
<b>KITS</b>				
Kit	Overhaul Kit (Transtec).....	69-89	1	TH180.OHK01
Kit	Overhaul Kit (Precision).....	69-89	1	TH180.OHK51
Kit	Overhaul Kit (Precision) (Australian Market).....	69-89	1	TH180.OHK52
Kit	Gasket & Rubber .....	69-ON	1	TH180.GSK01
<b>GASKETS</b>				
100F	Pan Gasket TH180 .....	69-89	1	TH180.GAS01
100F	Pan Gasket TH180 (Fibre).....	69-89	1	TH180.GAS10
101A	Front Pump Gasket TH180 .....	69-ON	1	TH180.GAS02
102G	Extension Housing .....	69-ON	1	TH180.GAS03
103F	Filter Gasket.....	69-ON	1	TH180.GAS05
104F	Servo Cover .....	69-ON	1	TH180.GAS04
NI	Washer, Pump Bolt .....	69-ON	12	TH180.WA01
<b>RUBBER COMPONENTS</b>				
120A	Pump Lathe Cut Seal.....	69-ON	1	TH180.OR01
	121B..... Reverse Clutch Inner Seal			
69-ON	1.....			TH180.SQR01
122B	Reverse Clutch Outer Seal .....	69-ON	1	TH180.SQR02
NI	Filler Tube Seal Multi Lip.....	69-ON	1	TH125.LIP03
<b>METAL CLAD SEALS</b>				
150A	Converter Seal .....	69-ON	1	TH180.MCS01
151F	Selector Shaft .....	69-ON	1	TH180.MCS03
152G	Extension Housing .....	69-ON	1	TH180.MCS02
NI	Speedo Driven Gear Shaft (With Spring) .....	69-ON	1	TH180.MCS04
NI	Speedo Driven Gear Shaft (Without Spring) .....	69-ON	1	TH180.MCS05
<b>SEALING RINGS</b>				
Kit	Sealing Ring Kit .....	69-ON	1	TH180.SRK01
<b>FRICTION PLATES</b>				
Kit	Friction Plate .....	69-ON	1	TH180.FRK01
Kit	Friction Plate (Alto) (US Market).....	69-ON	1	TH180.FRK51
Kit	Friction Plate (Alto) (European Market) .....	69-ON	1	TH180.FRK52
Kit	Friction Plate (Alto) (Australian Market, Holden) .....	69-78	1	TH180.FRK53
250B	Reverse Brake (163mm OD x 2.50mm x 36T) ..	69-ON	3-6	TH180.FRP03
251C	Intermediate/2nd Clutch (133mm OD x 2.50mm x 30T) ..	69-ON	3-6	TH180.FRP02
252D	High/3rd Clutch (98mm OD x 1.50mm x 12T) ....	69-ON	3-5	TH180.FRP01

ILL NO.	DESCRIPTION	YEARS	QTY	PART NO
<b>STEEL PLATES</b>				
Kit	Steel Plate (2.11mm Steels).....	69-ON	1	TH180.STK01
Kit	Steel Plate (Alto) (US Market).....	69-ON	1	TH180.STK51
Kit	Steel Plate (Alto) (European Market).....	69-ON	1	TH180.STK52
Kit	Steel Plate (Alto) (Australian Market, Holden) .....	69-78	1	TH180.STK53
300B	Reverse Clutch (144mm ID x 1.78mm x 7T) .....	69-ON	3-6	TH180.STP03
300B	Reverse Clutch (144mm ID x 2.11mm x 7T) .....	69-ON	3-6	TH180.STP06
301C	Intermediate/2nd Clutch (109mm ID x 1.78mm x 36T) ....	69-ON	4-7	TH180.STP02
301C	Intermediate/2nd Clutch (109mm ID x 2.11mm x 36T) ....	69-ON	4-7	TH180.STP05
301C	Intermediate/2nd Clutch (Shim) (109mm ID x 0.50mm x 36T) ....	69-ON	4-7	TH180.STP08
302D	High/3rd Clutch (72mm ID x 1.78mm x 30T) .....	69-ON	4-6	TH180.STP01
302D	High/3rd Clutch (72mm ID x 2.11mm x 30T) .....	69-ON	4-6	TH180.STP04
302D	High/3rd Clutch (Shim) (72mm ID x 0.50mm x 30T) .....	69-ON	AR	TH180.STP07
<b>SPRINGS &amp; CIRCLIPS</b>				
<b>FILTERS</b>				
450F	Pan Filter.....	69-ON	1	TH180.FIL01
<b>MODULATORS</b>				
465F	Modulator (Non Adjustable) .....	69-ON	1	TH180.MOD01
465F	Modulator (Adjustable).....	69-ON	1	TH180.MOD04
465F	Modulator (Blue Stripe) .....	1979	1	TH180.MOD03
465F	Modulator (Rover 2600/2300) ...	80-ON	1	TH180.MOD03
465F	Modulator (Rover 3500 OEM)...	80-ON	1	TH180.MOD22
<b>BANDS</b>				
500E	Low (New not Reline).....	69-ON	1	TH180.BAN01
<b>BUSHES</b>				
Kit	Bush Kit.....	69-ON	1	TH180.BK01
550A	Converter Housing (Pump) .....	69-ON	1	TH180.BUS01
550A	Converter Housing (PTFE Lined) (Sonnax® <a href="#">Click here for Info</a> ) ..	69-ON	1	TH180.BUS02
552C	2nd Clutch Drum .....	69-ON	1	TH180.BUS05
553E	Reaction Sun Gear/Band Drum	69-ON	1	TH180.BUS04
554F	Casing Rear .....	69-ON	1	TH180.BUS09
555G	Extension Housing.....	69-ON	1	TH350.BUS09
NI	Low Servo Pin Bore Repair Bush (Use With TOOL.114).....	69-ON	1	4L30E.BUS04

# TH180, TH180C (THM3L30, MD-2)

## 3 SPEED RWD With & Without Lock Up



AUTOMATIC CHOICE



THE AUTOMATIC TRANSMISSION PARTS WAREHOUSE

ILL NO.	DESCRIPTION	YEARS	QTY	PART NO
<b>THRUST WASHERS &amp; BEARINGS</b>				
Kit	Thrust Repair Kit & Selective Shim Kit (Replaces 3 tab PumpWashers to correct end play if parts have been machined, or OEM plastic washers are not thick enough) .....	69-ON	1	TH180.TK02
600A	Pump Selective Thrust With 3 Tabs (1.75mm "Red") .....	69-ON	AR	TH180.THW01
	(1.96mm "Black") .....	69-ON	AR	TH180.THW02
	(2.13mm "White") .....	69-ON	AR	TH180.THW03
	(2.34mm "Green") .....	69-ON	AR	TH180.THW04
	(2.54mm "Blue") .....	69-ON	AR	TH180.THW06
<b>HARD PARTS</b>				
800A	Pump Assy (Non Lock Up) .....	69-ON	1	TH180.PUM02
800A	Pump Assy (Lock Up) .....	80-ON	1	TH180.PUM01
800A	Pump Assy (Rover Only) .....	69-ON	1	TH180.PUM01
814D	Sprag, 3rd Clutch (26 Elements) .....	69-ON	1	TH180.OWC01
<b>SUNDRY PARTS</b>				
NI	Converter Bolt (Metric) .....	78-ON	3	TH180.NUT01
<b>TOOLS &amp; MANUALS</b>				
<a href="#">Click here to view special tools for this transmission</a>				

ILL NO.	DESCRIPTION	YEARS	QTY	PART NO