

**ELECTRONIC SHIFT WITH VISCOUS LOCKING DIFFERENTIAL**



AUTOMATIC CHOICE



THE AUTOMATIC TRANSMISSION PARTS WAREHOUSE

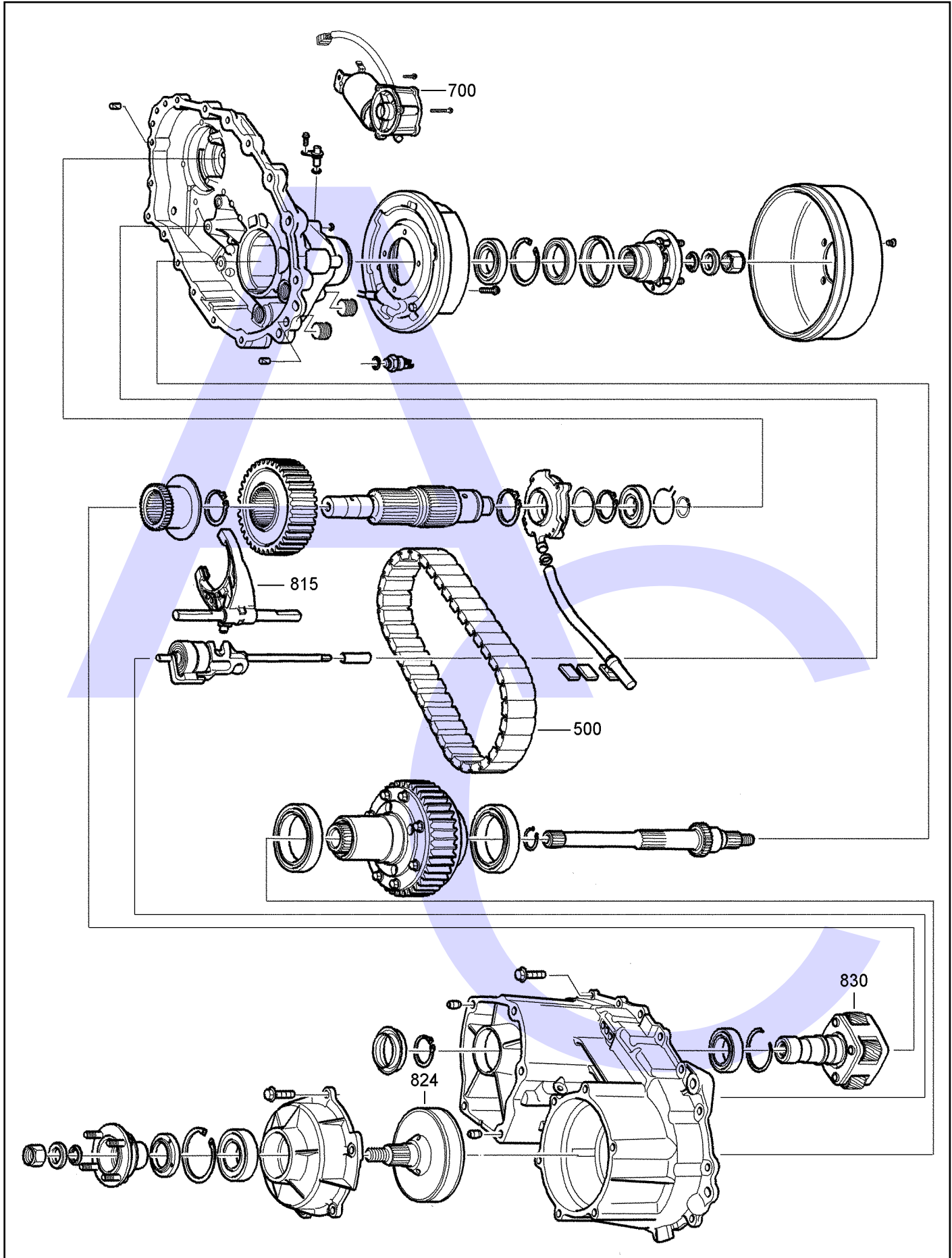

## ELECTRONIC SHIFT WITH VISCOUS LOCKING DIFFERENTIAL



AUTOMATIC CHOICE



THE AUTOMATIC TRANSMISSION PARTS WAREHOUSE

| ILL NO.                                 | DESCRIPTION                                 | YEARS | QTY | PART NO        |
|---|---|-------|-----|----------------|
| <b>MASTER OVERHAUL KITS</b>             |   |       |     |                |
| Kit                                     | Master Overhaul Kit.....                    | 95-ON | 1   | YBW4462.MOHK01 |
| <b>OVERHAUL GASKET AND SEAL KITS</b>    |   |       |     |                |
| Kit                                     | Gasket & Seal Kit.....                      | 95-ON | 1   | YBW4462.GSK01  |
| <b>GASKET &amp; RUBBER COMPONENTS</b>   |   |       |     |                |
| <b>METAL CLAD SEALS</b>                 |   |       |     |                |
| <b>BUSHINGS, BEARINGS &amp; WASHERS</b> |   |       |     |                |
| <b>DRIVE CHAINS</b>                     |   |       |     |                |
| 500                                     | Drive Chain.....                            | 95-ON | 1   | YBW4462.CH01   |
| <b>ELECTRICAL COMPONENTS</b>            |   |       |     |                |
| 700                                     | Ratio Control Motor.....                    | 95-ON | 1   | YBW4462.ELE01  |
| <b>HARD PARTS</b>                       |   |       |     |                |
| 815                                     | Selector Fork.....                          | 95-ON | 1   | YBW4462.SEL01  |
| 824                                     | Viscous Coupling.....                       | 95-ON | 1   | YBW1361.VC01   |
| 830                                     | Planetary Helical<br>(Manual Units).....    | 95-ON | 1   | YBW4462.PL01   |
| 830                                     | Planetary Helical<br>(Automatic Units)..... | 95-ON | 1   | YBW4462.PL02   |
| <b>MOUNTINGS</b>                        |   |       |     |                |
| <b>TRANSFER CASE ASSY'S</b>             |   |       |     |                |
| NI                                      | Rebuilt Unit (462-003).....                 | 95-ON | 1   | YBW4462.003    |
| <b>TOOLS &amp; MANUALS</b>              |   |       |     |                |

| ILL NO. | DESCRIPTION | YEARS | QTY | PART NO |
|---------|-------------|-------|-----|---------|
|---------|-------------|-------|-----|---------|