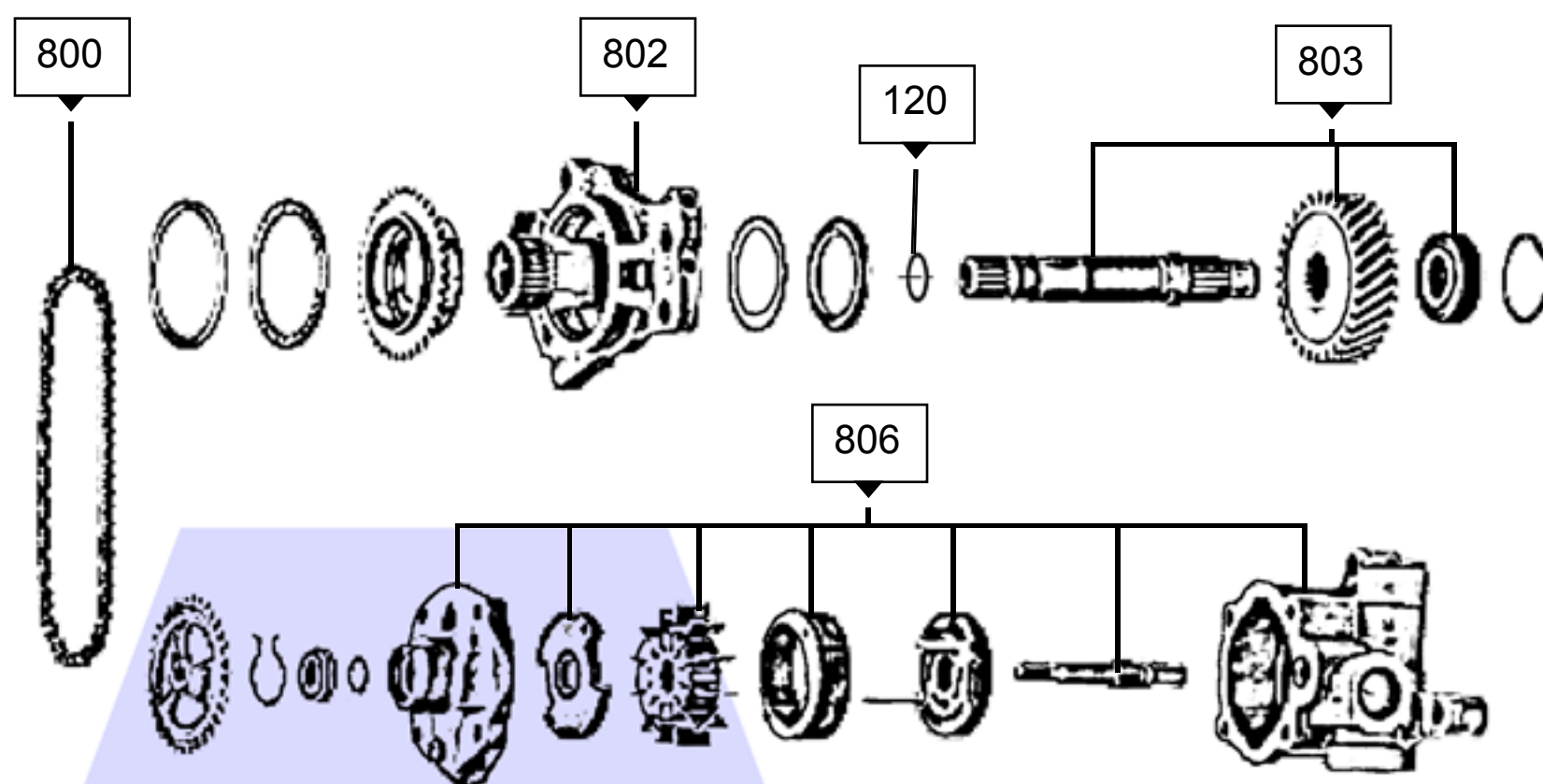
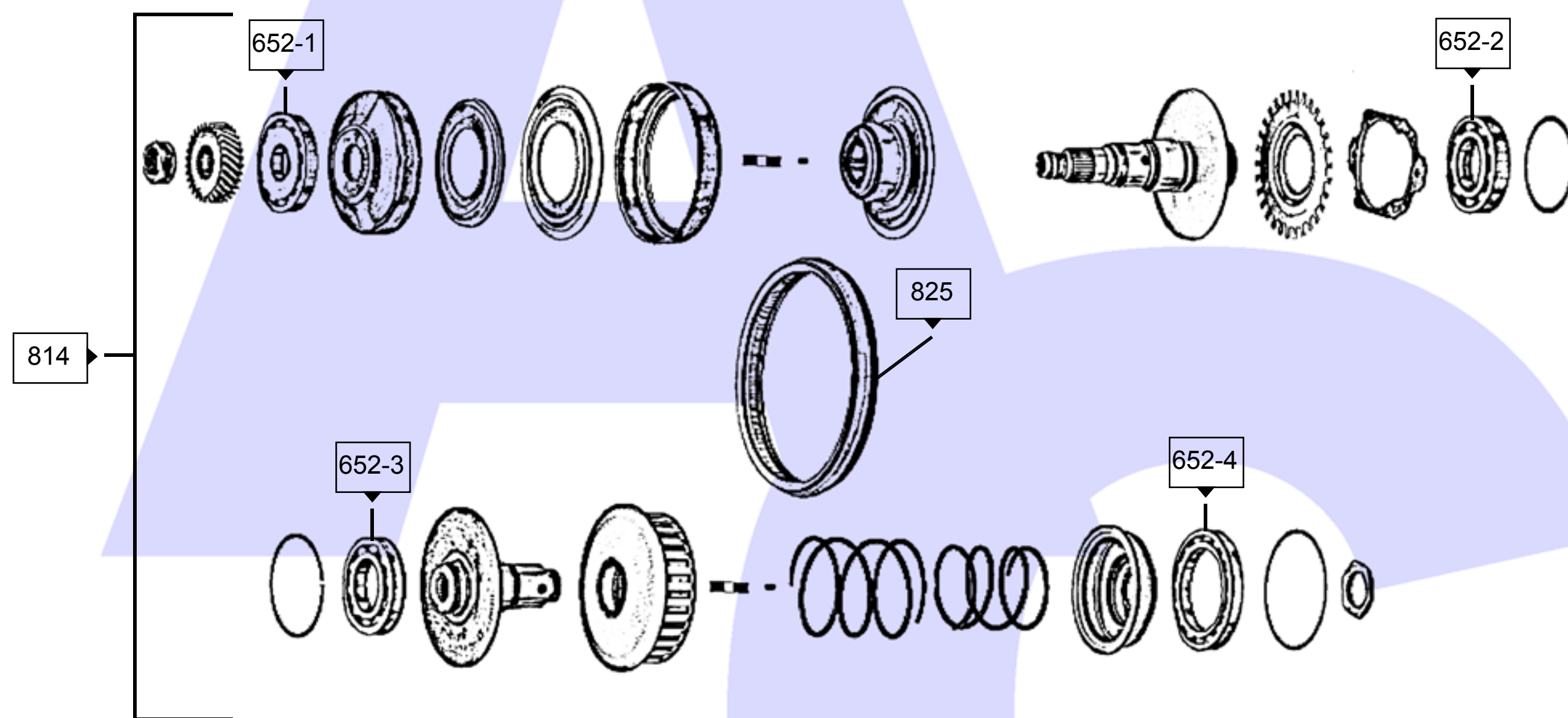
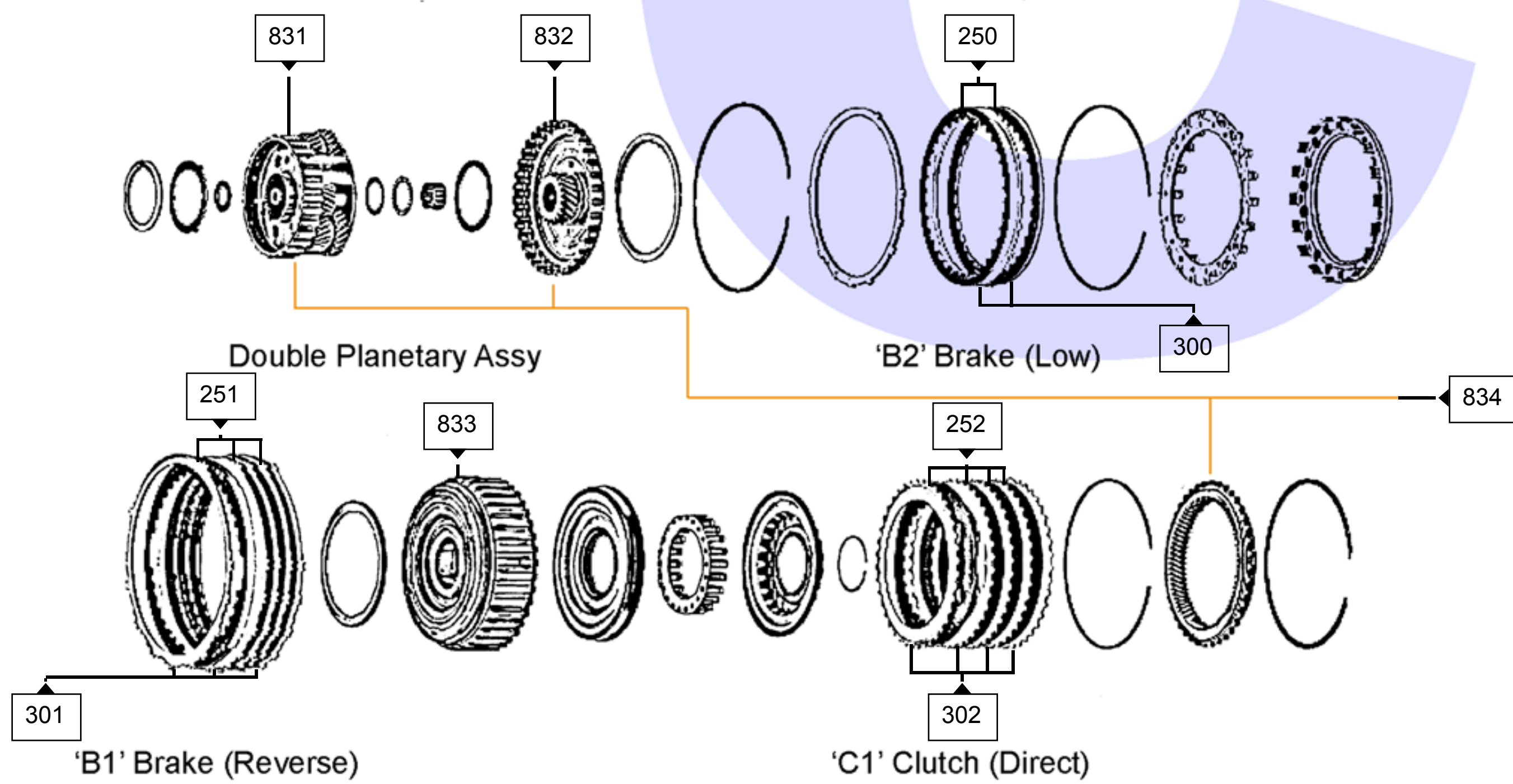

A

Input Shaft and Oil Pump Assy

B

Primary and Secondary Drums

C

D



'B1 Drum and Piston

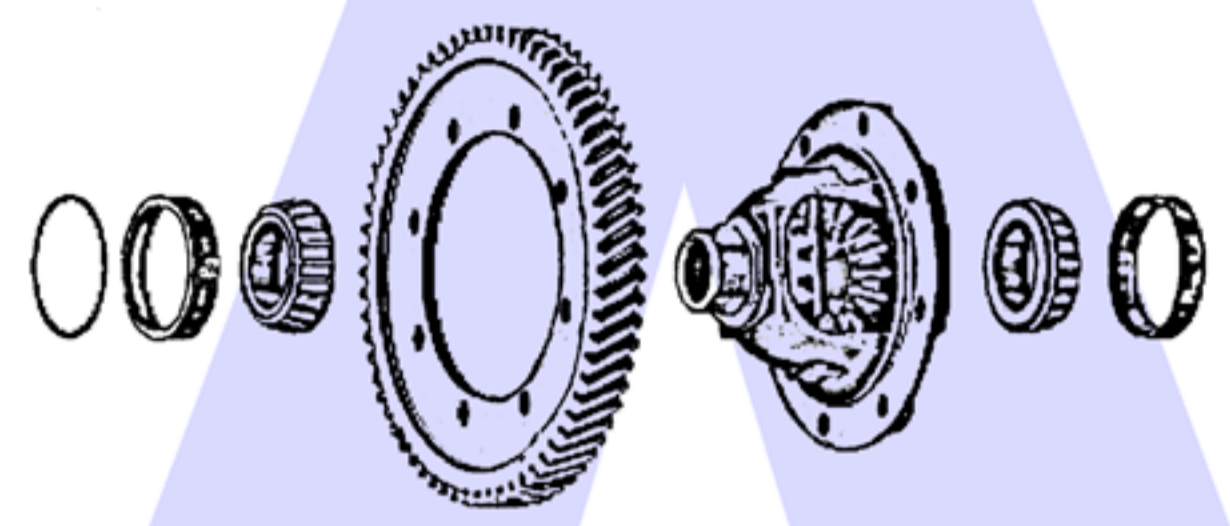

Output Gear and Differential Assy

E

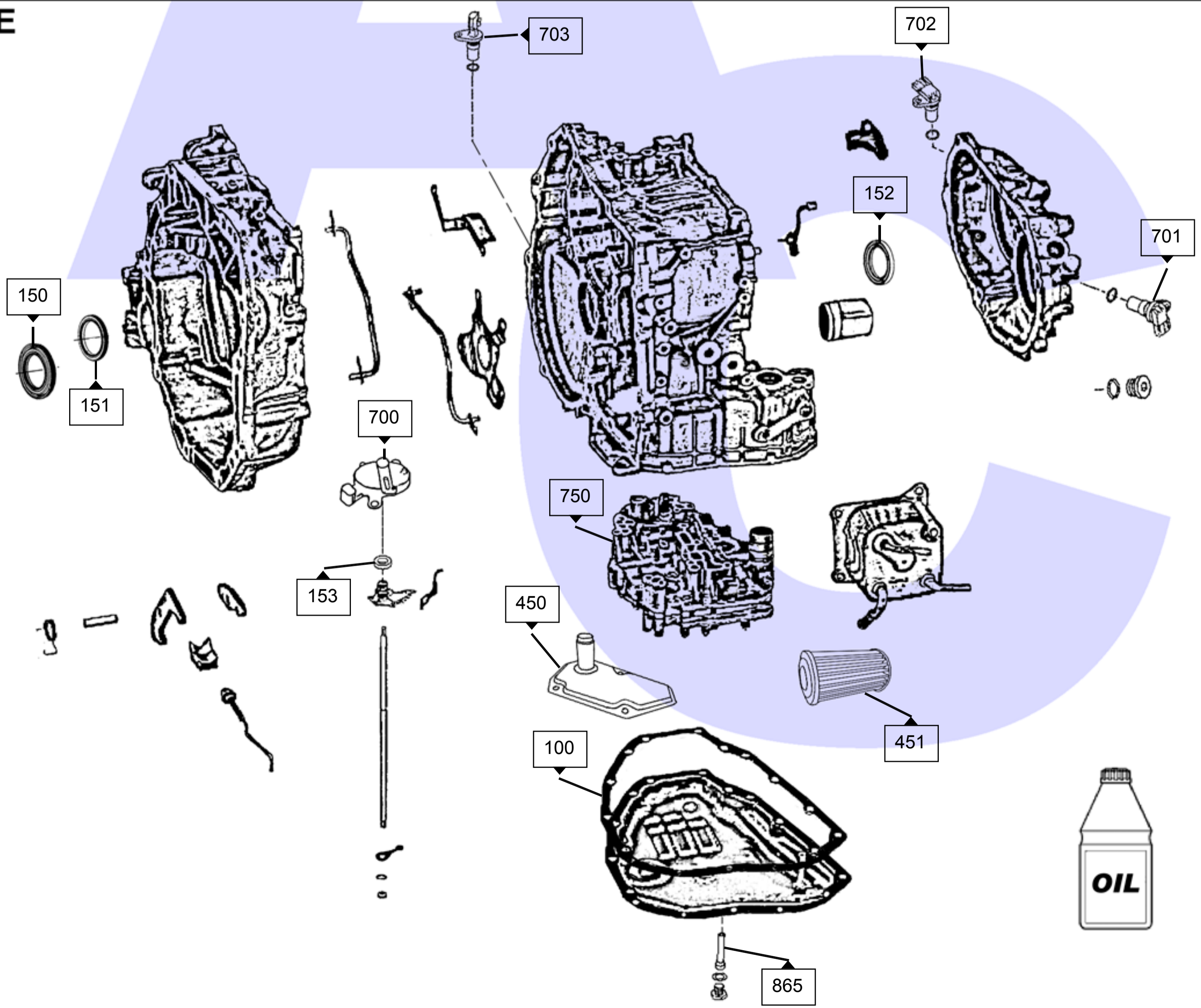

Casings, Valve Body, Filters and External Items Etc.

Bearings (000174)

REF	DESCRIPTION	QUANTITY	PART NO
652-1 / 652-2 / 652-3 / 652-4	#USED SET OF 4 PULLEY BEARINGS NISSAN JUKE	1	JF015E.BE20

Bushings (000180)

REF	DESCRIPTION	QUANTITY	PART NO
	JF015E/RE0F11A PUMP BUSH	1	JF015E.BUS51

Electrical Parts (000250)

REF	DESCRIPTION	QUANTITY	PART NO
	# USED JF015E SOLENOID SET	1	JF015E.SOL20
700	JF015E RE0F11A RANGE SWITCH	1	JF015E.ELE01
701 / 702	# JF011E / JF015E SPEED SENSOR ANGLED CONNECTOR	1	JF011E.ELE02
703	# JF011E / JF015E SPEED SENSOR STRAIGHT CONNECTOR	1	JF011E.ELE01

Filters (000150)

REF	DESCRIPTION	QUANTITY	PART NO
450	# JF015E RE0F11A INTERNAL FILTER 2010-	1	JF015E.FIL01
451	# JF015E RE0E11A EXTERNAL FILTER OEM	1	JF015E.FIL02
451	# JF015E/JF016E EXTERNAL FILTER AFTERMARKET	1	JF015E.FIL52

Friction Plates (000130)

REF	DESCRIPTION	QUANTITY	PART NO
250	JF015E/RE0F11A FRICTION LOW CLUTCH	2	JF015E.FRP51
251	JF015E/RE0F11A FRICTION REVERSE CLUTCH	4	JF015E.FRP53
252	JF015E/RE0F11A FRICTION FORWARD CLUTCH 1.6mm	4	JF015E.FRP52

Gaskets (000120)

REF	DESCRIPTION	QUANTITY	PART NO
100	JF015E RE0F11A PAN GASKET OEM	1	JF015E.GAS01
100	JF015E PAN GASKET (TRANSTEC) (METAL)	1	JF015E.GAS02
100	JF015E RE0F11A PAN GASKET A/M (RUBBER)	1	JF015E.GAS51

Hard Parts (000240)

REF	DESCRIPTION	QUANTITY	PART NO
802	USED JF015E STATOR SUPPORT FOR INPUT SHAFT	1	JF015E.SUP01
803	# USED JF015E (31T 72mm OD) INP. SHAFT/BRG JUKE	1	JF015E.SH01
803	# USED JF015E (32T 74mm OD 3 ID GROOVE) INP. SHAFT/BRG	1	JF015E.SH02
806	USED JF015E PUMP ASSY NISSAN JUKE	1	JF015E.PUM01
814	# USED JF015E PULLEY SET WITH BELT 30T ON PULLEY	1	JF015E.DRU01
825	# JF015E CHAIN (CH068)	1	JF015E.CH01
831 / 834	USED JF015E DOUBLE PLANET SET	1	JF015E.PLK01
832	USED JF015E SUNGEAR/FWD CLUTCH HUB	1	JF015E.SUN01
833	USED JF015E FORWARD CLUTCH DRUM	1	JF015E.DRU02

Metal Clad Seals (000125)

REF	DESCRIPTION	QUANTITY	PART NO
	USE A130.MCS03 SELECTOR SHAFT SEAL	1	JF015E.MCS04
	# USE JF506E.MCS06 JF015E DRIVE SHAFT SEAL LH/RH	1	JF015E.MCS05
150	# JF015E RE0F11A CONVERTER SEAL	1	JF015E.MCS01
150	JF015E RE0F11A CONVERTER SEAL AFTERMARKET	1	JF015E.MCS51
151	JF015E RH 4X4 SEAL	1	JF015E.MCS06
151 / 152	JF015E DRIVE SHAFT SEAL LH/RH	1	JF015E.MCS52
151 / 152	USE RL43.MCS02 MONDEO/MAZDA D/SHAFT SEAL 56 x 40 x 8	1	JF506E.MCS06
153	# A43/A130/A140/A340/U140/U240/TF72SC MANUAL SHAFT SEAL	2-3	A130.MCS03

Overhaul Kits (000110)

REF	DESCRIPTION	QUANTITY	PART NO
	JF015E OVERHAUL KIT WITH PISTONS	1	JF015E.OHK01
	# JF015E OVERHAUL KIT W/O PISTONS	1	JF015E.OHK02
	JF015E OVERHAUL KIT WITH PISTONS (CHEVY SPARK) 2013-	1	JF015E.OHK03
	JF015E OVERHAUL KIT WITHOUT PISTONS (CHEVY SPARK) 2013-	1	JF015E.OHK04

Piston Kits (000225)

REF	DESCRIPTION	QUANTITY	PART NO
	# JF015E FWD PISTON & DAMPER KIT (TRANSTEC) 13mm High Piston	1	JF015E.PISKIT01
	# JF015E/CVT7 FWD PISTON & DAMPER KIT 13mm High Piston - AM	1	JF015E.PISKIT51

Sealing Ring & O-Ring Kits (000195)

REF	DESCRIPTION	QUANTITY	PART NO
	JF015E SEALING RING KIT (TRANSTEC)	1	JF015E.SRK01
	JF015E/RE0F11A SEALING RING KIT	1	JF015E.SRK51

Steel Plates (000140)

REF	DESCRIPTION	QUANTITY	PART NO
300	JF015E/RE0F11A STEEL LOW CLUTCH	2	JF015E.STP51
301	JF015E/RE0F11A STEEL REVERSE CLUTCH	5	JF015E.STP53
302	JF015E/RE0F11A STEEL FORWARD CLUTCH 2.0mm	5	JF015E.STP52

Transmission Tools N (000280)

REF	DESCRIPTION	QUANTITY	PART NO
	JF015E TRANSMISSION DIS/ASSEMBLE TOOLKIT	1	JF015E.TOOL01

Valve Body Parts (000262)

REF	DESCRIPTION	QUANTITY	PART NO
	Oversized Secondary Pulley/Pressure Regulator Valve Kit	1	JF015E.VA01
	Oversized Primary Pulley Regulator Valve Kit	1	JF015E.VA03
	Oversized Solenoid Regulator Valve Kit	1	JF015E.VA05
	Oversized Torque Converter Lube Regulator Valve Kit	1	JF015E.VA07

Sealing Rings & O-Rings (000190)

REF	DESCRIPTION	QUANTITY	PART NO
	JF015E/RE0F11A PUMP HOUSING O-RING	1	JF015E.OR51
	JF015E/RE0F11A PUMP HOUSING LOWER O-RING	1	JF015E.OR52
	JF015E/RE0F11A PUMP HOUSING HIGHER O-RING	1	JF015E.OR53
	JF015E INPUT SHAFT SEALING RING	1	JF015E.SSR01
	JF015E END CASE TO PULLEY SEALING RING (2 PER BOX)	2	JF015E.SSR02
	JF015E INPUT PULLEY SEALING RING	1	JF015E.SSR03
	JF015E OUTPUT PULLEY SEALING RING	1	JF015E.SSR04
	JF015E OUTPUT SHAFT OUTER SEALING RING (2 PER BOX)	2	JF015E.SSR05
	JF015E OUTPUT SHAFT INNER SEALING RING (2 PER BOX)	2	JF015E.SSR06
120	# JF015E INPUT SHAFT ORING	1	JF015E.OR01

Torque Converter Parts (000320)

REF	DESCRIPTION	QUANTITY	PART NO
	CONV. JF015E/RE0F11A O-RING	1	Z-NI-O-1V

Torque Converters N (000300)

REF	DESCRIPTION	QUANTITY	PART NO
	JF015E CONVERTER NISSAN JUKE 07C 07D CODES	1	JF015E.TC01
	JF015E CONVERTER NISSAN MICRA 07A/07E CODE	1	JF015E.TC02
	JF015E TORQUE CONVERTER NISSAN NOTE 1200cc 07N	1	JF015E.TC03
	NISSAN MICRA 2014> "07K"	1	JF015E.TC04

Valve Body N (000241)

REF	DESCRIPTION	QUANTITY	PART NO
750	# USED JUKE V/ BODY WITH PRESS. SWITCH	1	JF015E.VB01
750	*** N/L/A USE JF015E.VB01 *** V/BODY WITHOUT PRESSURE SWITCH	1	JF015E.VB02
750	#USED JF015E V/BODY WITH PRESS. SEN. FOR HIS SYSTEM	1	JF015E.VB03

Valve Body Tools N (000263)

REF	DESCRIPTION	QUANTITY	PART NO
	TOOL.FOR JF015E.VA01	1	JF015E.VA02
	TOOL FOR JF015E.VA03	1	JF015E.VA04
	TOOL.FOR JF015E.VA05	1	JF015E.VA06
	TOOL.FOR JF015E.VA07	1	JF015E.VA08