

MAZDA JATCO F3A

3 SPEED FWD (Hydraulic Control)



AUTOMATIC CHOICE



THE AUTOMATIC TRANSMISSION PARTS WAREHOUSE

A

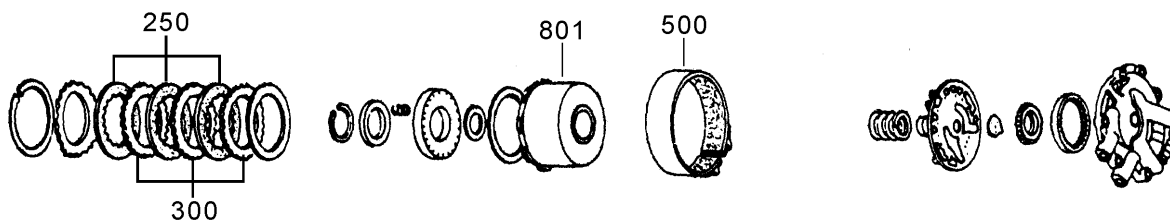

Pump and Direct Clutch

B

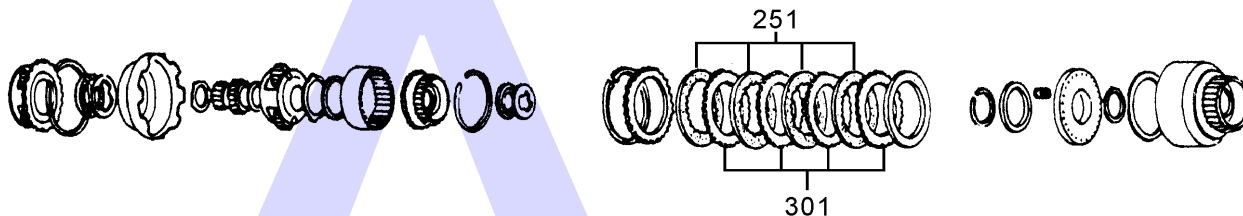

Forward Clutch and Planetary Sets

C



Low Reverse Brake

D

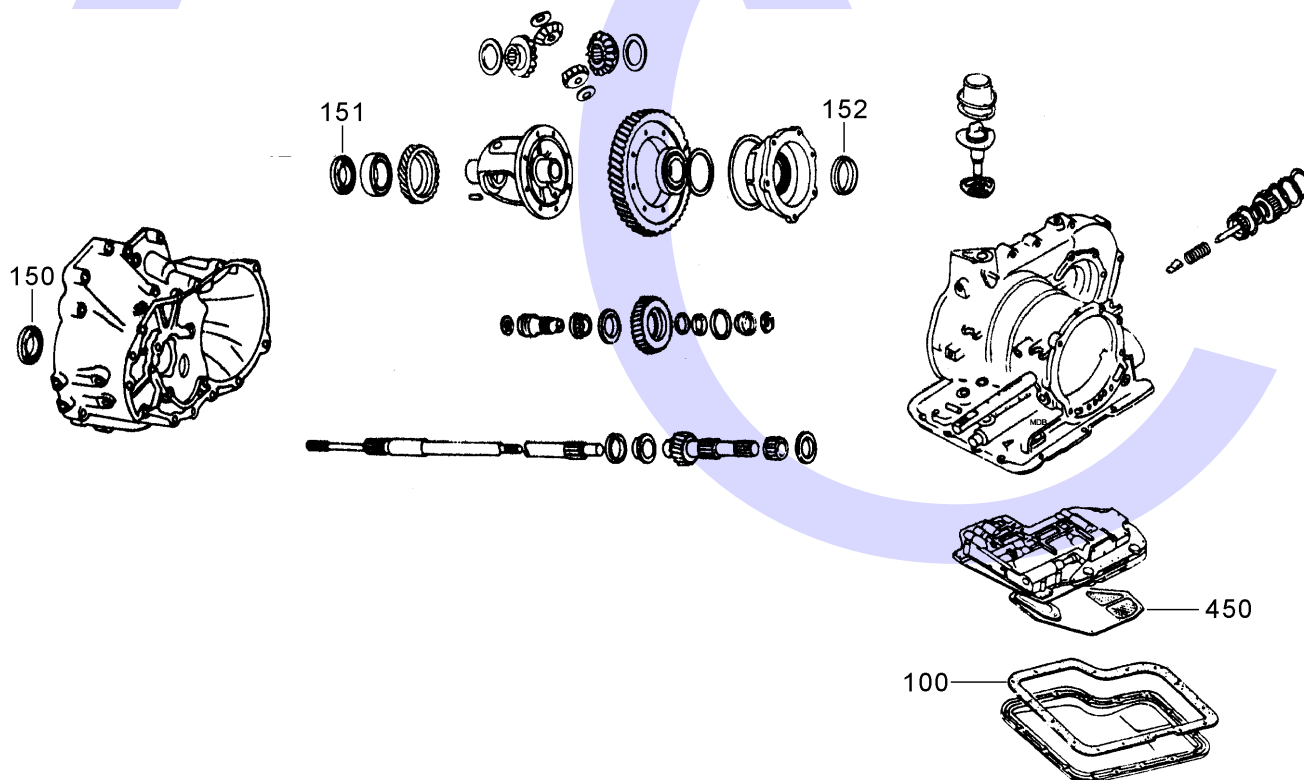

Case, Differential, Governor Etc.

MAZDA JATCO F3A

3 SPEED FWD (Hydraulic Control)



AUTOMATIC CHOICE



THE AUTOMATIC TRANSMISSION PARTS WAREHOUSE

ILL NO.	DESCRIPTION	YEARS	QTY	PART NO
KITS				
Kit	Overhaul Kit.....	81-ON	1	F3A.OHK01
Kit	Gasket & Rubber Kit.....	81-ON	1	F3A.GSK01
GASKETS				
100D	Pan Gasket Except Isuzu	81-ON	1	F3A.GAS01
NI	Pump Gasket.....	81-ON	1	F3A.GAS02
RUBBER COMPONENTS				
METAL CLAD SEALS				
150D	Converter Seal.....	81-ON	1	F3A.MCS01
151D	Axle Right Hand.....	81-ON	1	F3A.MCS02
152D	Axle Left Hand	81-ON	1	F3A.MCS02
MOULDED PISTONS				
SEALING RINGS				
FRICTION PLATES				
Kit	Friction Plate (Aftermarket).....	81-ON	1	F3A.FRK01
Kit	Friction Plate (Alto)	81-93	1	F3A.FRK51
Kit	Friction Plate (Alto)	94-97	1	F3A.FRK52
250A	Direct (116mm OD x 1.50mm x 44T) ..	81-ON	3	L3N.FRP01
251B	Forward (116mm OD x 1.50mm x 44T) ..	81-ON	4	L3N.FRP01
252C	Low & Reverse (147mm OD x 1.50mm x 62T ...	81-ON	3-5	F3A.FRP02
STEEL PLATES				
Kit	Steel Plate	81-ON	1	F3A.STK01
Kit	Steel Plate (Alto).....	81-93	1	F3A.STK51
Kit	Steel Plate (Alto).....	94-97	1	F3A.STK52
300A	Direct (91mm ID x 1.50mm x 28T)	81-ON	3	F3A.STP01
301B	Forward (91mm ID x 1.50mm x 28T)	81-ON	4	F3A.STP01
302C	Low & Reverse (106mm ID x 1.90mm x 13T)....	81-ON	3-5	F3A.STP02
PRESSURE PLATES				

ILL NO.	DESCRIPTION	YEARS	QTY	PART NO
SPRINGS & CIRCLIPS				
FILTERS				
450D	Filter Non Lock Up	81-87	1	F3A.FIL01
450D	Filter Mazda 323 Lock Up.....	87-ON	1	F3A.FIL02
450D	Filter (40mm Tube)	87-ON	1	F3A.FIL03
BANDS				
500A	Intermediate Band	81-ON	Alt	F3A.BAN01
BUSHINGS				
THRUST WASHERS & BEARINGS				
ELECTRICAL COMPONENTS				
VALVE BODY PARTS				
HARD PARTS				
801A	Direct Clutch Drum	81-ON	1	F3A.DRU02
SPECIAL ITEMS				
TOOLS & MANUALS				