

MERCEDES DB (1959-1971)

4 Speed RWD (Hydraulic Control)



AUTOMATIC CHOICE



THE AUTOMATIC TRANSMISSION PARTS WAREHOUSE

A

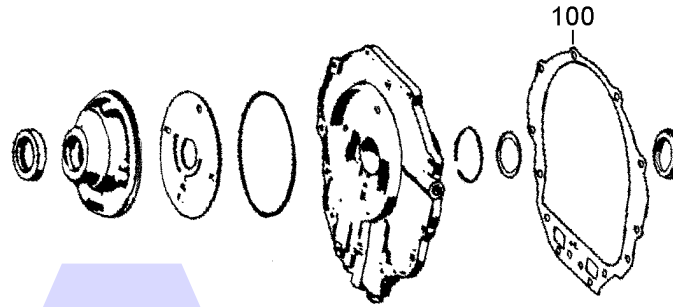

Pump Assembly

B

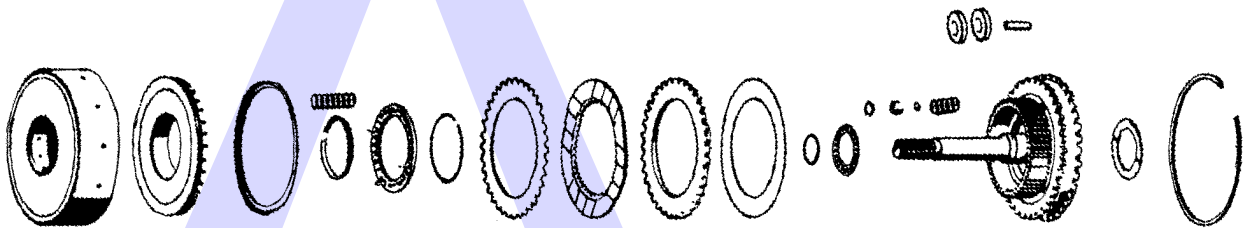

'K1' Clutch Assembly

Front Planetary Assembly

C

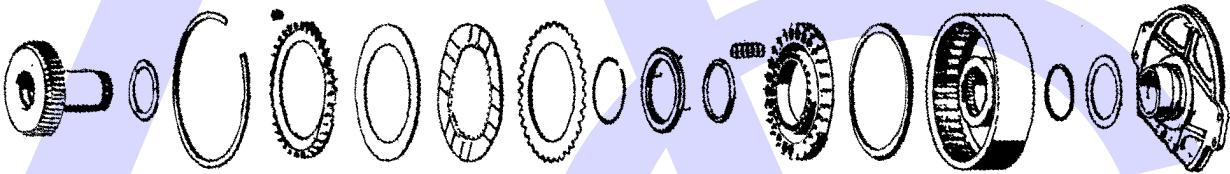

'K3' Clutch Assembly

D

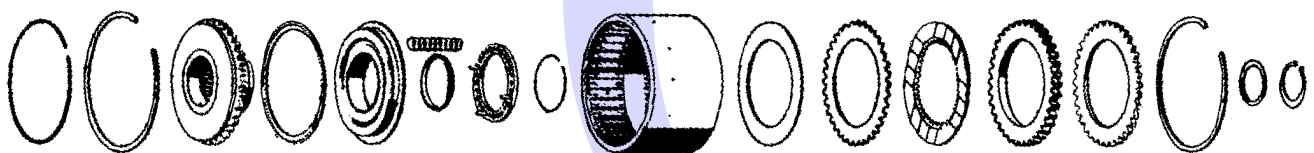

'K2' Clutch Assembly

E

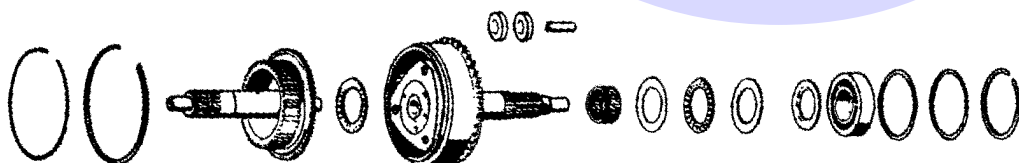

Rear Planetary Assembly & Output Shaft

MERCEDES DB (1959-1971)

4 Speed RWD (Hydraulic Control)



AUTOMATIC CHOICE



THE AUTOMATIC TRANSMISSION PARTS WAREHOUSE

F

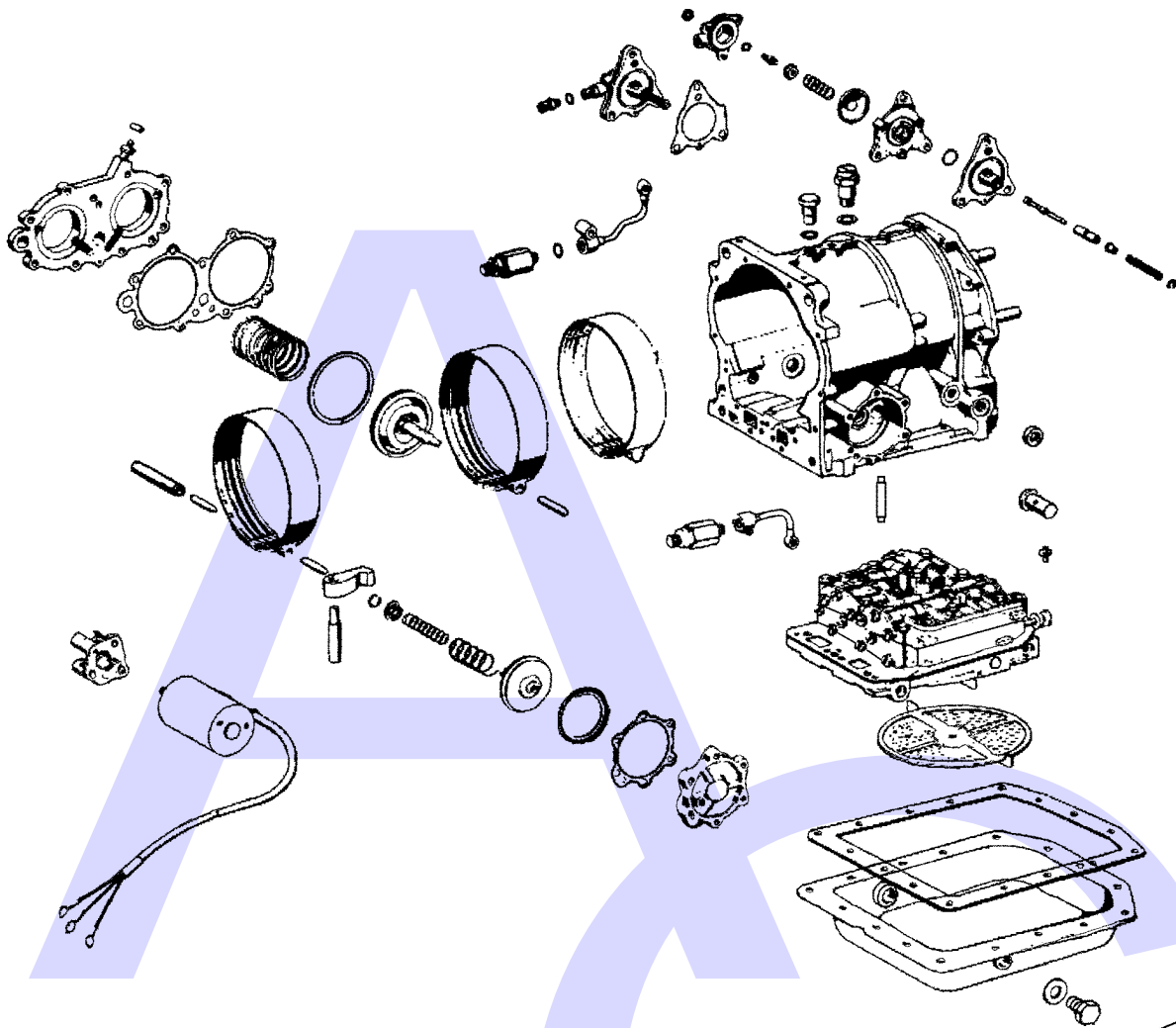

G

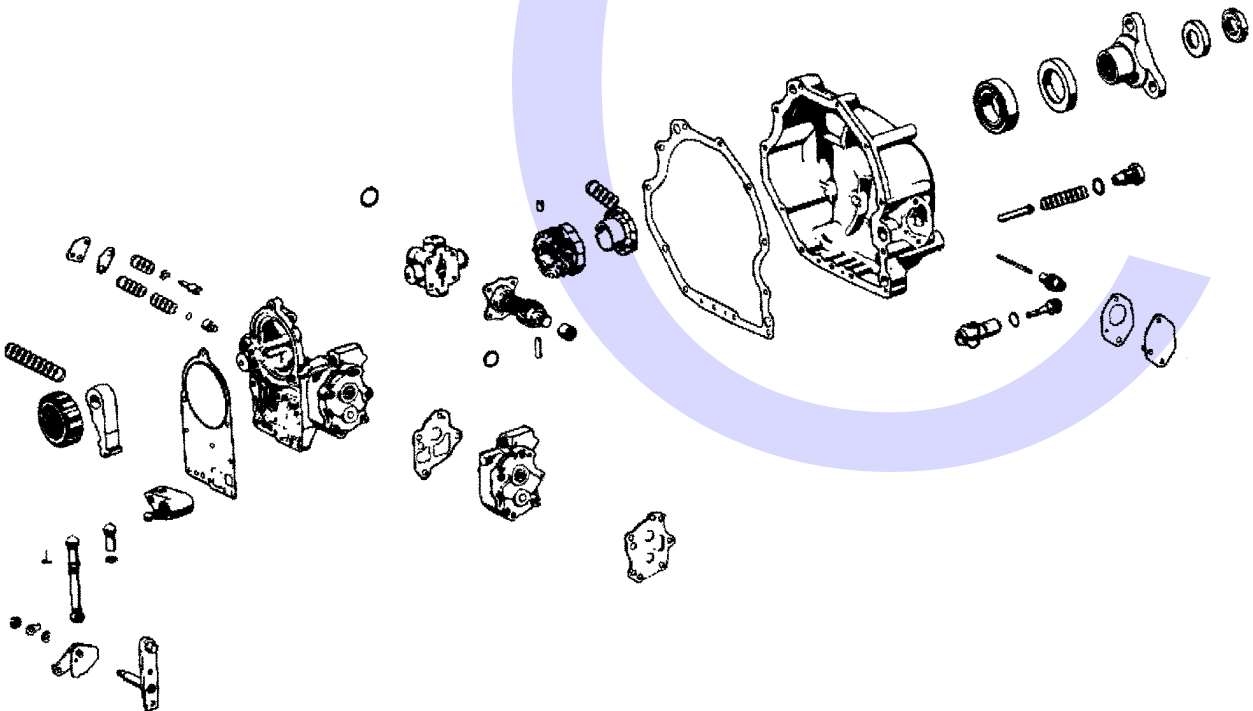

MERCEDES DB (1959-1971)

4 Speed RWD (Hydraulic Control)



AUTOMATIC CHOICE



THE AUTOMATIC TRANSMISSION PARTS WAREHOUSE

| ILL NO. | DESCRIPTION | YEARS | QTY | PART NO |
|---|---|-------|-----|---------------|
| KITS | | | | |
| Kit | Overhaul Kit (Pagode) (Solenoid on Bell Housing) | 59-70 | 1 | MERC108.OHK01 |
| GASKETS | | | | |
| 100A | Pump to Case | 59-71 | 1 | MERC108.GAS02 |
| 104F | Oil Pan | 59-71 | 1 | MERC108.GAS01 |
| RUBBER COMPONENTS | | | | |
| 120A | 'O' Ring Front Pump | 59-71 | 1 | MERC108.OR01 |
| METAL CLAD SEALS | | | | |
| 150A | Pump/Fluid Coupling | 59-71 | 1 | MERC108.MCS01 |
| 151F | Manual Shaft | 59-71 | 1 | MERC108.MCS03 |
| 152G | Extension Housing | 59-71 | 1 | MERC108.MCS02 |
| SEALING RINGS | | | | |
| FRICTION PLATES | | | | |
| 250B | 'K1' Clutch | 59-71 | 3 | MERC123.FRP02 |
| 251C | 'K3' Clutch | 59-71 | 2 | MERC123.FRP02 |
| 252D | 'K2' Clutch | 59-71 | 2 | MERC123.FRP02 |
| Check quantities as some units may differ | | | | |
| STEEL PLATES | | | | |
| 300B | 'K1' Clutch | 59-71 | 2 | MERC123.STP01 |
| 301C | 'K3' Clutch | 59-71 | 3 | MERC123.STP01 |
| 302D | 'K2' Clutch | 59-71 | 1 | MERC123.STP01 |
| Check quantities as some units may differ | | | | |
| PRESSURE PLATES | | | | |
| SPRINGS & CIRCLIPS | | | | |
| FILTERS | | | | |
| 450F | Pick Up Filter (All Merc) | 59-71 | 1 | MERC108.FIL01 |
| BANDS | | | | |
| 500F | 'B3' Reverse (Front) | 59-71 | 1 | MERC108.BAN01 |
| 501F | 'B1' (Middle) | 59-71 | 1 | MERC108.BAN02 |
| 502F | 'B2' (Rear) | 59-71 | 1 | MERC108.BAN03 |

| ILL NO. | DESCRIPTION | YEARS | QTY | PART NO |
|--------------------------------------|-------------|-------|-----|---------|
| BUSHINGS | | | | |
| THRUST WASHERS & BEARINGS | | | | |
| ELECTRICAL COMPONENTS | | | | |
| VALVE BODY PARTS | | | | |
| HARD PARTS | | | | |
| SPECIAL ITEMS | | | | |
| TOOLS & MANUALS | | | | |