

# Borg Warner Velvet Drive 70C, 71C, 72C, 73C



AUTOMATIC CHOICE



THE AUTOMATIC TRANSMISSION PARTS WAREHOUSE

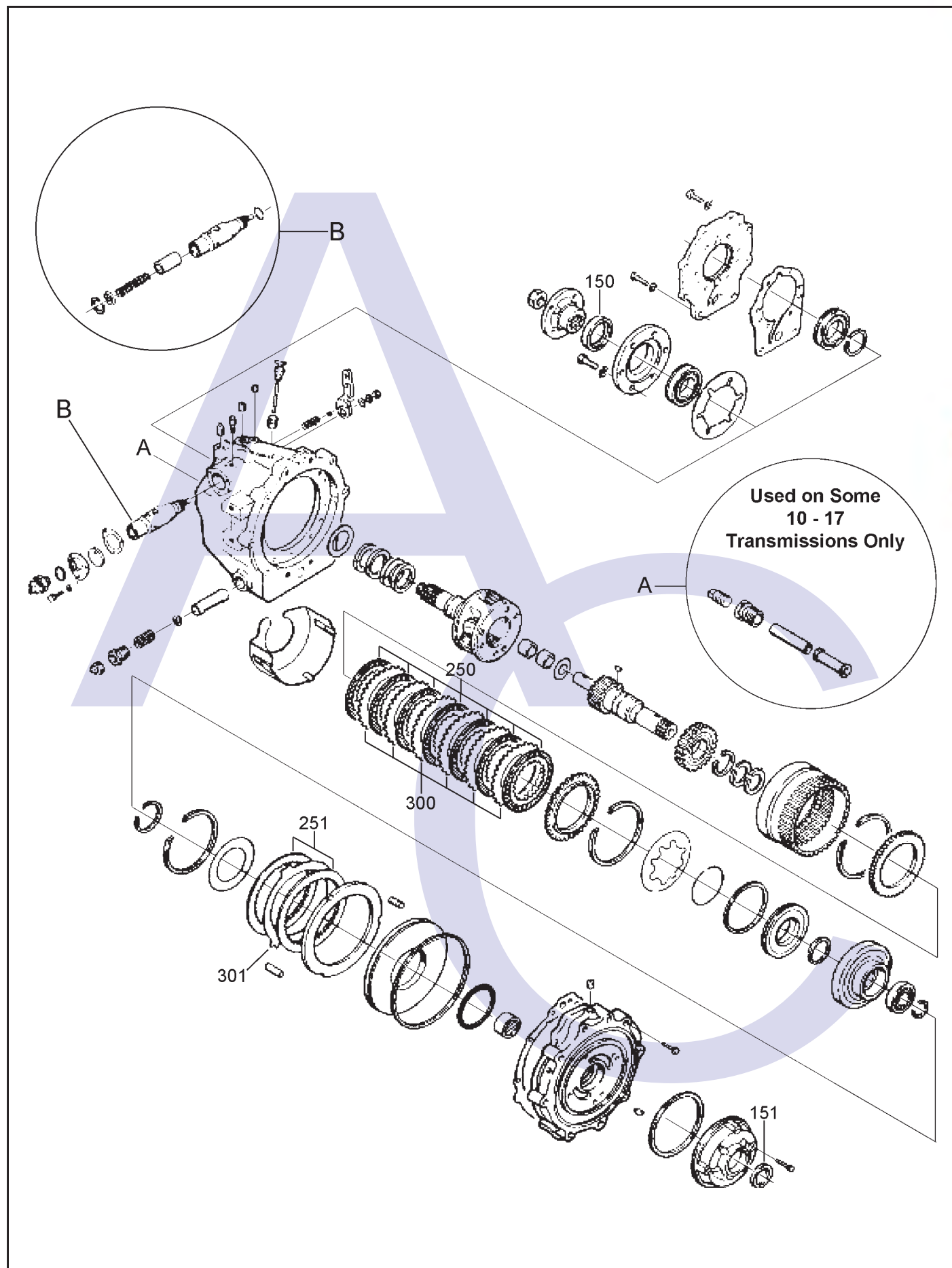

# Borg Warner Velvet Drive 70C, 71C, 72C, 73C



AUTOMATIC CHOICE



THE AUTOMATIC TRANSMISSION PARTS WAREHOUSE

| ILL NO.                       | DESCRIPTION   | YEARS | QTY | PART NO       |
|-------------------------------|---|-------|-----|---------------|
| <b>KITS</b>                   |   |       |     |               |
| Kit                           | Master Overhaul (71C/72C)..... All                          |       | 1   | MARINE.MOHK01 |
| Kit                           | Overhaul (70C, 71C, 72C) ..... All                          |       | 1   | MARINE.K01    |
| Kit                           | Overhaul (71C, 72C Transtec)..... All                       |       | 1   | MARINE.K02    |
| Kit                           | Overhaul (73C)..... All                                     |       | 1   | MARINE.OHK02  |
| <b>GASKETS</b>                |   |       |     |               |
| <b>RUBBER COMPONENTS</b>      |   |       |     |               |
| <b>METAL CLAD SEALS</b>       |   |       |     |               |
| 150                           | Seal, Rear<br>(1:1 Ratio 68mm OD)..... All                  |       | 1   | MARINE.MCS02  |
| 151                           | Seal, Pump (52mm OD)..... All                               |       | 1   | MARINE.MCS01  |
| NI                            | Seal, Reduction Unit ..... All                              |       | 1   | MARINE.MCS03  |
| <b>MOULDED PISTONS</b>        |   |       |     |               |
| <b>SEALING RINGS</b>          |   |       |     |               |
| <b>FRICTION PLATES</b>        |   |       |     |               |
| 250                           | Forward Clutch (Sintered)<br>(70C, 71C, 72C, 73C) ..... All |       | 5-7 | MARINE.FRP01  |
| 251                           | Reverse Brake (Sintered)<br>(70C, 71C, 72C, 73C) ..... All  |       | 1-3 | MARINE.FRP02  |
| <b>STEEL PLATES</b>           |   |       |     |               |
| 300                           | Forward Clutch<br>(70C, 71C, 72C, 73C) ..... All            |       | 4-6 | MARINE.STP01  |
| 301                           | Reverse Brake<br>(70C, 71C, 72C, 73C) ..... All             |       | 0-2 | MARINE.STP02  |
| <b>PRESSURE PLATES</b>        |   |       |     |               |
| <b>SPRINGS &amp; CIRCLIPS</b> |   |       |     |               |

| ILL NO.                              | DESCRIPTION | YEARS | QTY | PART NO |
|--------------------------------------|-------------|-------|-----|---------|
| <b>FILTERS</b>                       |             |       |     |         |
| <b>BUSHINGS</b>                      |             |       |     |         |
| <b>THRUST WASHERS &amp; BEARINGS</b> |             |       |     |         |
| <b>ELECTRICAL COMPONENTS</b>         |             |       |     |         |
| <b>VALVE BODY PARTS</b>              |             |       |     |         |
| <b>HARD PARTS</b>                    |             |       |     |         |
| <b>SPECIAL ITEMS</b>                 |             |       |     |         |
| <b>TOOLS &amp; MANUALS</b>           |             |       |     |         |