

# TF-80SC (AF40), TF-81SC (AF21) 6 Speed FWD (Electronic Control) (Peugeot, Citroen, Ford, Volvo, Mazda, Opel, Vauxhall, Saab, Cadillac, Fiat, Renault, Alfa & Land Rover)



AUTOMATIC CHOICE



THE AUTOMATIC TRANSMISSION PARTS WAREHOUSE

A

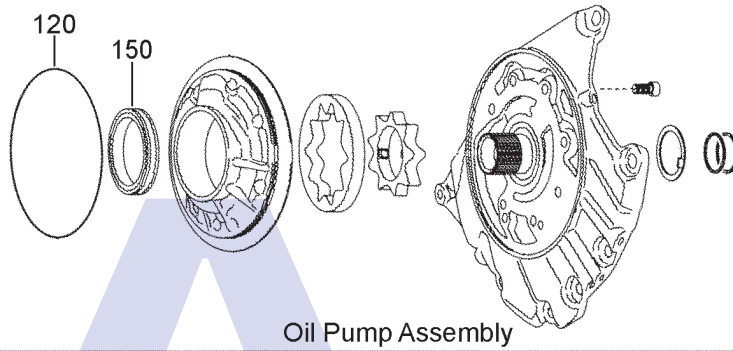

Oil Pump Assembly

B

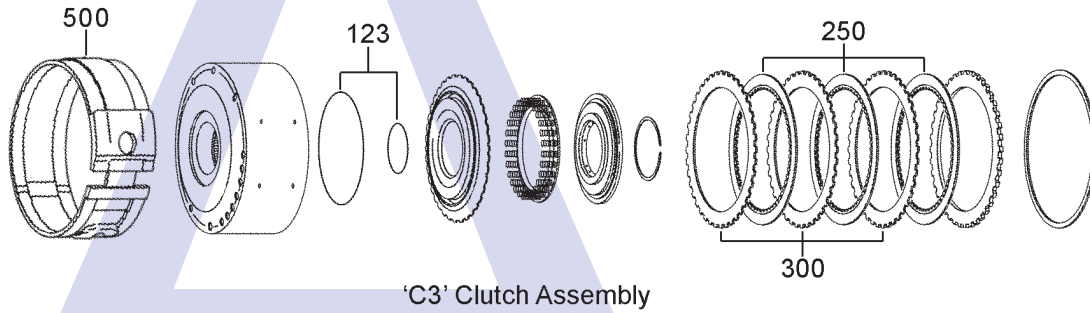

'C3' Clutch Assembly

C

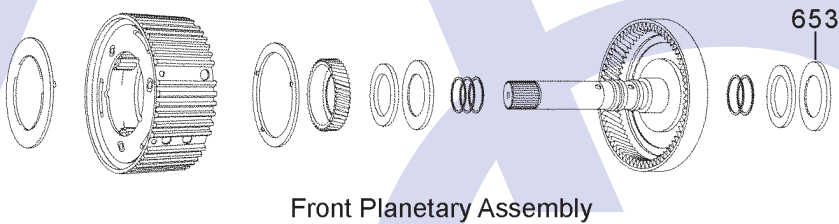

Front Planetary Assembly

D

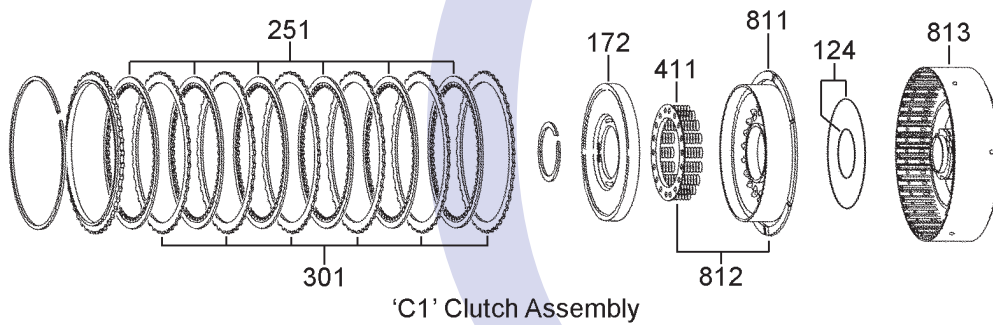

'C1' Clutch Assembly

E

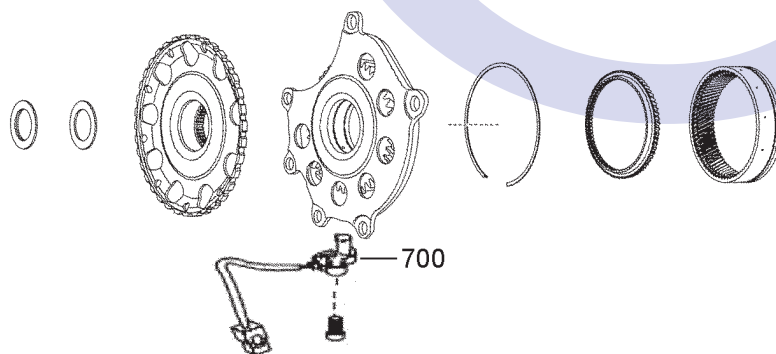

Counter Drive Gear Assembly

# TF-80SC (AF40), TF-81SC (AF21) 6 Speed FWD (Electronic Control)

(Peugeot, Citroen, Ford, Volvo, Mazda, Opel, Vauxhall, Saab, Cadillac, Fiat, Renault, Alfa & Land Rover)



AUTOMATIC CHOICE



THE AUTOMATIC TRANSMISSION PARTS WAREHOUSE

F

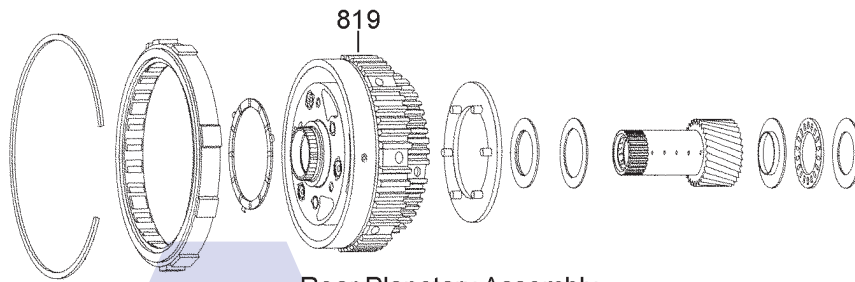

Rear Planetary Assembly

G

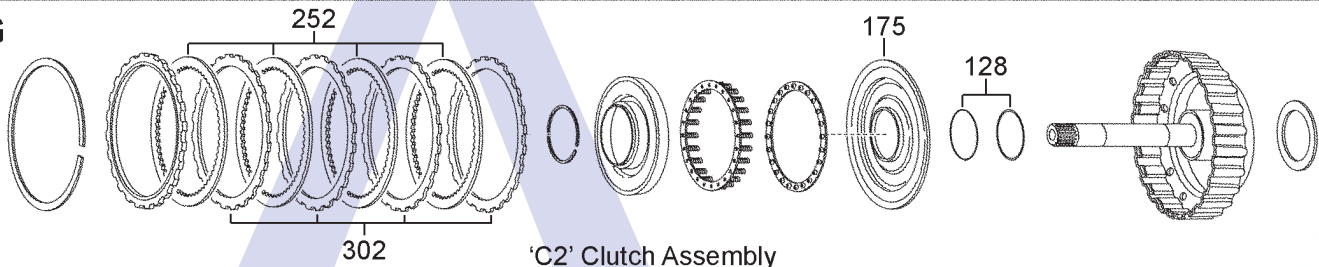

'C2' Clutch Assembly

H

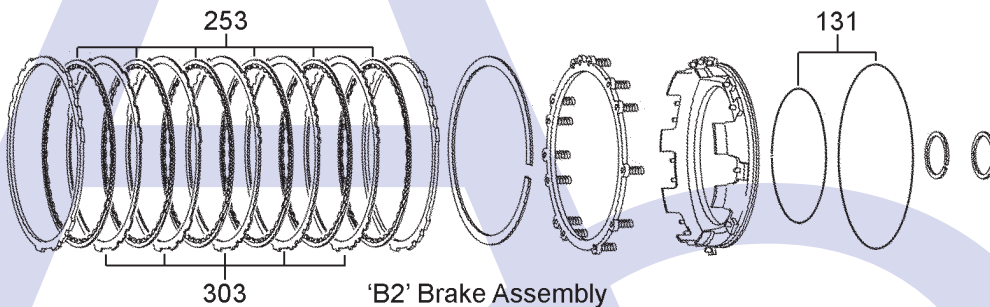

'B2' Brake Assembly

J

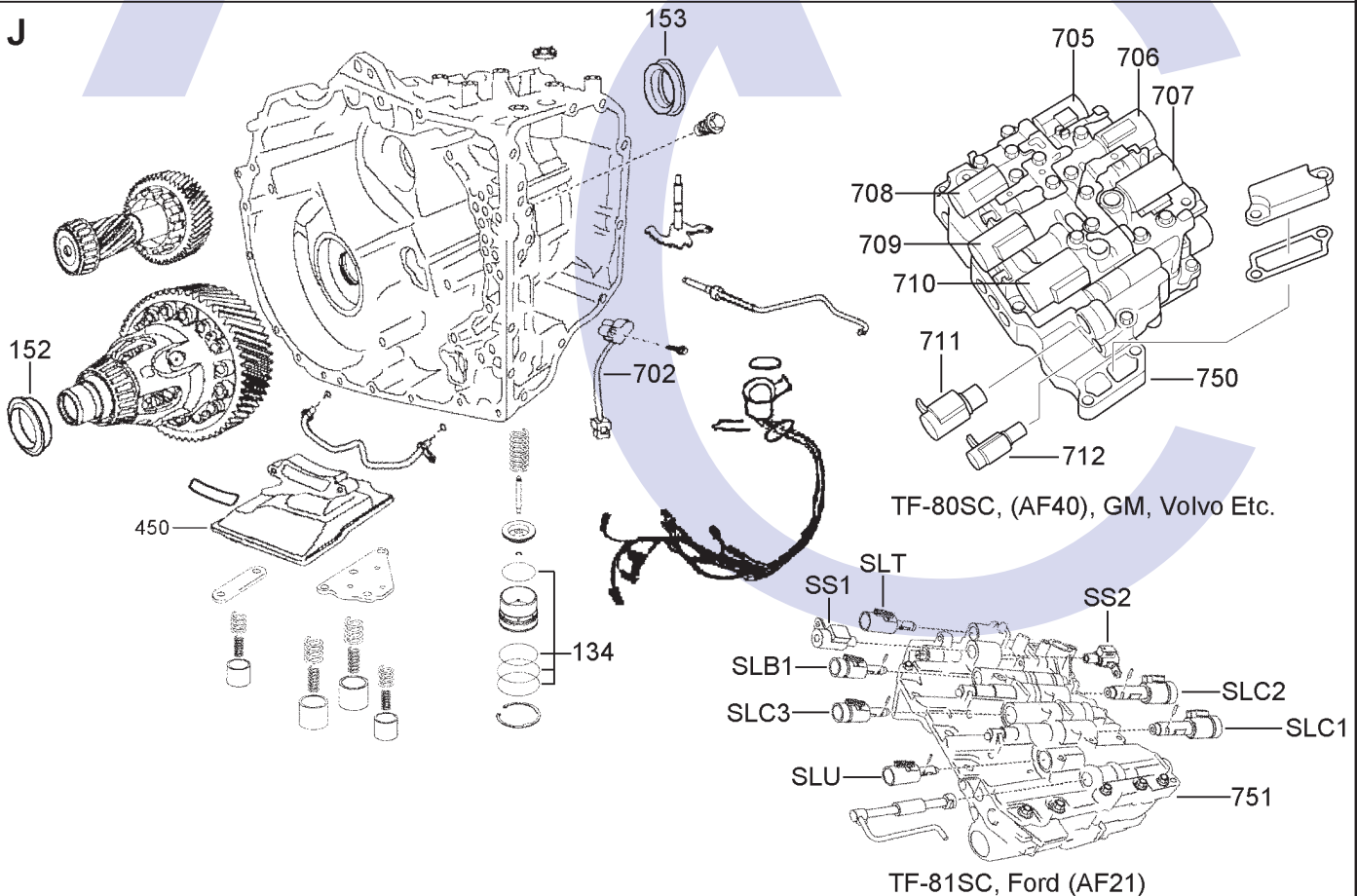

TF-80SC, (AF40), GM, Volvo Etc.

TF-81SC, Ford (AF21)

# TF-80SC (AF40), TF-81SC (AF21) 6 Speed FWD (Electronic Control)

(Peugeot, Citroen, Ford, Volvo, Mazda, Opel, Vauxhall, Saab, Cadillac, Fiat, Renault, Alfa & Land Rover)



AUTOMATIC CHOICE



THE AUTOMATIC TRANSMISSION PARTS WAREHOUSE

ILL NO.	DESCRIPTION	YEARS	QTY	PART NO
<b>KITS</b>				
Kit	Overhaul Kit TF80-SC Only (Transtec) (GM, Saab, Lancia, Fiat Vauxhall, Opel).....	05-ON	1	AF40.OHK01
Kit	Overhaul Kit TF-81SC, AF21(Transtec) 2005- Ford 500 & Mercury Montego 2006- Ford Fusion, Mercury Milan & Mazda 6 with 3.0Ltr Engines 2006- Lincoln MKZ/Zephyr 2007- Mazda CX-7 & CX-9 .....	05-ON	1	AF40.OHK02
Kit	Overhaul Kit (TF-80SC & TF-81SC) (Precision) (Volvo, Ford, Saab, Lancia, Fiat Peugeot †) (Without Pistons).....	05-ON	1	AF40.OHK51
Kit	Overhaul Kit (TF-80SC & TF-81SC) (Precision) (Volvo, Ford, Saab, Lancia, Fiat Peugeot †) (With Pistons).....	05-ON	1	AF40.OHK52
Kit	Overhaul Kit (TF-81SC, AF21) (Precision) (Without Pistons).....	05-ON	1	AF40.OHK53
Kit	Overhaul Kit (TF-81SC, AF21) (Precision) (With Pistons).....	05-ON	1	AF40.OHK54
Kit	Overhaul Kit AF40/TF80-SC (Transtec) (Volvo, Jaguar, Land Rover) .....	05-ON	1	AF40.OHK03
Kit	Valve Body Gasket Set (GM, Volvo).....	05-ON	1	AF40.GK01
† To service Citroen/Peugeot Units the Following Items will need to be ordered in Addition to the Overhaul Kit: 1xAF40.MCS07, 1xAF40.MCS08, 1xJF506E.OR03 and 1xJF506E.OR04.				
<b>GASKETS</b>				
NI	Valve Body Cover .....	05-ON	1	AF40.GAS01
NI	Valve Body Cover (Volvo 12 Hole) .....	05-ON	1	AF40.GAS02
<b>RUBBER COMPONENTS</b>				
120A	'O' Ring, Pump Outer.....	05-ON	1	4HP14.OR11
123B	'O' Ring Kit (Precision) 'C3' Clutch.....	05-ON	1	AF40.ORK02
124D	'O' Ring Kit (Transtec), 'C1' Clutch.....	05-ON	1	AF40.ORK01
124D	'O' Ring Kit (Precision), 'C1' Clutch.....	05-ON	1	AF40.ORK05
128G	'O' Ring Kit (Precision) 'C2' Clutch.....	05-ON	1	AF40.ORK04
131H	'O' Ring Kit (Precision) 'B2' Brake.....	05-ON	1	AF40.ORK06
134J	'O' Ring Kit (Precision) 'B1' Servo Assembly .....	05-ON	1	AF40.ORK03
NI	Drive Shaft 'O' Ring Left Hand (Freelander) .....	05-ON	1	AF40.OR02
<b>METAL CLAD SEALS</b>				
150A	Pump to Converter.....	05-ON	1	AF40.MCS01
152J	Drive Shaft Right Hand (Vauxhall, Opel, Saab).....	05-ON	1	AF40.MCS04
152J	Drive Shaft Right Hand (Citroen, Peugeot) (38.2mm x 55mm x 13.9mm) .....	05-ON	1	AF40.MCS08
152J	Drive Shaft Right Hand (Outer 75.2 x 62 x 8) (Freelander, Volvo 4WD).....	05-ON	1	AF40.MCS09
152J	Drive Shaft Right Hand (Inner) (Freelander 55.5 x 34 x 7mm) .....	05-ON	1	AF40.MCS10
152J	Drive Shaft Right Hand (Inner) (Volvo 4WD 45.5 x 34 x 6.8mm) .....	05-ON	1	AF40.MCS12

ILL NO.	DESCRIPTION	YEARS	QTY	PART NO
<b>METAL CLAD SEALS Cont...</b>				
152J	Drive Shaft Right Hand (Volvo) (38mm x 75mm x 10/13mm) .....	05-ON	1	AF40.MCS05
153J	Drive Shaft Left Hand (Vauxhall, Opel, Saab) .....	05-ON	1	AF40.MCS03
153J	Drive Shaft Left Hand (Citroen, Peugeot) (38.8mm x 63mm x 8.6mm) .....	05-ON	1	AF40.MCS07
153J	Drive Shaft Left Hand, Freelander/Jaguar (66.35 x 42 x 10.6) .....	05-ON	1	AF40.MCS11
153J	Drive Shaft Left Hand (Volvo 4WD 63 x 39 x 8.5 mm) .....	05-ON	1	AF40.MCS13
153J	Drive Shaft Left Hand (Volvo) (41mm x 66mm x 8.80mm) .....	05-ON	1	AF40.MCS06
<b>MOULDED PISTONS</b>				
172D	Damper Piston 'C1' Clutch .....	05-ON	1	AF40.PIS01
175G	Piston 'C2' Clutch (Precision).....	05-ON	1	AF40.PIS05
<b>SEALING RINGS</b>				
Kit	Sealing Ring Kit (Transtec) .....	05-ON	1	AF40.SRK01
Kit	Sealing Ring Kit (Precision) .....	05-ON	1	AF40.SRK03
<b>FRICTION PLATES</b>				
Kit	Friction Plate (AM) .....	05-ON	1	AF40.FRK01
Kit	Friction Plate (Alto) AF40 .....	05-ON	1	AF40.FRK51
Kit	Friction Plate (AM) 6 Cylinder .....	05-ON	1	AF40.FRK02
Kit	Friction Plate (Alto) 6 Cylinder .....	05-ON	1	AF40.FRK52
250B	'C3' Clutch (Reverse, 3rd & 5th) (166mm OD x 1.70mm x 54T) .....	05-ON	4	AF40.FRP03
250B	'C3' Clutch (Reverse, 3rd & 5th) (Alto) (166mm OD x 1.70mm x 54T) .....	05-ON	4	AF40.FRP53
251D	'C1' Clutch (1st, 2nd, 3rd, 4th) (157mm OD x 1.70mm x 54T) .....	05-ON	7	AF40.FRP01
251D	'C1' Clutch (1st, 2nd, 3rd, 4th) (Alto) (157mm OD x 1.70mm x 54T) .....	05-ON	7	AF40.FRP51
251D	'C1' Clutch (1st, 2nd, 3rd, 4th) (Alto Selective) (157mm OD x 1.50mm x 54T) .....	05-ON	AR	AF40.FRP55
252G	'C2' Clutch (4th, 5th, 6th) (160mm OD x 1.70mm x 55T) .....	05-ON	4	AF40.FRP02
252G	'C2' Clutch (4th, 5th, 6th) (Alto) (160mm OD x 1.70mm x 55T) .....	05-ON	4	AF40.FRP52
253H	'B2' Brake (1st, Reverse) (185mm OD x 1.70mm x 60T) .....	05-ON	7	AF40.FRP04
253H	'B2' Brake (1st, Reverse) (Alto) (185mm OD x 1.70mm x 60T) .....	05-ON	7	AF40.FRP54
<b>STEEL PLATES</b>				
Kit	Steel Plate AF40-6 .....	05-ON	1	AF40.STK01
300B	'C3' Clutch (Reverse, 3rd & 5th) (141mm ID x 2.31mm x 36T) .....	05-ON	4	AF40.STP03
301D	'C1' Clutch (1st, 2nd, 3rd, 4th) (141mm ID x 1.80mm x 40T) .....	05-ON	7	AF40.STP01
302G	'C2' Clutch (4th, 5th, 6th) (143mm ID x 1.80mm x 36T) .....	05-ON	4	AF40.STP02
303H	'B2' Brake (1st, Reverse) (173mm ID x 1.70mm x 14T) .....	05-ON	7	AF40.STP04
<b>PRESSURE PLATES</b>				



# TF-80SC (AF40), TF-81SC (AF21) 6 Speed FWD (Electronic Control)

(Peugeot, Citroen, Ford, Volvo, Mazda, Opel, Vauxhall, Saab, Cadillac, Fiat, Renault, Alfa & Land Rover)



AUTOMATIC CHOICE



THE AUTOMATIC TRANSMISSION PARTS WAREHOUSE

ILL NO.	DESCRIPTION	YEARS	QTY	PART NO
<b>SPRINGS &amp; CIRCLIPS</b>				
411D	Spring Assy, 'C1' Clutch Piston . 05-ON	1		<b>AF40.SPR01</b>
<b>FILTERS</b>				
450J	Pick-Up Filter .....	05-ON	1	<b>AF40.FIL01</b>
<b>BANDS</b>				
500B	'B1' Brake Band (New Aftermarket) .....	05-ON	1	<b>AF40.BAN01</b>
<b>BUSHINGS</b>				
Kit	Bushing Kit, (6 Pieces) (Volvo, Ford) .....	05-ON	1	<b>AF40.BK01</b>
NI	Solenoid Bush.....	05-ON	AR	<b>09G.BUS03</b>
NI	Bushing Kit Installer Tool.....	05-ON	1	<b>AF40.TOOL04</b>
<b>THRUST WASHERS &amp; BEARINGS</b>				
653C	Thrust Race, 'C1' Clutch (0.85mm Late Style) This race fits the late style clutch that has a smooth face without castellations. When updating from old style castellated drums this thrust race must also be replaced .....	05-ON	1	<b>AF40.THW01</b>
<b>ELECTRICAL COMPONENTS</b>				
700E	Speed Sensor, Output (Volvo) ..	05-ON	1	<b>AF40.ELE04</b>
702J	Speed Sensor, Input (Volvo) .....	05-ON	1	<b>AF40.ELE03</b>
702J	Speed Sensor, Input Mondeo ... (White Connector).....	05-ON	1	<b>AF40.ELE01</b>
705J	Solenoid, SLU Early Type (TF-80SC) No. on sol 13BR7F00823.....	05-ON	1	<b>AF40.SOL02</b>
705J	Solenoid, SLU Late Type (TF-80SC) .....	05-ON	1	<b>AF40.SOL08</b>
706J	Solenoid, SLC3 (TF-80SC) .....	05-ON	1	<b>AF40.SOL05</b>
707J	Solenoid, SLB1 Early Type (TF-80SC) No. on sol 14BP7B02208.....	05-ON	1	<b>AF40.SOL06</b>
707J	Solenoid, SLB1 Late Type (TF-80SC) .....	05-ON	1	<b>AF40.SOL07</b>
708J	Solenoid, SLC1 (TF-80SC) .....	05-ON	1	<b>AF40.SOL03</b>
709J	Solenoid, SLC2 (TF-80SC) .....	05-ON	1	<b>AF40.SOL04</b>
710J	Solenoid, SLT (TF-80SC).....	05-ON	1	<b>AF40.SOL06</b>
711J	Solenoid, SS2 (TF-80SC) (3 Way Type).....	05-ON	1	<b>AF40.SOL01</b>
712J	Solenoid, SS1 (TF-80SC) (3 Way Type).....	05-ON	1	<b>AF40.SOL01</b>
<b>VALVE BODY PARTS</b>				
750J	Valve Body (Vauxhall/Opel, Modified) .....	05-ON	1	<b>AF40.VB01</b>
750J	Valve Body (TF-80SC New OEM) (Opel, Saab, Volvo, Land Rover) .	05-ON	1	<b>AF40.VB02</b>
750J	Valve Body (TF-80SC Gen 2 OEM) (Ford, Volvo, <a href="#">Click for Application</a> ) 11-ON	11-ON	1	<b>AF40.VB09</b>
750J	AF40-6 II Valve Body (OEM New) .....	09-ON	1	<b>AF40.VB08</b>
751J	Valve Body (TF-81SC New OEM) (Ford, Volvo, L.Rover, Jaguar) ..	06-ON	1	<b>AF40.VB06</b>
Kit	C1/K1 Clutch Control Valve (Requires Tool AF40.VA02 & Fixture AG4.VA05) (Sonnax® <a href="#">Click here for Info</a> ) ...	05-ON	1	<b>AF40.VA01</b>
Kit	Tool Kit for AF40.VA01 .....	05-ON	1	<b>AF40.VA02</b>
Kit	C2 Clutch Control Valve (Requires Tool AF40.VA04 & Fixture AG4.VA05) (Sonnax® <a href="#">Click here for Info</a> ) ...	05-ON	1	<b>AF40.VA03</b>
Kit	Tool Kit for AF40.VA03 & VA05 .	05-ON	1	<b>AF40.VA04</b>

ILL NO.	DESCRIPTION	YEARS	QTY	PART NO
<b>VALVE BODY PARTS Cont...</b>				
Kit	C3 Clutch Control Valve (Requires Tool AF40.VA04 & Fixture AG4.VA05 (Sonnax® <a href="#">Click here for Info</a> ) ...	05-ON	1	<b>AF40.VA05</b>
Kit	B1 Control Valve (Requires Tool AF40.VA07 & Fixture AG4.VA05) (Sonnax® <a href="#">Click here for Info</a> ) ...	05-ON	1	<b>AF40.VA06</b>
Kit	Tool Kit for AF40.VA06 .....	05-ON	1	<b>AF40.VA07</b>
Kit	Main Pressure Regulator & Boost Assy (Requires Tool AF40.VA09 & Fixture AG4.VA05) (Sonnax® <a href="#">Click here for Info</a> ) ...	05-ON	1	<b>AF40.VA08</b>
Kit	Tool Kit for AF40.VA08 .....	05-ON	1	<b>AF40.VA09</b>
Kit	Lock Up Clutch Control Valve (Requires Tool AF40.VA11 & Fixture AG4.VA05 & Tool AF40.VA17) (Sonnax® <a href="#">Click here for Info</a> ) ...	05-ON	1	<b>AF40.VA10</b>
Kit	Tool Kit for AF40.VA10 .....	05-ON	1	<b>AF40.VA11</b>
NI	Replacement Reamer for AF40.VA11		AR	<b>AF40.VA22</b>
NI	Adaptor Plate for Fixture AG4.VA05 (Use for Installing AF40.VA10) ..	05-ON	AR	<b>AF40.VA17</b>
Kit	Second Regulator Valve (Requires Tool AF40.VA14 & Fixture AG4.VA05) (Sonnax® <a href="#">Click here for Info</a> ) ...	05-ON	1	<b>AF40.VA13</b>
Kit	Tool Kit for AF40.VA13 .....	05-ON	1	<b>AF40.VA14</b>
Kit	Solenoid Modulator Valve (Requires Tool AF40.VA16 & Fixture AG4.VA05) (Sonnax® <a href="#">Click here for Info</a> ) ...	05-ON	1	<b>AF40.VA15</b>
Kit	Tool Kit for AF40.VA15 .....	05-ON	1	<b>AF40.VA16</b>
Kit	9mm Valve Body End Plug Kit (5 Plugs & 7 'O' Rings) (Sonnax® <a href="#">Click here for Info</a> ) ...	05-ON	AR	<b>AF40.PLU01</b>
Kit	11mm Valve Body End Plug Kit (5 Plugs & 7 'O' Rings) (Sonnax® <a href="#">Click here for Info</a> ) ...	05-ON	AR	<b>AF40.PLU02</b>
NI	Clutch, Band & Line Accumulator Piston (Sonnax® <a href="#">Click here for Info</a> ) ...	05-ON	5	<b>AF40.VA12</b>
NI	Universal Valve Body Fixture (Sonnax® <a href="#">Click here for Info</a> ) ...	05-ON	AR	<b>AG4.VA05</b>
Kit	Accumulator Piston & Sleeve (Sonnax® <a href="#">Click here for Info</a> ) ...	05-ON	AR	<b>AF40.VA20</b>
Kit	Solenoid Modulator Accumulator Piston Kit (TF-81SC Only) (Sonnax® <a href="#">Click here for Info</a> ) ...	05-ON	AR	<b>AF40.VA21</b>
Kit	Spring Adjuster Kit (Sonnax® <a href="#">Click here for Info</a> ) ...	03-ON	1	<b>09G.VA16</b>
Kit	Oversized Two-Spool Relay/Signal Valve (Requires Tool 01J.VA02 & Fixture AG4.VA05) (Sonnax® <a href="#">Click here for Info</a> ) ...	03-ON	1	<b>09G.VA17</b>
Kit	Tool Kit for 09G.VA17 .....	03-ON	1	<b>01J.VA02</b>
Kit	Oversized Three-Spool Relay/Control/Switch Valve (Requires Tool 01J.VA02 & Fixture AG4.VA05) (Sonnax® <a href="#">Click here for Info</a> ) ...	03-ON	1	<b>AF40.VA23</b>
Kit	Tool Kit for AF40.VA23 .....	03-ON	1	<b>01J.VA02</b>
Kit	Lockup Clutch Control Plunger Valve (Sonnax® <a href="#">Click here for Info</a> ) ...	03-ON	1	<b>AF40.VA25</b>
Kit	Boost Valve Kit (Sonnax® <a href="#">Click here for Info</a> ) ...	03-ON	1	<b>AF40.VA26</b>
NI	Solenoid Wire Connector Retainer (Sonnax® <a href="#">Click here for Info</a> ) ...	05-ON	AR	<b>5550.RET01</b>

[Click here for complete TF-80SC Sonnax® Valve Body Diagram](#)

[Click here for complete TF-81SC Sonnax® Valve Body Diagram](#)

# TF-80SC (AF40), TF-81SC (AF21) 6 Speed FWD (Electronic Control) (Peugeot, Citroen, Ford, Volvo, Mazda, Opel, Vauxhall, Saab, Cadillac, Fiat, Renault, Alfa & Land Rover)



AUTOMATIC CHOICE



THE AUTOMATIC TRANSMISSION PARTS WAREHOUSE

ILL NO.	DESCRIPTION	YEARS	QTY	PART NO
<b>HARD PARTS</b>				
811D	Piston, 'C1' Clutch (Steel) .....	05-ON	1	<b>AF40.PIS06</b>
812D	Piston & Retaining Spring Assy (Steel 'C1' Clutch) .....	05-ON	1	<b>AF40.PIS07</b>
813D	'C1' Clutch Drum New (With Needle Bearing).....	05-ON	1	<b>AF40.DRU10</b>
813D	'C1' Clutch Drum New (7 Plate With Piston, No Fric)....	05-ON	1	<b>AF40.DRU05</b>
813D	'C1' Clutch Drum Exchange (Modified 7 Plate).....	05-ON	1	<b>AF40.DRU02</b>
813D	'C1' Clutch Drum Exchange (6 Plate W.Slots by Bearing).....	05-ON	1	<b>AF40.DRU03</b>
813D	'C1' Clutch Drum Exchange (6 Plate W/O Slots by Bearing) .	05-ON	1	<b>AF40.DRU04</b>
813D	'C1' Clutch Drum (With Circlip Repair).....	05-ON	1	<b>AF40.DRU31</b>
819F	Planetary Assy, Rear.....	05-ON	1	<b>AF40.PLK03</b>
NI	Shaft, Transmission to Transfer (Volvo 4x4) .....	05-ON	1	<b>AF40.SH01</b>
<b>SPECIAL ITEMS</b>				
NI	Solenoid Wire Connector Retainer (Sonnax® <a href="#">Click here for Info</a> ) ...	05-ON	AR	<b>5550.RET01</b>
<b>TOOLS &amp; MANUALS</b>				
NI	Bushing Kit Installer Tool.....	05-ON	1	<b>AF40.TOOL04</b>
<a href="#">Click here to view special tools for this transmission</a>				

ILL NO.	DESCRIPTION	YEARS	QTY	PART NO