

# TOYOTA A750E/F (Toyota 4Runner, Land Cruiser, Tacoma, Sequoia & Tundra 2003-Up) 5 SPEED RWD (Electronic Control)



AUTOMATIC CHOICE



THE AUTOMATIC TRANSMISSION PARTS WAREHOUSE

**A**

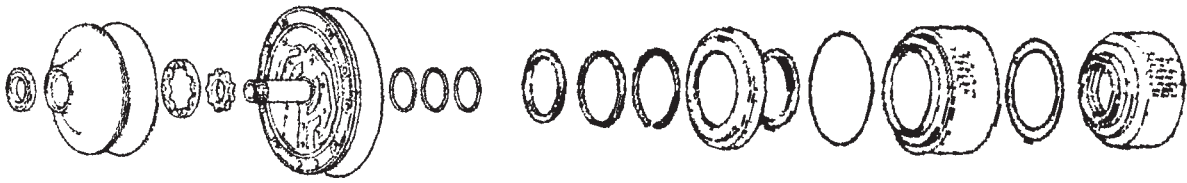

Oil Pump

**B**



'C2' (Direct) Clutch

'C3' (Reverse) Clutch

**C**

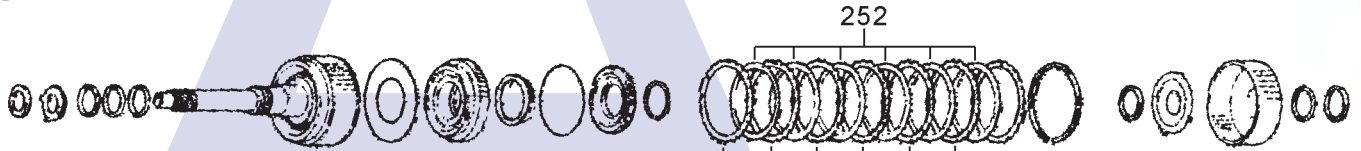

'C1' (Forward) Clutch

**D**

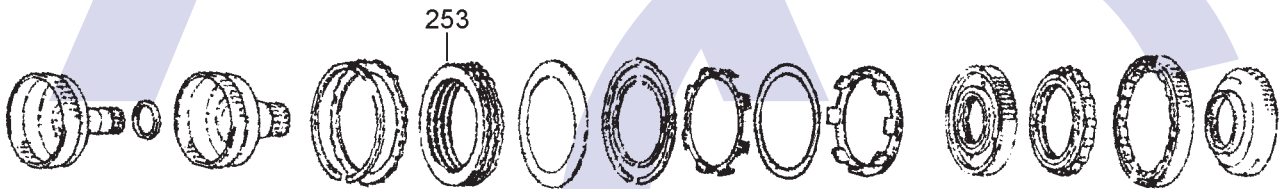

'B3' Brake

'F2' OWC 'F1' OWC

**E**



'B1' Brake

'B2' Brake

**F**

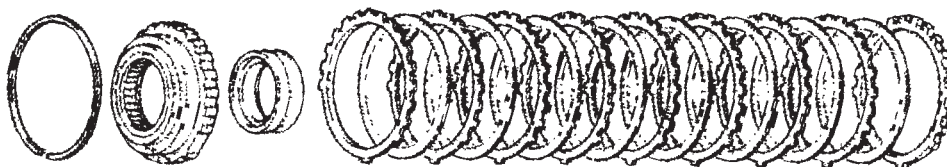

'F3' OWC

'B4' (1st & Reverse) Brake

# TOYOTA A750E/F (Toyota 4Runner, Land Cruiser, Tacoma, Sequoia & Tundra 2003-Up) 5 SPEED RWD (Electronic Control)



AUTOMATIC CHOICE



THE AUTOMATIC TRANSMISSION PARTS WAREHOUSE

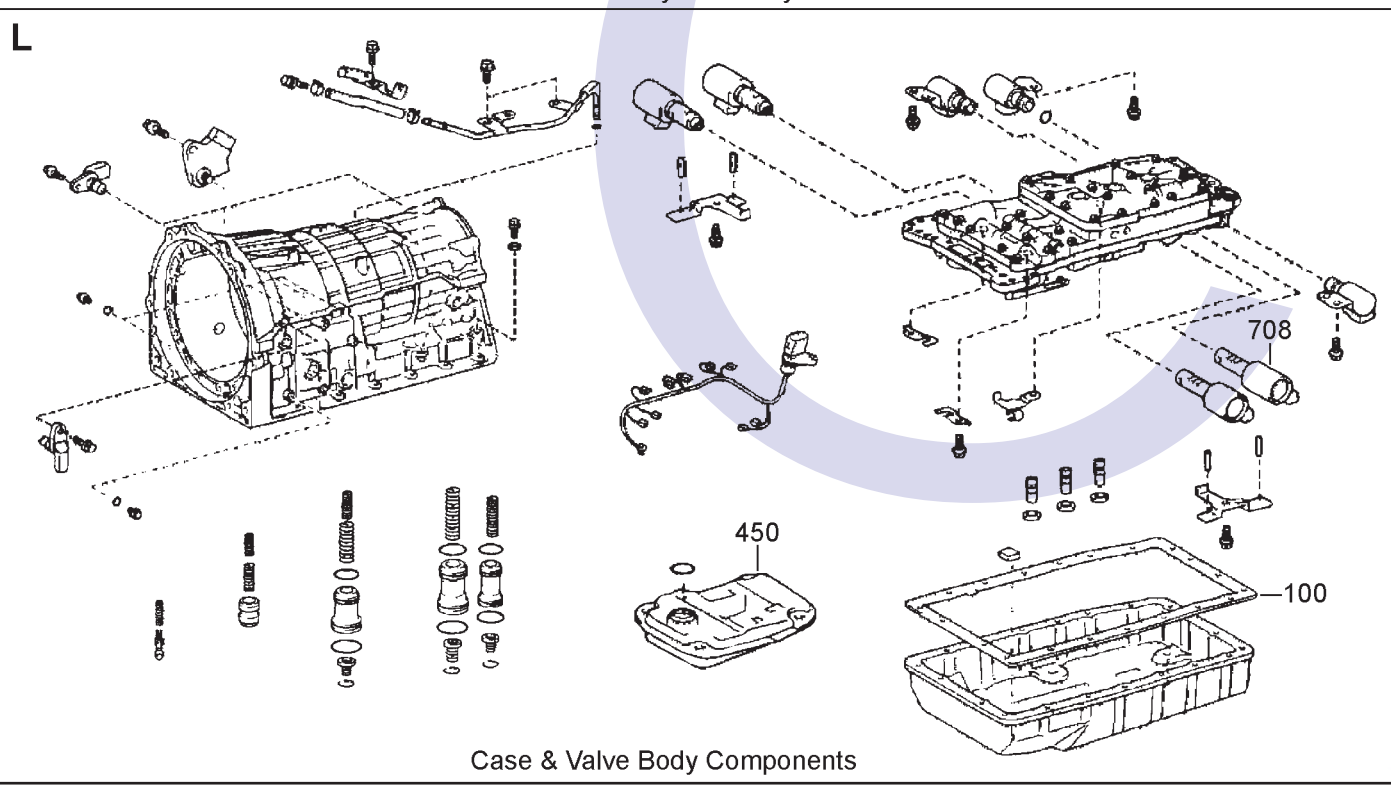
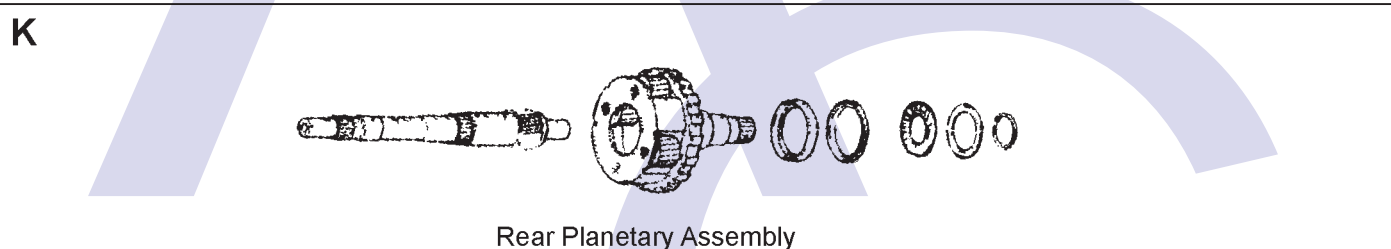
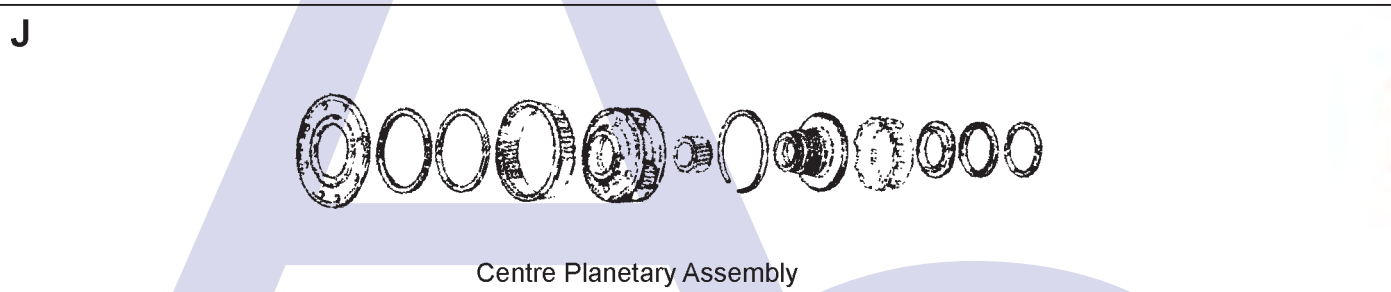
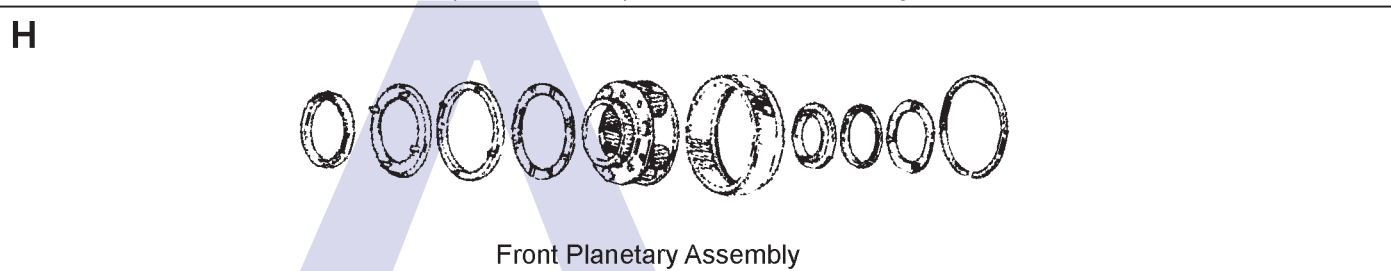
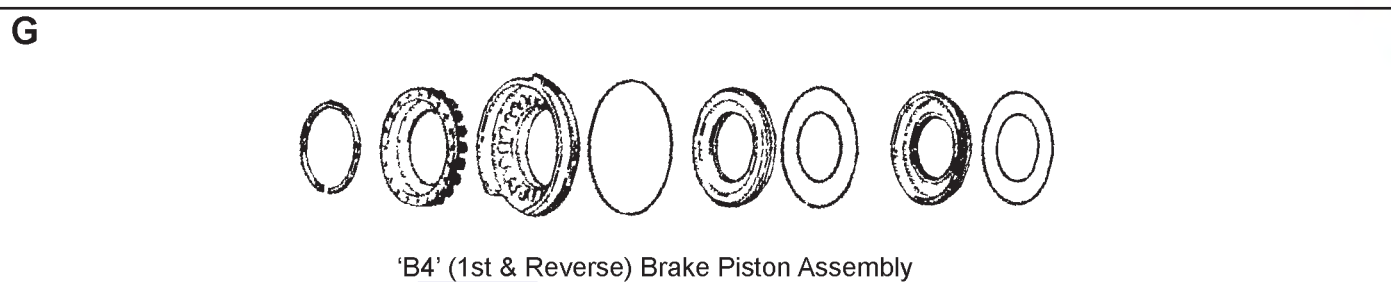

# TOYOTA A750E/F (Toyota 4Runner, Land Cruiser, Tacoma, Sequoia & Tundra 2003-Up) 5 SPEED RWD (Electronic Control)



AUTOMATIC CHOICE



THE AUTOMATIC TRANSMISSION PARTS WAREHOUSE

ILL NO.	DESCRIPTION	YEARS	QTY	PART NO
<b>KITS</b>				
Kit	Overhaul Kit (Transtec) (Land Cruiser).....	03-ON	1	A750.OHK01
Kit	Overhaul Kit (Precision) (Land Cruiser W/O Pistons) .....	03-ON	1	A750.OHK51
Kit	Banner Kit (Precision) (Includes Frictions).....	03-ON	1	A750.BAK51
<b>GASKETS</b>				
100L	Pan Gasket .....	03-ON	1	A750.GAS01
<b>RUBBER COMPONENTS</b>				
<b>METAL CLAD SEALS</b>				
<b>MOULDED PISTONS</b>				
<b>SEALING RINGS</b>				
<b>FRICTION PLATES</b>				
Kit	Friction Plate Kit (Alto) .....	03-ON	1	A750.FRK51
Kit	Friction Plate Kit (Alto) High Performance .....	03-ON	1	A750.FRK61
252C	'C1' Clutch (Alto) (119.7mm OD x 1.90mm x 30T)	03-ON	6	A750.FRP01
253D	'B3' Brake (Narrow Teeth) (164mm OD x 1.88mm x 40T) ..	03-ON	4	A750.FRP07
<b>STEEL PLATES</b>				
Kit	Steel Plate Kit .....	03-ON	1	A750.STK01
Kit	Steel Plate Kit (Alto) High Performance .....	03-ON	1	A750.STK61
303C	'C1' Clutch (106mm ID x 1.8mm x 24T) .....	03-ON	6	A750.STP01
<b>PRESSURE PLATES</b>				
<b>SPRINGS &amp; CIRCLIPS</b>				

ILL NO.	DESCRIPTION	YEARS	QTY	PART NO
<b>FILTERS</b>				
450L	Pick Up Filter.....	03-ON	1	A750.FIL01
<b>BANDS</b>				
<b>BUSHINGS</b>				
NI	Bush, Pump to Converter.....	03-ON	1	62TE.BUS01
<b>THRUST WASHERS &amp; BEARINGS</b>				
<b>ELECTRICAL COMPONENTS</b>				
708L	Solenoid (SLU, Lock Up Control) (Toyota Tacoma, Lexus LX470) .....	03-ON	1	A750.SOL01
<b>VALVE BODY PARTS</b>				
<b>HARD PARTS</b>				
<b>SPECIAL ITEMS</b>				
<b>TOOLS &amp; MANUALS</b>				