



# HYUNDAI A6MF1/2/3, (i30, i40 2010 - UP) & Kia 6 SPEED FWD & AWD With Lock Up (Electronic Control)



AUTOMATIC CHOICE



THE AUTOMATIC TRANSMISSION PARTS WAREHOUSE

H

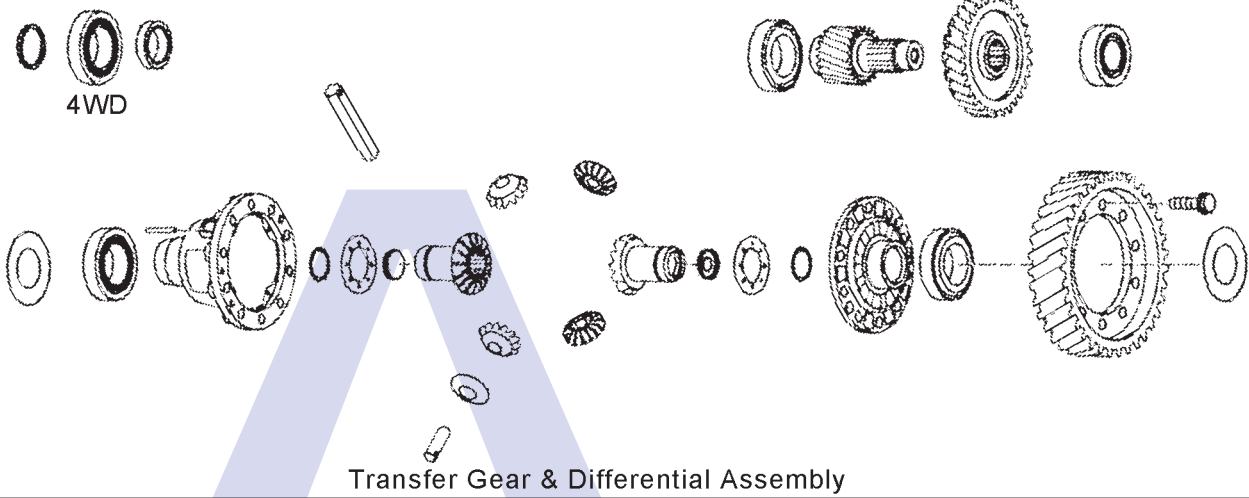

J

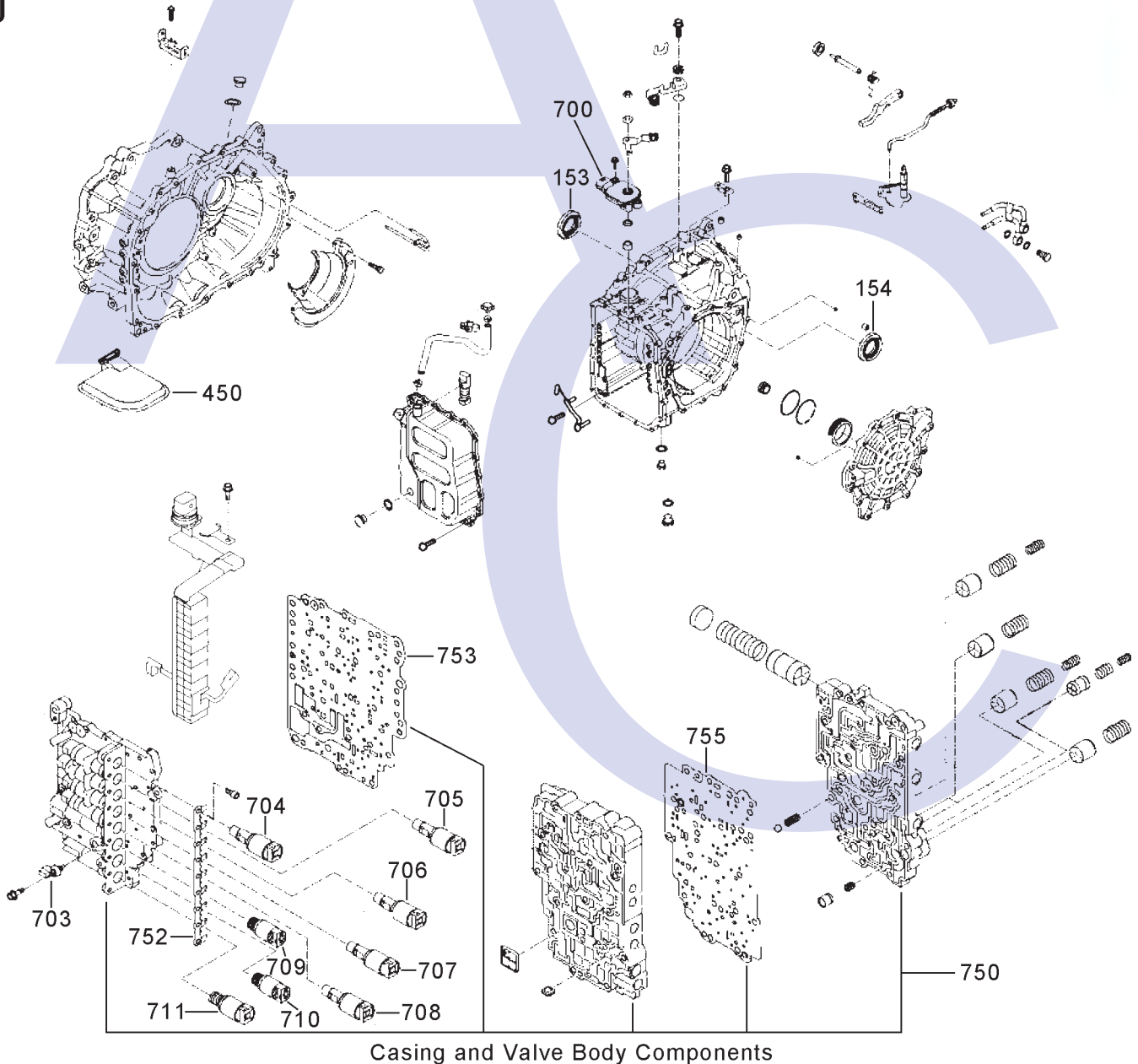

# HYUNDAI A6MF1/2/3, (i30, i40 2010 - UP) & Kia 6 SPEED FWD & AWD With Lock Up (Electronic Control)



AUTOMATIC CHOICE



THE AUTOMATIC TRANSMISSION PARTS WAREHOUSE

ILL NO.	DESCRIPTION	YEARS	QTY	PART NO
<b>KITS</b>				
Kit	Overhaul Kit, <b>A6MF2</b> (i30, i40 & Kia) .....	10-ON	1	<b>A6MF.OHK11</b>
Kit	Overhaul Kit, <b>A6MF2</b> (Precision) (i30, i40 & Kia, With Pistons) .....	10-ON	1	<b>A6MF.OHK51</b>
<b>GASKETS</b>				
<b>RUBBER COMPONENTS</b>				
126C	'D' Ring, Underdrive Piston (Outer) .....	10-ON	1	<b>A6MF.OR03</b>
127C	'O' Ring, Underdrive Piston (Inner) .....	10-ON	1	<b>A6MF.OR02</b>
<b>METAL CLAD SEALS</b>				
150A	Pump to Converter .....	10-ON	1	<b>A6LF.MCS01</b>
150A	Pump to Converter (Precision) ..	10-ON	1	<b>A6GF.MCS51</b>
150A	Pump to Inverter (70mm x 25mm) Sonata Hybrid, Optima Hybrid ..	11-ON	1	<b>A6MF.MCS09</b>
153J	Drive Shaft R/Hand ( <b>A6MF</b> ) (i30) .....	10-ON	1	<b>A6MF.MCS03</b>
153J	Drive Shaft R/Hand ( <b>A6MF</b> ) (i40) .....	10-ON	1	<b>A6MF.MCS05</b>
154J	Drive Shaft L/Hand ( <b>A6MF</b> ) (i30) .....	10-ON	1	<b>A6MF.MCS02</b>
154J	Drive Shaft L/Hand ( <b>A6MF</b> ) (i40) .....	10-ON	1	<b>A6MF.MCS04</b>
<b>MOULDED PISTONS</b>				
<b>SEALING RINGS</b>				
<b>CLUTCH KITS</b>				
Kit	2-6 Brake (OEM) (i40, 1.7L Diesel) .....	10-ON	1	<b>A6MF.CK07</b>
Kit	3-5-Rev (i30, 2.0L Petrol OEM) ..	10-ON	1	<b>A6MF.CK03</b>
Kit	3-5-Rev (i40, 1.7L Diesel OEM) ..	10-ON	1	<b>A6MF.CK04</b>
Kit	Underdrive Brake (OEM) (i40, 2.0L Petrol) .....	10-ON	1	<b>A6MF.CK05</b>
Kit	Underdrive Brake (OEM) (i40, 1.7L Diesel) .....	10-ON	1	<b>A6MF.CK08</b>
Kit	Low & Rev (i30, OEM) .....	10-ON	1	<b>A6MF.CK01</b>
Kit	Low & Rev (i40, OEM) .....	10-ON	1	<b>A6MF.CK02</b>
Kit	Overdrive Clutch (i40, OEM) .....	10-ON	1	<b>A6MF.CK06</b>
<b>FRICION PLATES</b>				
Kit	Friction Plate (A6MF1) .....	10-ON	1	<b>A6MF.FRK51</b>

ILL NO.	DESCRIPTION	YEARS	QTY	PART NO
<b>STEEL PLATES</b>				
305G	Overdrive Clutch (Precision) (Sizes to Follow) .....	10-ON	1	<b>A6GF.STP57</b>
<b>PRESSURE PLATES</b>				
<b>SPRINGS &amp; CIRCLIPS</b>				
<b>FILTERS</b>				
450J	PickUp Filter (OE) .....	10-ON	1	<b>A6MF.FIL02</b>
450J	PickUp Filter (Precision) .....	10-ON	1	<b>A6GF.FIL51</b>
<b>BANDS</b>				
<b>BUSHINGS</b>				
<b>THRUST WASHERS &amp; BEARINGS</b>				
655E	Radial Bearing, Rear Planetary (Rear) .....	10-ON	1	<b>A6MF.TOR03</b>
656E	Race, Rear Planetary (Rear) .....	10-ON	1	<b>A6MF.THW01</b>
<b>ELECTRICAL COMPONENTS</b>				
700J	Range Switch (i30/i40) .....	10-ON	1	<b>A6MF.INH01</b>
703J	Oil Temperature Sensor .....	10-ON	1	<b>A6LF.ELE02</b>
704J	Solenoid, TCC .....	10-ON	1	<b>A6LF.SOL04</b>
705J	Solenoid, 3-5-Rev .....	10-ON	1	<b>A6LF.SOL03</b>
706J	Solenoid, 2-6 Brake .....	10-ON	1	<b>A6LF.SOL04</b>
707J	Solenoid, Underdrive .....	10-ON	1	<b>A6LF.SOL03</b>
708J	Solenoid, Overdrive .....	10-ON	1	<b>A6LF.SOL03</b>
709J	Solenoid, SSB .....	10-ON	1	<b>A6LF.SOL02</b>
710J	Solenoid, SSA .....	10-ON	1	<b>A6LF.SOL02</b>
711J	Solenoid, Pressure Control .....	10-ON	1	<b>A6LF.SOL01</b>
<b>VALVE BODY PARTS</b>				
750J	Valve Body Complete (Petrol, OEM) .....	10-ON	1	<b>A6LF.VB02</b>
752J	Bracket, Solenoid Support .....	10-ON	1	<b>A6LF.RET01</b>
753J	Valve Body Sperator Plate (Upper) .....	10-ON	1	<b>A6LF.SP01</b>
755J	Valve Body Sperator Plate (Lower) .....	10-ON	1	<b>A6LF.SP02</b>

# HYUNDAI A6MF1/2/3, (i30, i40 2010 - UP) & Kia 6 SPEED FWD & AWD With Lock Up (Electronic Control)



AUTOMATIC CHOICE



THE AUTOMATIC TRANSMISSION PARTS WAREHOUSE

ILL NO.	DESCRIPTION	YEARS	QTY	PART NO
<b>HARD PARTS</b>				
800A	Pump Complete (i30/i40) .....	10-ON	1	<b>A6MF.PUM01</b>
817D	Anulus, Front Planet .....	10-ON	1	<b>A6MF.GE01</b>
818D	Front Planetary (i40, ix35).....	10-ON	1	<b>A6MF.PL01</b>
819E	Sun Gear, Front Planet (i40).....	10-ON	1	<b>A6MF.SUN01</b>
821E	Rear Planetary (i40).....	10-ON	1	<b>A6MF.PL02</b>
822E	Sun Gear, Rear Planet (i40).....	10-ON	1	<b>A6MF.SUN02</b>
828G	Clutch Assembly, Overdrive (i40 1.7L Diesel Only) .....	10-ON	1	<b>A6MF.DRU01</b>
<b>SPECIAL ITEMS</b>				
Oil	Hyundai SP4-M ATF (OE) (946ml).....	10-ON	AR	<b>OIL.76</b>
<b>TOOLS &amp; MANUALS</b>				

ILL NO.	DESCRIPTION	YEARS	QTY	PART NO