

Hydramatic Standard Dual (Rolls Royce & Bently (1952-67) Hudson (1952-56), Lincoln (1952-54), Nash (1952-56) 4 Speed RWD (Hydraulic Control)



AUTOMATIC CHOICE



THE AUTOMATIC TRANSMISSION PARTS WAREHOUSE

A

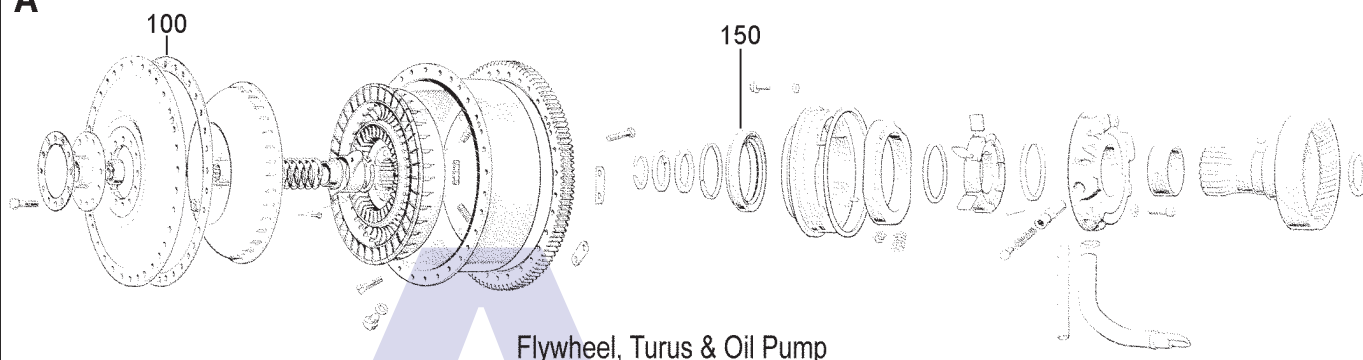

Flywheel, Turus & Oil Pump

B

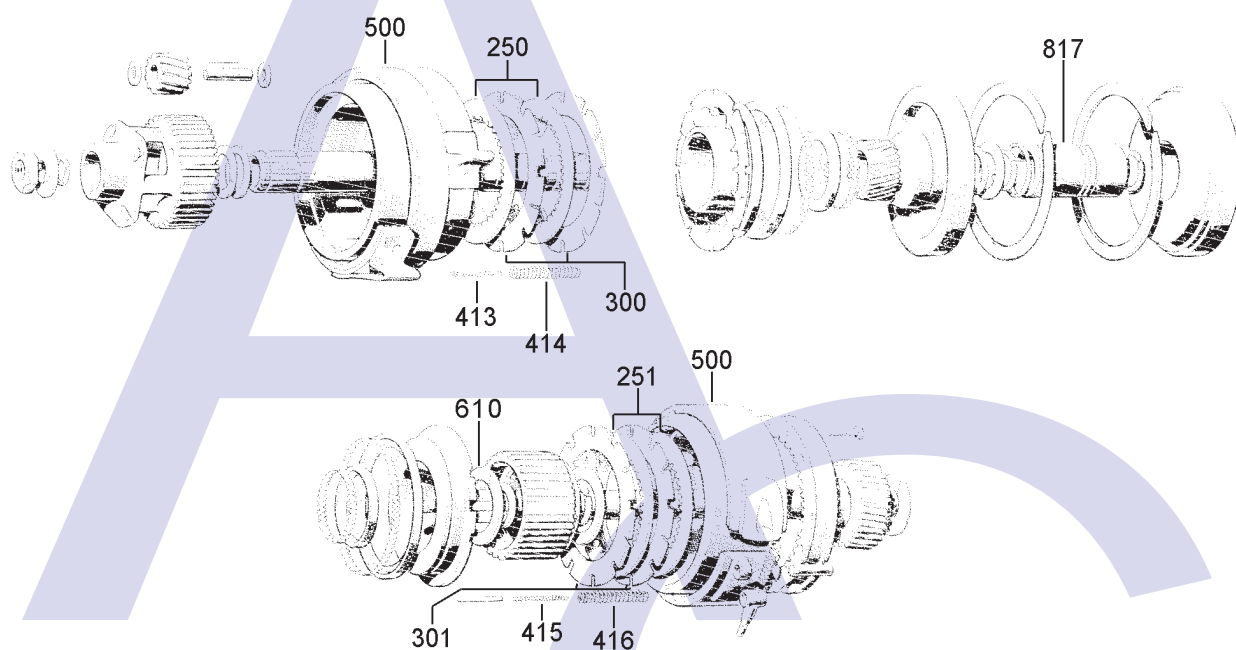

Front & Rear Drums

C

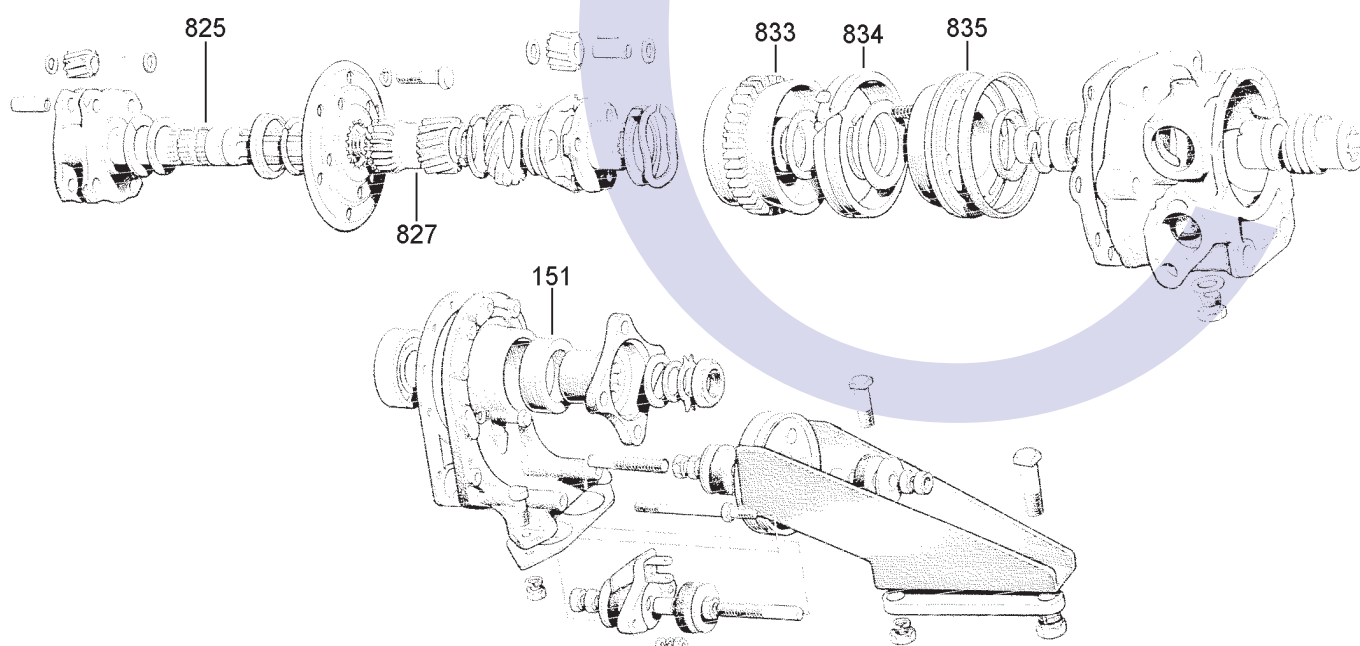

Output Shaft Assembly

Hydramatic Standard Dual (Rolls Royce & Bently (1952-67) Hudson (1952-56), Lincoln (1952-54), Nash (1952-56) 4 Speed RWD (Hydraulic Control)



AUTOMATIC CHOICE



THE AUTOMATIC TRANSMISSION PARTS WAREHOUSE

D

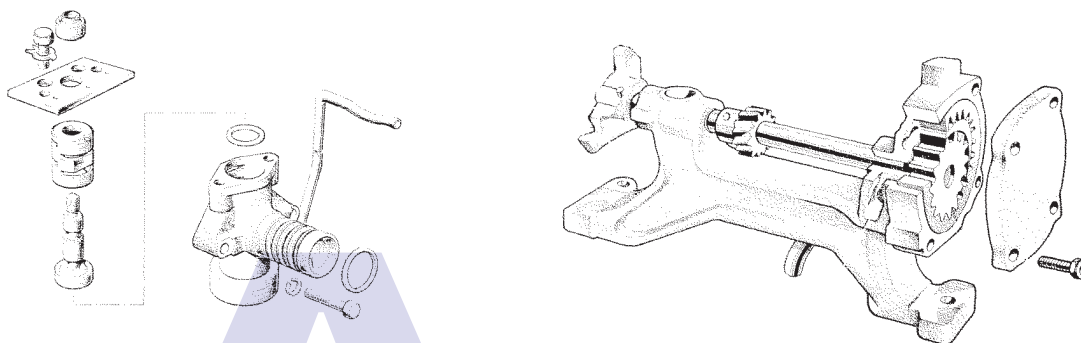

Governor & Secondary Pump

E

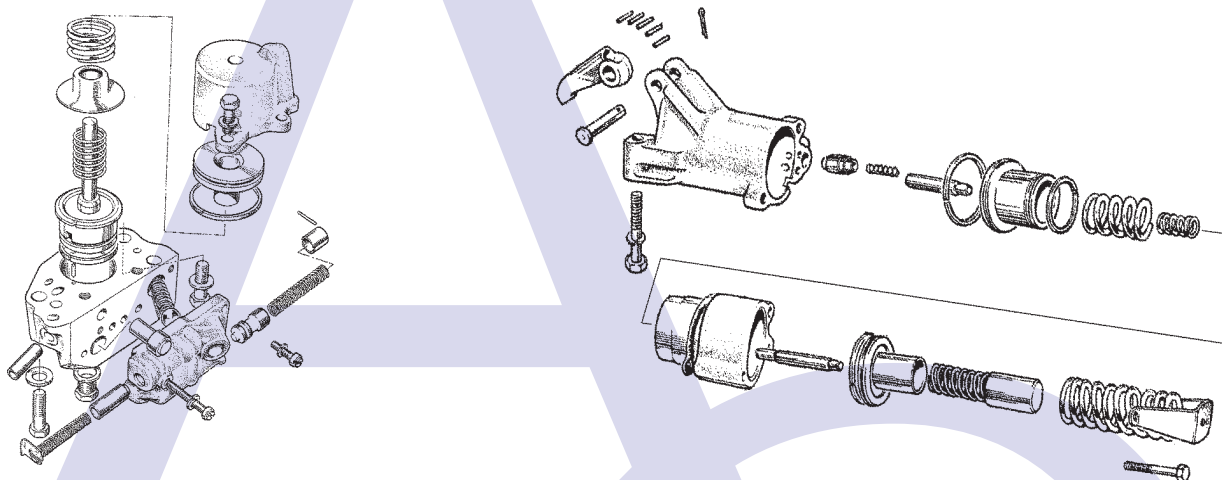

Front Servo Assembly

Rear Servo assembly

F

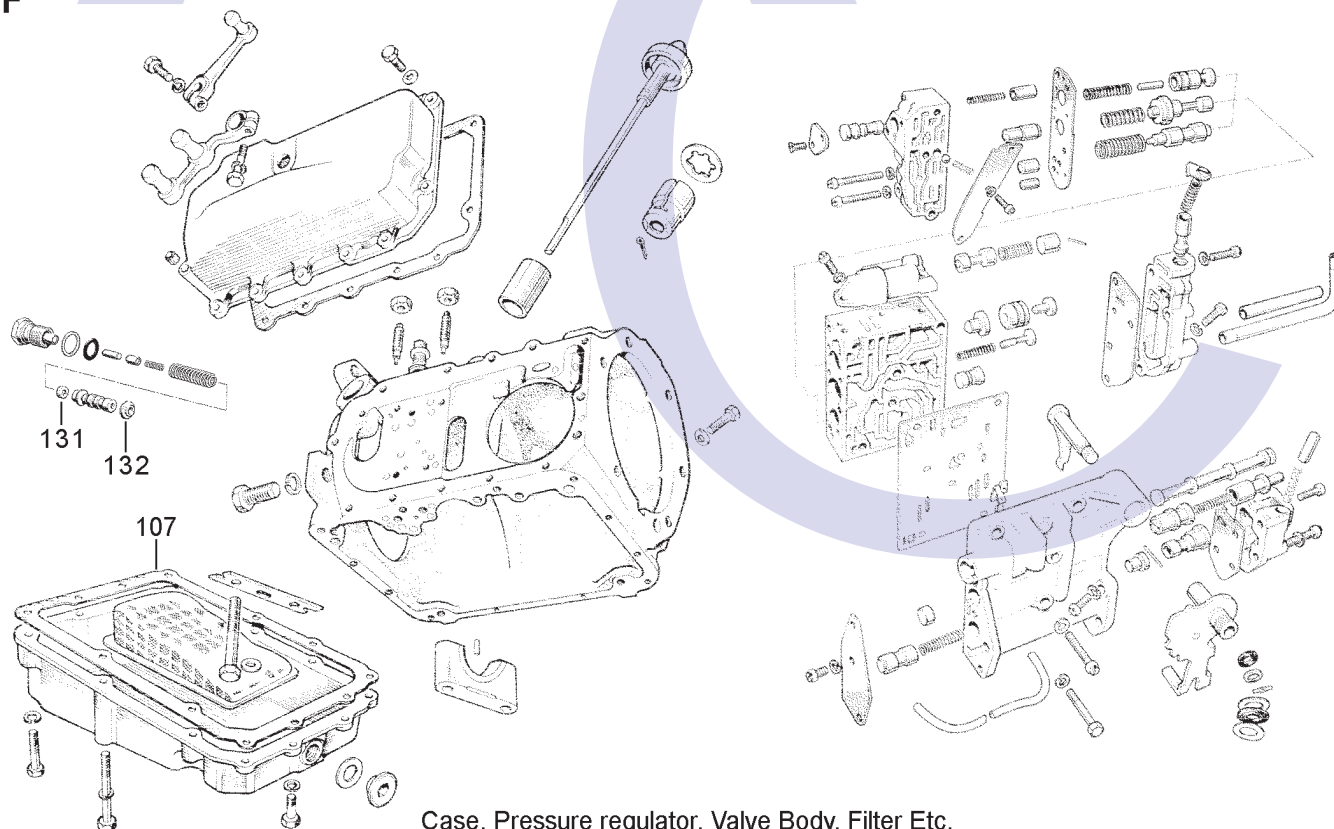

Case, Pressure regulator, Valve Body, Filter Etc.

Hydramatic Standard Dual 1946-67: (Rolls Royce & Bently52-67) Hudson (1952-56), Lincoln (1952-54), Nash (1952-56)

4 Speed RWD (Hydraulic Control)



AUTOMATIC CHOICE



THE AUTOMATIC TRANSMISSION PARTS WAREHOUSE

ILL NO.	DESCRIPTION	YEARS	QTY	PART NO
KITS				
Kit	Banner kit.....	55-56	1	HYDRA.BAK01
Kit	Master Overhaul (USA Vehicles).....	52-62	1	HYDRA.MOHK01
Kit	Master Overhaul (Rolls/Bentley).....	52-67	1	HYDRA.MOHK02
Kit	Overhaul Kit (GM/USA Vehicles).....	46-62	1	HYDRA.OHK01
GASKETS				
100A	Converter (350mm OD)	46-67	1	HYDRA.GAS02
100A	Converter (380mm OD)	46-67	1	HYDRA.GAS03
107F	Pan Gasket USA Models	46-62	1	HYDRA.GAS01
107F	Pan Gasket Rolls/Bentley (12 Bolt)	52-67	1	HYDRA.GAS04
RUBBER COMPONENTS				
NI	'O' Ring, Fluid Coupling	46-67	1	HYDRA.OR01
131F	Cushion Rubber, Pressure regulator (Outer).....	46-67	1	HYDRA.RUB01
132F	Cushion Rubber, Pressure regulator (Inner).....	46-67	1	HYDRA.RUB02
METAL CLAD SEALS				
150A	Pump Seal (85mm OD).....	46-67	1	HYDRA.MCS01
151C	Extension Seal (66.70mm OD) .	46-67	1	HYDRA.MCS02
SEALING RINGS				
FRICITION PLATES				
Kit	Friction Plate (Alto)	51-67	1	HYDRA.FRK51
250B	Front Clutch (Waved).....	51-67	6	HYDRA.FRP01
250B	Front Clutch (Cork/Paper).....	52-67	6	HYDRA.FRP02
251B	Rear Clutch (Waved)	51-67	6	HYDRA.FRP01
251B	Rear Clutch (Cork/Paper)	52-67	6	HYDRA.FRP02
STEEL PLATES				
Kit	Steel Plate (Alto).....	51-67	1	HYDRA.STK51
300B	Front Clutch	46-67	AR	HYDRA.STP01
301B	Rear Clutch	46-67	AR	HYDRA.STP01
PRESSURE PLATES				
SPRINGS & CIRCLIPS				
413B	Inner Clutch Release Spring (Front Drum)	46-67	AR	HYDRA.SPR01
414B	Outer Clutch Release Spring (Front Drum)	46-67	AR	HYDRA.SPR02
415B	Inner Clutch Release Spring (Rear Drum)	46-67	AR	HYDRA.SPR01
416B	Inner Clutch Release Spring (Rear Drum)	46-67	AR	HYDRA.SPR02
NI	Spring, Torus Torsion Damper ..	46-67	6	HYDRA.SPR03

ILL NO.	DESCRIPTION	YEARS	QTY	PART NO
FILTERS				
BANDS				
500B	Front Band (Rolls Royce) (One Lug Bevelled on Corner) ..	46-67	1	HYDRA.BAN03
501B	Front Band (One Lug Notched in Centre)....	54-56	1	HYDRA.BAN02
501B	Rear Band (With Pin)	46-67	1	HYDRA.BAN04
Click Here For Hydramatic Standard & Dual Range Band Identification Chart				
BUSHINGS				
Kit	Bushing Kit.....	46-67	1	HYDRA.BK01
NI	Bush, Rear Clutch Drum	46-67	1	HYDRA.BUS02
THRUST WASHERS & BEARINGS				
Kit	Thrust Washer Kit	46-67	1	HYDRA.TWK01
610B	Thrust Washer Rear Hub (Front Bronze).....	46-67	1	HYDRA.THW01
ELECTRICAL COMPONENTS				
VALVE BODY PARTS				
HARD PARTS				
817B	Oil Delivery Sleeve.....	46-67	1	HYDRA.SL01
825C	Rear Planetary (USA Models Only)	46-62	1	HYDRA.PL01
827C	Sun Gear (USA Models Only) ...	46-62	1	HYDRA.SUN01
833C	Rear Ring Gear (USA Models Only)	46-62	1	HYDRA.GE01
834C	Reverse Cone (Aluminium) (Rolls Royce)	52-67	1	HYDRA.CON01
835C	Reverse Piston (USA Models Only)	46-62	1	HYDRA.PIS01
SPECIAL ITEMS				
TOOLS & MANUALS				