

Pump Assembly

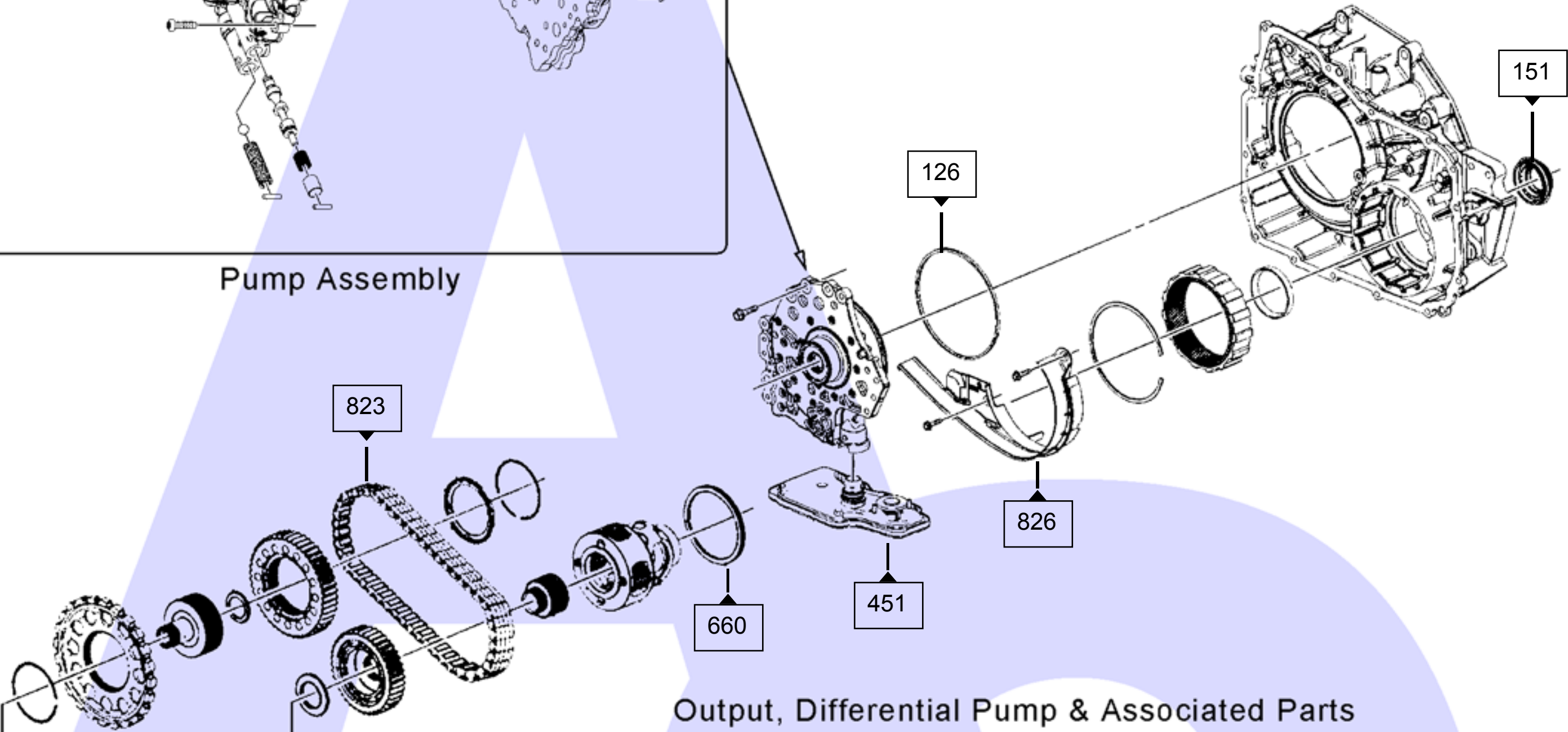

Output, Differential Pump & Associated Parts

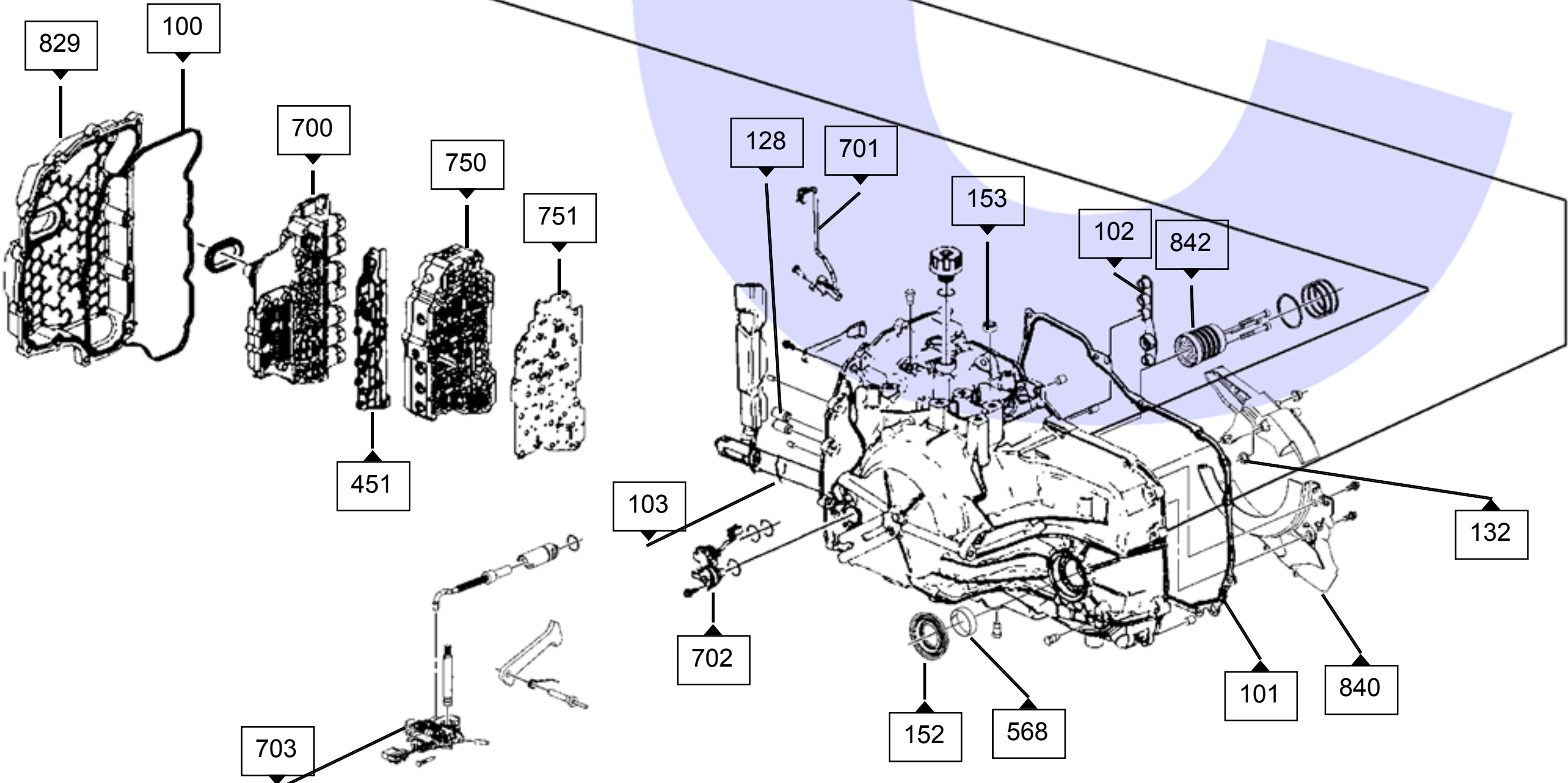

Valve Body, Sensors Main Case & Associated Parts

Bearings (000174)

REF	DESCRIPTION	QUANTITY	PART NO
660	6T40/45/50 DIFF TO CASE THRUST BEARING	1	6T30.TOR01
651	#6T40/45/50 TORRING BEARING SPROCKET HUB TO OUTPUT SUNGEAR	1	6T30.TOR05
661	# 6T40/45 TORRINGTON. INPUT PLANET TO OUTPUT CARRIER	1	6T30.TOR03

Bushings (000180)

REF	DESCRIPTION	QUANTITY	PART NO
568	6T30/6T40/6T45/6F35 NEARSIDE DRIVE SHAFT BUSH	1	6T30.BUS03
553	6F35 6T40 6T45 REAR SUNGEAR BUSH	1	6T30.BUS01
561	6T30/6T40/6T45/6F35 BUSHING PUMP	1	6T30.BUS02

Filters (000150)

REF	DESCRIPTION	QUANTITY	PART NO
451	6T30 6T40 6T45 6T50 FILTER O.E.	1	6T30.FIL01
451	SOLENOID-VALVE BODY FILTER PLATE	1	6T30.FIL02
451	SOLENOID-VALVE BODY FILTER SCREEN 6T45/6T50 OE	1	6T30.FIL04
451	6T30 6T40 6T45 6T50 AFTERMARKET FILTER	1	6T30.FIL11
451	SOLENOID-VALVE BODY FILTER SCREEN 6T40	1	6T30.FIL12
451	SOLENOID-VALVE BODY FILTER SCREEN 6T45/6T50	1	6T30.FIL13

Gaskets (000120)

REF	DESCRIPTION	QUANTITY	PART NO
100	# VB COVER GASKET	1	6T30.GAS01
101	# 6T40/45/50 MAINCASE GASKET	1	6T30.GAS02
102	CASE TO CASE PRESSURE GASKET	1	6T30.GAS03
103	6T30 / 6T40 / 6T50 FLUID LEVEL VALVE TO MAIN CASE GASKET	1	6T30.GAS04

Books & Manuals N (000265)

REF	DESCRIPTION	QUANTITY	PART NO
	6T30/40/45/50 WORKSHOP MANUAL ATSG	1	6T30.MAN01

Bushing Kits (000185)

REF	DESCRIPTION	QUANTITY	PART NO
	6T40/6T45/6F35 BUSHING KIT GM/FORD	1	6T40.BK01

Electrical Parts (000250)

REF	DESCRIPTION	QUANTITY	PART NO
	6T40/45/50 GEN 1 PRESS. SWITCH REPAIR KIT ON SOLENOID BLOCK	1	6T30.ELE04
	# 6T30/40/45E .GEN 1 SOLENOID KIT	1	6T30.SOL31
700	# 6T30 SOLENOID BLOCK Gen1	1	6T30.SOL01
700	# 6T30 SOLENOID BLOCK CHEVY CRUZE 2010> Gen1	1	6T30.SOL02
700	# 6T30 SOLENOID BLOCK CAPTIVA 2010- CRUZE 2011- Gen1	1	6T30.SOL03
700	# 6T30 SOLENOID BLOCK ASTRA 1.4/1.6 CHEVY Gen1	1	6T30.SOL04
700	# 6T30 SOLENOID BLOCK CRUZE 2012> Gen1	1	6T30.SOL05
700	# 6T30/6T50 SOLENOID BLOCK ASTRA 1.4/1.6 Captiva 2012> Gen2	1	6T30.SOL06
700	# 6T30 SOLENOID BLOCK ASTRA 1.4/1.6 Gen2	1	6T30.SOL07
700	# 6T30 SOLENOID BLOCK ASTRA 1.4/1.6 Gen2	1	6T30.SOL08
700	# 6T30 SOLENOID BLOCK Chevy Epica/Tosca	1	6T30.SOL09
701	# OUTPUT SPEED SENSOR	1	6T30.ELE01
702	# INPUT SPEED SENSOR	1	6T30.ELE02
703	# INHIBITOR SWITCH (on Valve Body)	1	6T30.ELE03

Friction Plate Kits (000135)

REF	DESCRIPTION	QUANTITY	PART NO
	6T40/45/50 FRICTION KIT 06- 11 (Gen 1)	1	6T30.FRK01
	6T30/40/45 FRICTION KIT	1	6T30.FRK51

Friction Plates (000130)

REF	DESCRIPTION	QUANTITY	PART NO
250 / 252	1-2-3-4 & 2-6 FRICTION 218 OD x 188 ID x 1.5 36 TEETH	2 & 2	6T30.FRP01
250	2-6 FRICTIONS 218MM OD 188 ID 36T 1.6 WAVED Gen2	2	6T30.FRP14
251	LOW & REVERSE 217 OD x 190 ID x 1.6 48 TEETH	3	6T30.FRP02
252	1-2 3-4 FRICTIONS 212 O/D 187 I/D 36T 1.45 WAVED Gen2	2	6T30.FRP13
253	3-5 / REV FRICTION 174 OD x 144 ID x 1.6 36 EXTERNAL TEETH	3	6T30.FRP04
253	3-5-REV FRICTION - Teeth have groove in middle	3	6T30.FRP11
254	4-5-6 FRICTION O.E 122 OD x 95 ID x 1.6 24 TEETH	4	6T30.FRP03
254	# 4-5-6- O.E FRICTION 24 TEETH 122mm O/D 1.62mm	4	6T30.FRP10

Hard Parts (000240)

REF	DESCRIPTION	QUANTITY	PART NO
	# 6T30 OIL PUMP CAPTIVA	1	6T30.PUM01
	# 6T40/6T45 3/5/R 4/5/6 DRUM COMPLETE 3 RING HUB	1	6T40.DRU01
800	6T30 INPUT SHAFT	1	6T30.SH01
802	# CENTRE SUPPORT LOW/REV-1234 HOUSING ASTRA LACETI CRUZE	1	6T40.SUP01
804	# 6T40/45/50 DRUM 3-5-REV & 4-5-6 36T UPDATED GEN1	1	6T30.DRU02
804	# 6T40/45/50 DRUM 3-5-REV & 4-5-6 36T GEN2	1	6T30.DRU04
807	# REACTION CARRIER HUB	1	6T30.HUB01
808	# SUN GEAR & SHELL 6T40 only 46MM OD GEAR 35T	1	6T30.SUN01
809	# REACTION CARRIER 3 Lugs.	1	6T30.PL01
809	# REACTION CARRIER 3 LUGS AM	1	6T30.PL31
810	6T40 INPUT PLANET CARRIER (MH8)	1	6T40.PL02
811	# 6T40/45/50 INPUT CARRIER SUN GEAR	1	6T30.SUN02
812	# 6T40 MH8 OUTPUT CARRIER 2010- 4 pinion gears	1	6T40.PL01
823	6T40/45/50 CHAIN DRIVE 08-Up	1	6T40.CH01
823	# 6T40 CHAIN GM (1.00 INCH/38 LINKS) 2011-Up	1	6T40.CH02
829	PLASTIC VALVE BODY COVER MH7 MH8 MH9 MHC MHK MHJ	1	6T30.PAN01
831	6T40 OIL PUMP ASSY 08-12 (.785" BRNG SURFACE)	1	6T30.PUM03
831	# 6T40 OIL PUMP CHEVROLET/ASTRA	1	6T40.PUM01
842	6T40/6F35 CLUTCH HUB 4-5-6/3-5-REV 08-Up 4 Ring Lands 3 Bolt	1	6T30.HUB02
900	# 6T40 CHEVY ORLANDO 6 SPD FWD MAINCASE MH8/FW8	1	6T45.CAS01

Metal Clad Seals (000125)

REF	DESCRIPTION	QUANTITY	PART NO
153	# 4L30E /5L40E MANUAL LEVER SHAFT SEAL	1-2	4L30E.MCS04
150	# 6T30/40/45/50 2008> PUMP SEAL	1	6T30.MCS01
150	*** USE 6T30.MCS01 *** # 6T30/40/45/50 PUMP SEAL OEM	1	6T30.MCS04
151	# D/S SEAL CONVERTER SIDE RH	1	6T30.MCS02
152	# D/S SEAL LH	1	6T30.MCS03

Overhaul Kits (000110)

REF	DESCRIPTION	QUANTITY	PART NO
	6T40 6T45 6T50 2008> GEN1 AND GEN2 KIT WITH PISTONS	1	6T30.OHK51
	6T40 6T45 6T50 2008> GEN1 AND GEN2 KIT WITHOUT PISTONS	1	6T30.OHK52
	6T40/45 OVERHAULKIT WITHOUT PISTONS 06-	1	6T40.OHK01
	6T40/45 OVERHAULKIT WITH PISTONS 06-	1	6T40.OHK02

Piston Kits (000225)

REF	DESCRIPTION	QUANTITY	PART NO
	6T40/6T45 PISTON KIT GM/OPEL/CHEVROLET (5 PCS)	1	6T40.PISKIT01
	6T40/6T45 NAK PISTON KIT GM/OPEL/CHEVROLET (5 PCS)	1	6T40.PISKIT51

Pistons (000221)

REF	DESCRIPTION	QUANTITY	PART NO
170	MOULDED PISTON 2-6	1	6T30.PIS02
170	MOULDED PISTON 2-6 PRECISION	1	6T30.PIS52
171	MOULDED PISTON LOW & REVERSE	1	6T30.PIS05
171	MOULDED PISTON LOW & REVERSE PRECISION	1	6T30.PIS55
172	# MOULDED PISTON 1-2-3-4	1	6T30.PIS01
172	MOULDED PISTON 1-2-3-4 PRECISION	1	6T30.PIS51
173	# MOULDED PISTON 3-5 / REV	1	6T30.PIS04
173	MOULDED PISTON 3-5 / REV PRECISION	1	6T30.PIS54
175	# MOULDED PISTON DAMPER 4-5-6 (GEN1) MH7 MH8 MHK	1	6T30.PIS03
175	# 4-5-6 DAMPER PISTON MH8 MHK GEN2	1	6T30.PIS11
175	MOULDED PISTON DAMPER 4-5-6 PRECISION	1	6T30.PIS53
806	6T40/45 ALLUMINIUM PISTON 4/5/6 CLUTCH	1	6T30.PIS06

Pressure Plates (000144)

REF	DESCRIPTION	QUANTITY	PART NO
	6T40/45/50 3-5 REV CLUTCH PRESSURE PLATE 156MM OD	1	6T30.PP08
401	# 6T40/45/50 LOW/REV PRESSURE PLATE	1	6T30.PP09
402	1-2-3-4 CLUTCH PRESSURE PLATE	1	6T30.PP01
403	# 6T40/45/50 3-5 REV CLUTCH PRESSURE PLATE UPDATED 173mm OD	1	6T30.PP05
404	4-5-6 CLUTCH APPLY PRESSURE PLATE 2.9mm	1	6T30.PP04
405	4-5-6 CLUTC PRESSURE PLATE	1	6T30.PP03

Sealing Ring & O-Ring Kits (000195)

REF	DESCRIPTION	QUANTITY	PART NO
	6T40/45/50 3-5-R O RING KIT	1	6T30.ORK51
	6T40/45/50 4-5-6 O RING KIT	1	6T30.ORK52
	6T30 SEALING RING KIT	1	6T30.SRK01
	6T40/45/50 O-RING KIT 3-5 CLUTCH	1	6T40.ORK51

Sealing Rings & O-Rings (000190)

REF	DESCRIPTION	QUANTITY	PART NO
120	6T40/45 3-5 REV CLUTCH INNER O RING	1	6T30.OR06
121	3-5 REV CLUTCH INNER O RING	1	6T30.OR05
122	3-5 REV CLUTCH INNER O RING	1	6T30.OR04
123	4-5-6 CLUTCH PISTON OUTER O RING	1	6T30.OR02
124	4-5-6 CLUTCH PISTON OUTER SEAL	1	6T30.OR03
125	6T40/45 4-5-6 CLUTCH INNER ORING	1	6T30.OR08
126	PUMP O RING	1	6T30.OR01

Shift Kits (000261)

REF	DESCRIPTION	QUANTITY	PART NO
	# 6T40/45/50 GEN 1 SHIFT KIT	1	6T30.SK01

Small Hard Parts (000220)

REF	DESCRIPTION	QUANTITY	PART NO
128	VB TO CASE RUBBER TUBE SEAL	1	6T30.RUB01
132	SEAL DRIVE LINK	1	6T30.RUB02
410	6T45/50 2-6 PISTON DIAPHRAGM	1	6T40.DIA02
411	6T40 LOW/REV DIAPHRAM (USE WITH 6T40.SUP01)	1	6T40.DIA01
431 / 432	6T40/45/50 Circlip Diaph. Retainer Low/Rev & 1-4 clutch.	1	6T30.CIR02
436	6T40/45/50 CIRCLIP TURBINE SHAFT RET	1	6T45.CIR01
437	# 6T40/45/50 3-5 REV CLUTCH CIRCLIP UPDATED	1	6T30.CIR07
438	4-5-6 DAMPER CIRCLIP GEN 2 MH7 MH8 MH9 MHK	1	6T30.CIR08
438	4-5-6 DAMPER CIRCLIP GEN 1 MH7 MH8 MH9 MHK	1	6T30.CIR09
439	# 6T40/45 4-5-6 CLUTCH CIRCLIP	1	6T30.CIR05
801	# 6T40 LOW CLUTCH SPRAG ASSY MH7	1	6T30.OWC01
803	6T40/45/50 INPUT SPEED SENSOR RELUCTOR RING	1	6T30.SEN01
826	# 6T40/45 08 - 09 OIL BAFFLE FRONT DIFF CARRIER - BELLHOUSE	1	6T30.RET03
840	# 6T40 OIL BAFFLE FRONT DIFF CARRIER - MAIN CASE	1	6T30.RET05



Steel Plate Kits (000145)

REF	DESCRIPTION	QUANTITY	PART NO
	# 6T40/45/50 STEEL PLATE KIT	1	6T30.STK01
	6T30/40/45 STEEL PLATE KIT	1	6T30.STK51

Torque Converter Parts (000320)

REF	DESCRIPTION	QUANTITY	PART NO
	CONV L/U LINING 9.813x8.562x.045 HTE - 6T40/6T45 - 236MM	1	Z-B45680HTE
	CONV L/U LINING 9.813x8.562x.045 HTS	1	Z-B45680HTS
	CONV. LOCKUP LINING 9.813 x 8.562 x .066 HTS	1	Z-B66680HTS
	CONV. TF60SN (09G)/6T40/45/MT4A/MDX SPRAG 236MM-22 ELEMENTS	1	Z-BW-SP-5
	CONV. 6T40/45 HUB	1	Z-GM-90-75G
	CONV. 6T40/45 BEARING IMPELLER	1	Z-GM-N-24
	CONV. 6T40/45 BEARING TURBINE SIDE	1	Z-GM-N-25
	CONV. 6T40E RADIAL LIP SEAL	1	Z-GM-O-14V
	CONV. STATOR CAP GM 6T40/6T45 - 236MM (TURBINE SIDE)	1	Z-GM-WA-49
	CONV. STATOR CAP GM 6T40/6T45 - 236MM (TURBINE SIDE)	1	Z-GM-WA-50
	CONV. SEALING RING SCARF CUT PTFE 6T30/40/45 RE4F04A	1	Z-JA-O-4
	1 5/8 DIA TC NECK COVER (PURPLE)	1	Z-MI-HC-P

Valve Body Parts (000262)

REF	DESCRIPTION	QUANTITY	PART NO
	6L45/50/80/90 VALVE KIT COMPENSATOR FEED REGULATOR	1	6L45E.VA01
751	GEN1 SEPERATOR PLATE	1	6T30.SP01
	GM 6T40 OVERSIZED SOL REG VALVE	1	6T40.VA01
	6T40/45/50 GEN1 OVERSIZED PRESS. REG. VALVE KIT	1	6T40.VA03
	6T40/45/50 GEN1 OVERSIZE CLUTCH BOOST VALVE 1-2-3-4 CLUTCH	1	6T40.VA05
	6T40/45/50 GEN1/2 OVERSIZED TCC CONTROL VALVE	1	6T40.VA07
	6T40/45/50 GEN1 OVERSIZED TCC REG. VALVE	1	6T40.VA09
	6T40/45/50 GEN1 O-RINGED END PLUG KIT	1	6T40.VA11
	6T40/45/50 (Gen 1) ZIP KIT VALVE BODY	1	6T40.ZIP01
750	# VALVE BODY WITH CHANNEL PLATE Gen-1	1	6T30.VA01
750	VALVE BODY WITHOUT CHANNEL PLATE Gen-1	1	6T30.VA02

Steel Plates (000140)

REF	DESCRIPTION	QUANTITY	PART NO
	6T30 STEEL 4-5-6 92mm id x1.75 36 Teeth Gen2	3	6T30.STP14
300	6T40/45/50 2-6 WAVY STEEL 190mm OD (use with 6T30.STP01)	1	6T30.STP05
301	6T30 STEEL PLATE 2-6 190 ID X 3.3mm 15/22 TEETH 09-	2	6T30.STP01
302	6T30/6T40 LOW/REVERSE CLUTCH STEELS 193MM ID 1.80mm	3	6T30.STP02
304	6T30 FWD CLUTCH WAVY STEEL (1-2-3-4) (use with 6T30.STP03)	1	6T30.STP08
305	6T30 FORWARD CLUTCH STEEL (1-2-3-4) 1.75mm	2	6T30.STP03
305	6T30 STEEL PLATE 1-2-3-4 173 id x 1.75 11/24 TH	2	6T30.STP13
306	6T40/45/50 3-5-REV WAVED STEEL 170 OD 144 ID 1.1 36T Gen2	1	6T30.STP15
306	# 3-5-REV Wavy Steel 36 Internal Teeth 173mm O/D	1	6T30.STP18
307	3-5 /REV CLUTCH STEEL	3	6T30.STP06
309	4-5-6 STEEL PLATE (WAVED)	1	6T30.STP09
310	# STEEL 4-5-6 CLUTCH 1.75mm	3	6T30.STP04

Torque Converters N (000300)

REF	DESCRIPTION	QUANTITY	PART NO
	6T30 CONVERTER 600620	1	6T30.TC01
	Chevrolet Captiva 2011> 2.2 Diesel	1	6T30.TC51
	Chevrolet Cruze 2010> 2.0 Diesel	1	6T30.TC52
	USE 6T30.TC52 Chevrolet Cruze 2010> 2.0 Diesel	1	6T40.TC02

Transmission Tools N (000280)

REF	DESCRIPTION	QUANTITY	PART NO
	6T30/6T40 TESTPLATE FOR TESTER TOOL.139	1	6T30.TOOL01
	# GM 6T30 / 6T40 DRIVE SHAFT BUSH INSTALLER	1	6T30.TOOL03

Valve Body N (000241)

REF	DESCRIPTION	QUANTITY	PART NO
750	6T40/MH8 GM VALVEBODY GEN-II	1	6T40.VB01

Valve Body Tools N (000263)

REF	DESCRIPTION	QUANTITY	PART NO
	REAMER FOR 6T40.VA01 & 6F35.VA01	1	6T40.VA02
	REAMER FOR 6T40.VA03	1	6T40.VA04
	REAMER FOR 6T40.VA05 & 6T70.VA02	1	6T40.VA06
	REAMER FOR 6T40.VA07	1	6T40.VA08
	REAMER FOR 6T40.VA09	1	6T40.VA10