

4L60E 93-ON, 4L65E 02-ON, 4L70/75E 06-ON 4 SPEED RWD (Electronic Control)



AUTOMATIC CHOICE



THE AUTOMATIC TRANSMISSION PARTS WAREHOUSE

A

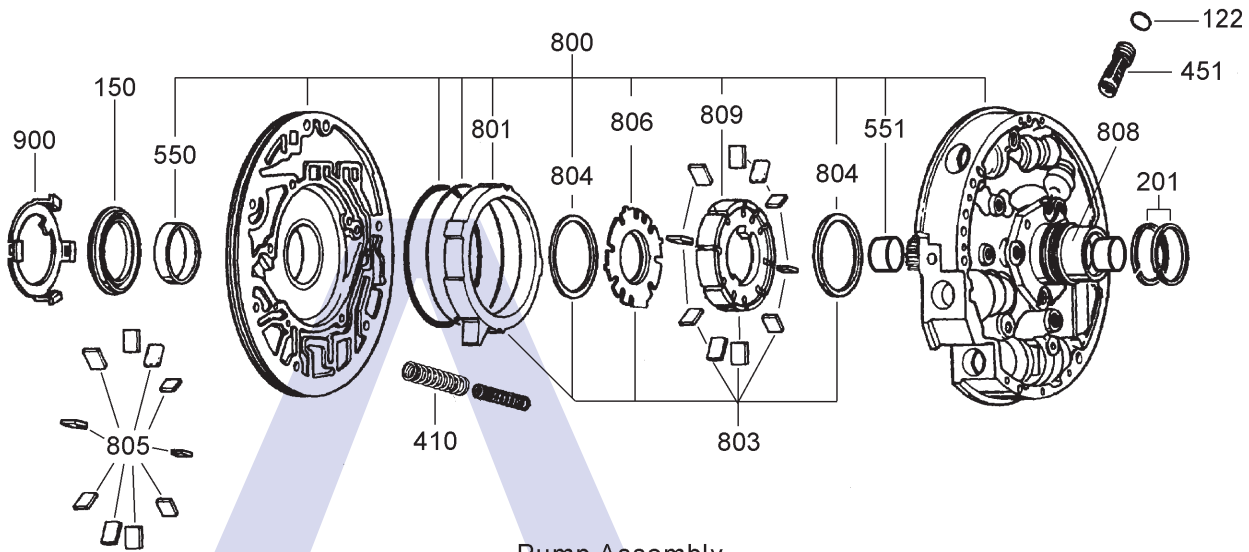

Pump Assembly

B

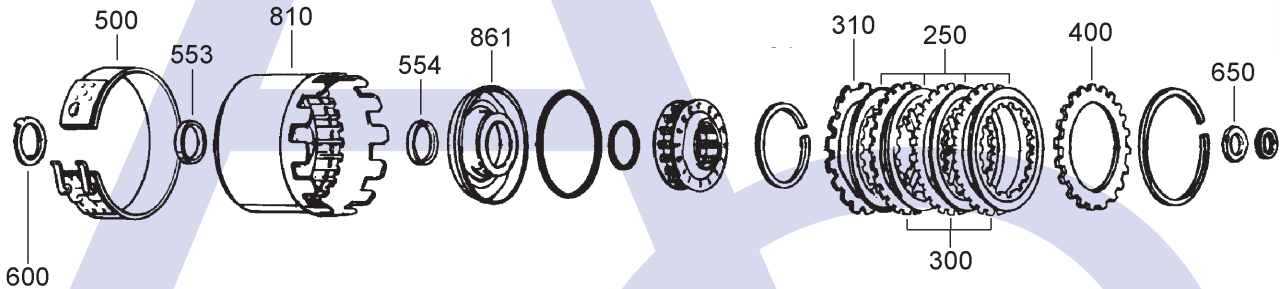

Reverse Input Clutch

C

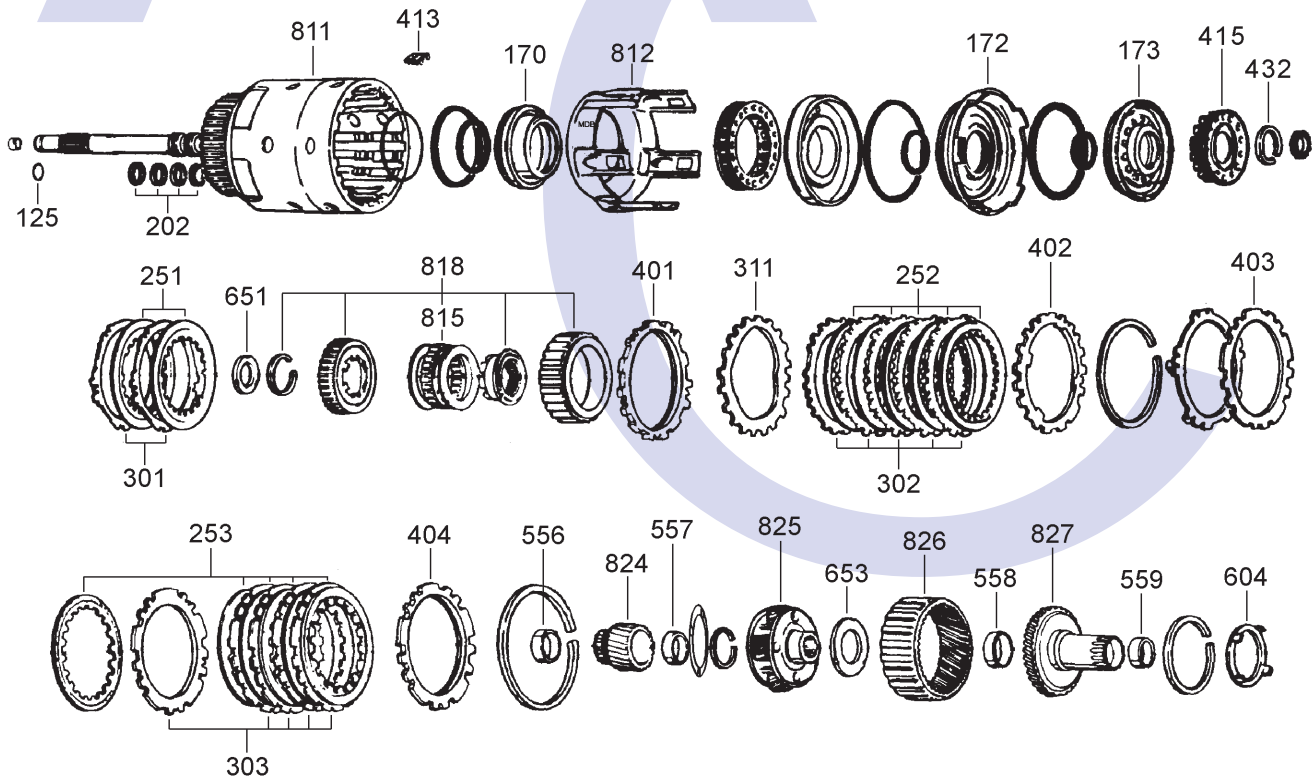

Coast, Forward and 3-4 Clutch

4L60E 93-ON, 4L65E 02-ON, 4L70/75E 06-ON 4 SPEED RWD (Electronic Control)



AUTOMATIC CHOICE



THE AUTOMATIC TRANSMISSION PARTS WAREHOUSE

D

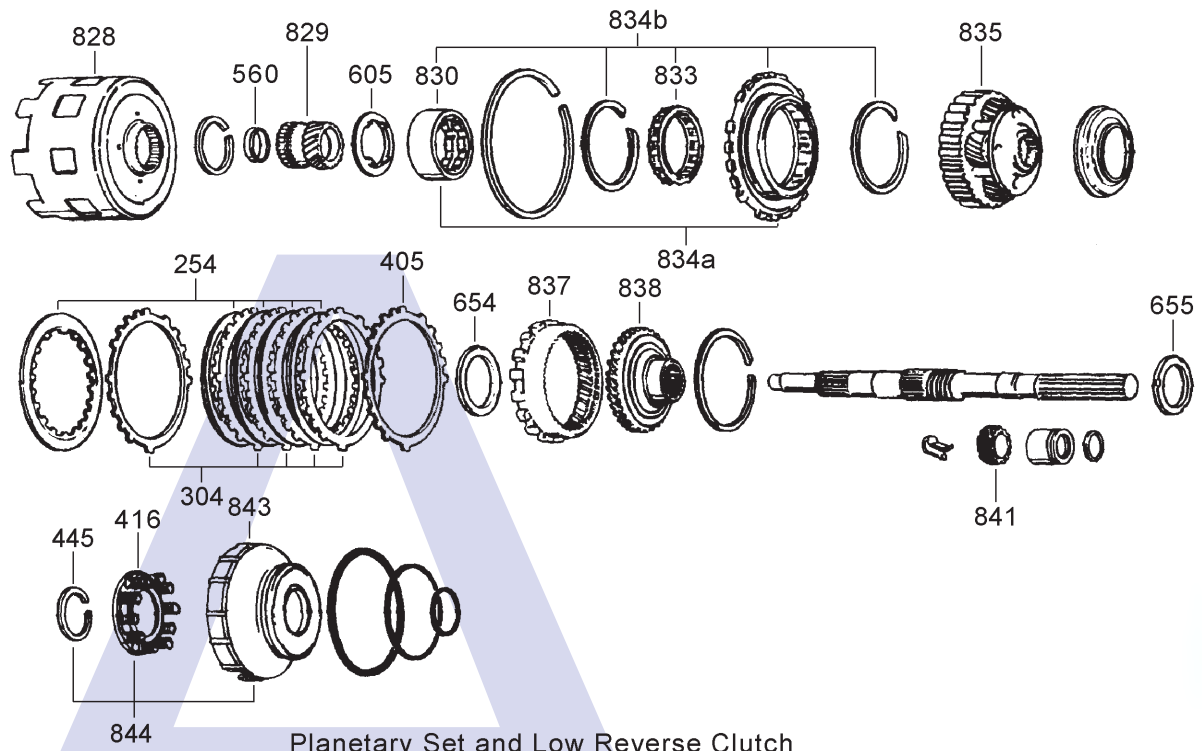

Planetary Set and Low Reverse Clutch

E

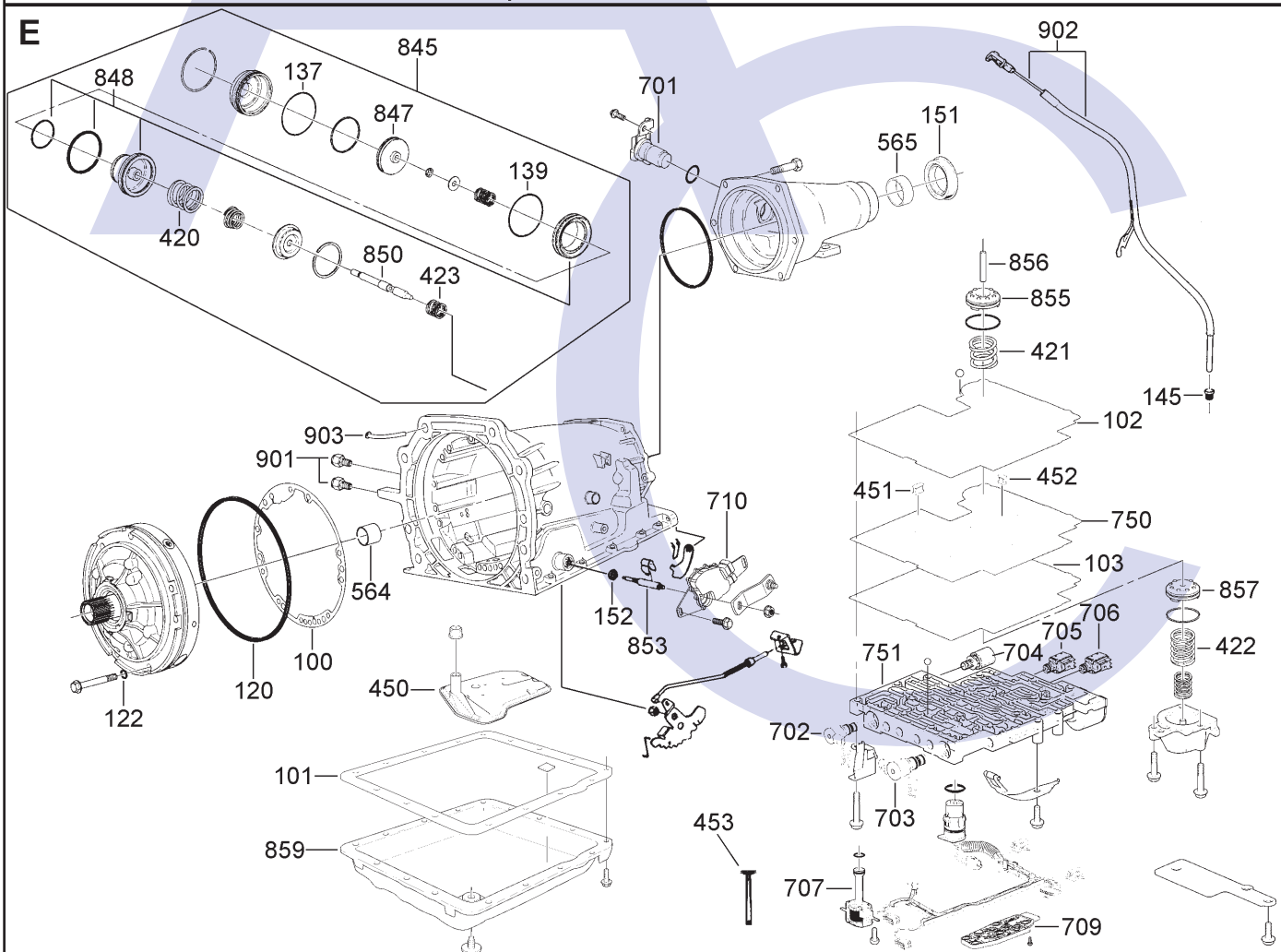

Casings, Valve Body & External Components

4L60E 93-ON, 4L65E 02-ON, 4L70/75E 06-ON 4 SPEED RWD (Electronic Control)



AUTOMATIC CHOICE



THE AUTOMATIC TRANSMISSION PARTS WAREHOUSE

ILL NO.	DESCRIPTION	YEARS	QTY	PART NO
KITS				
Kit	Master Overhaul Kit (4L60E) (With 1.95mm 3-4 Steels E93	1		4L60E.MOHK01
Kit	Overhaul Kit (Transtec) (4L60E) 93-04	1		4L60E.OHK01
Kit	Overhaul Kit (Transtec) (4L65E) 02-03	1		4L60E.OHK01
Kit	Overhaul Kit (Transtec) (4L60E/4L65E) 04-ON	1		4L60E.OHK04
Kit	Overhaul Kit (Transtec) (4L60E V8 With Bonded Rubber Valve Body Gasket) 06-ON	1		4L60E.OHK04
Kit	Overhaul Kit (Precision) (4L60E) 93-96	1		4L60E.OHK53
Kit	Overhaul Kit (Precision) (4L60E) 97-02	1		4L60E.OHK52
Kit	Sonnax "Sure Cure" Transmission Reconditioning Kit 4L60E 93-ON	1		4L60E.SCK01
Kit	High Performance Pack (4L60E/65E) (Sonnax® Click here for Info) . 93-ON	1		4L60E.SK02
Kit	Valve Body Gasket Set (4L60E/4L70E) 06-ON	1		4L60E.GK01
GASKETS				
100E	Front Pump to Case Gasket 93-ON	1		TH700.GAS02
101E	Pan Gasket (Cork) 93-ON	1		TH700.GAS01
101E	Pan Gasket (Fibre) 93-ON	1		TH700.GAS10
102E	Upper Valve Body 93-00	1		4L60E.GAS03
102E	Upper Valve Body, White Stripe 01-ON	1		4L60E.GAS07
103E	Lower Valve Body 93-00	1		4L60E.GAS04
103E	Lower Valve Body, White Stripe 01-ON	1		4L60E.GAS06
750E	Plate, Valve Body (Bonded) (V8 Engine) (4L60E, 4L70E, 4L75E) 06-ON	1		4L60E.GAS08
<i>Main Case to Transfer Box Gasket see Appropriate Transfer Box Section</i>				
RUBBER COMPONENTS				
Kit	Replacement Seal Kit for Sonnax 4th Gear "Super Hold" Servo (TH700.ACC11) 93-ON	1		TH700.SRK05
120E	Pump to Case Lathe Cut Seal .. 93-03	1		TH400.SQR01
120E	Pump to Case Stamped Steel Moulded Rubber 04-ON	1		4L60E.MCS07
122A	Pump Screen 'O' Ring 93-ON	1		DPO.OR08
125C	Turbine Shaft 'O' Ring (Green Coated) 93-ON	1		TH125.OR01
137E	O-Ring, Servo Cover (Outer Blue) 93-ON	1		TH700.OR01
139E	O-Ring, Servo Cover (Inner Red) 93-ON	1		TH700.OR03
145E	Filler Tube to Case Multi Lip Seal (Replaces O Ring) 93-ON	1		TH125.LIP03
122E	'O' Ring, Pump Bolt 93-ON	7		TH700.OR02
NI	2nd Apply Servo Saver Seal (Sonnax®, 5 per bag) 93-ON			4L60E.SL01
NI	Servo Pisto Bore Seal 93-ON	1		4L60E.MCS05
METAL CLAD SEALS				
150A	Front Pump Seal 93-ON	1		TH700.MCS01
151E	Extension Housing 93-ON	1		TH180.MCS02
151E	Extension Housing (Corvette Only) 97-ON	1		4L60E.MCS04
152E	Selector Shaft 93-ON	1		TH180.MCS03
NI	Adaptor Housing (Colorado, Some Hummer 06-) 04-ON	1		4L60E.MCS06

ILL NO.	DESCRIPTION	YEARS	QTY	PART NO
MOULDED PISTONS				
170C	Piston, 4th Clutch (Molded Rubber) 93-ON	1		4L60E.PIS01
172C	Piston, Forward Clutch (Molded Rubber) 93-ON	1		4L60E.PIS02
172C	Piston, Forward Clutch (Aluminium Version) 93-ON	1		4L60E.PIS05
173C	Piston, Overrun Clutch (Molded Rubber) 93-ON	1		4L60E.PIS03
SEALING RINGS				
Kit	Sealing Ring Kit 93-ON	1		4L60E.SRK01
201A	Stator Support Rear (Solid Teflon®) 93-ON	2		TH700.SSR03
202C	Turbine Shaft Sealing Ring (Solid Teflon®) 93-ON	4		TH700.SSR01
FRICITION & STEEL KITS				
Kit	3rd & 4th Clutch Hi Performance Kit (Borg Warner) With Friction & Steel Plates 93-ON	1		TH700.CK01
Kit	3rd & 4th Clutch Improver Kit (Alto) With Friction & Steel Plates 93-ON	1		TH700.CK02
Kit	3rd & 4th Clutch Hi Performance Kit (Alto) With Friction & Steel Plates 93-ON	1		TH700.CK03
Kit	Friction & Steel Kit, 3/4 Clutch Z Pak (7 Friction, 7 Steel Kit & 2 Press. Plates) (Raybestos®) 93-ON	1		TH700.CK04
FRICITION PLATES				
Kit	Friction Plate 93-ON	1		TH700.FRK01
Kit	Friction Plate (Alto With Heg Frictions) 93-ON	1		TH700.FRK62
Kit	Friction Plate (Alto) 93-96	1		TH700.FRK52
Kit	Friction Plate (Without 4th Clutch) 93-ON	1		TH700.FRK02
Kit	Friction Plate (Alto) (With 6.0L Eng, With HEG Frictions (Heavy Duty) 01-ON	1		4L60E.FRK52
Kit	Friction Plate (Alto) (With HEG Frictions & Turbulator Steels) 97-ON	1		4L60E.FRK53
250B	Reverse Input (153mm OD x 1.80mm x 41T) .. 93-ON	4		TH700.FRP07
251C	Overrun Clutch (128mm OD x 2.00mm x 36T).... 93-ON	2		TH700.FRP03
252C	Forward Clutch (135mm OD x 1.75mm x 41T) .. 93-ON	5		TH700.FRP06
252C	Forward Clutch 4L60E (135mm OD x 1.75mm x 41T) .. 98-ON	5		TH700.FRP12
253C	3rd & 4th Clutch Hi Capacity (146mm OD x 1.60mm x 20T) .. 93-ON	AR		TH700.FRP08
253C	3rd & 4th Clutch Hi Energy (146mm OD x 2.00mm x 20T) .. 93-ON	6		TH700.FRP10
253C	3rd & 4th Clutch Hi Energy (4T65E) (146mm OD x 1.70mm x 20T) .. 02-ON	6		TH700.FRP14
254D	Low & Reverse Brake (164mm OD x 2.20mm x 25T) .. 82-ON	5		TH350.FRP05

4L60E 93-ON, 4L65E 02-ON, 4L70/75E 06-ON 4 SPEED RWD (Electronic Control)



AUTOMATIC CHOICE



THE AUTOMATIC TRANSMISSION PARTS WAREHOUSE

ILL NO.	DESCRIPTION	YEARS	QTY	PART NO
STEEL PLATES				
Kit	Steel Plate.....	02/93-97	1	TH700.STK05
Kit	Steel Plate (Alto)	02/93-97	1	4L60E.STK52
Kit	Steel Plate (Less 4th Clutch)	02/93-97	1	TH700.STK06
Kit	Steel Plate, (Alto) (With HEG Frictions & Turbulator Steels)	97-00	1	4L60E.STK54
Kit	Steel Plate (Alto) (With HEG Frictions (Heavy Duty)	01-ON	1	4L60E.STK53
Kit	Steel Plate.....	97-ON	1	TH700.STK08
Kit	Steel Plate (Less 4th Clutch)	97-01	1	TH700.STK07
Kit	Steel Plate (Less 4th Clutch)	02-ON	1	TH700.STK10
Kit	Steel Plate 3/4 Clutch 0.095"	02-ON	1	TH700.STK09
Kit	3rd & 4th Clutch Improver Kit (Borg Warner)	93-ON	1	TH700.CK01
Kit	3rd & 4th Clutch Improver Kit (Alto)	93-ON	1	TH700.CK02
300B	Reverse Input (129mm ID x 2.00mm x 36T)	93-96	3	TH700.STP01
300B	Reverse Input Oversize (Alto) (129mm ID x 2.28mm x 36T)	93-ON	AR	TH700.STP15
300B	Reverse Input (4 Turbulator Holes) (129mm ID x 2.00mm x 36T)	96-ON	3	4L60E.STP02
300B	Reverse Input (4 Turbulator Holes) (Alto) (129mm ID x 2.00mm x 36T)	96-ON	3	TH700.STP16
301C	Overrun Clutch (108mm ID x 2.30mm x 10T)	93-ON	2	TH700.STP11
302C	Forward Flat 4L60/4L60E (108mm ID x 2.30mm x 20T)	93-ON	4-5	TH700.STP03
303C	3rd & 4th Clutch (Use With TH700.FRP08) (127mm ID x 1.50mm x 20T)	-4/93	AR	TH700.STP10
303C	3rd & 4th Clutch (127mm ID x 2.70mm x 20T)	5/93-ON	5	4L60E.STP03
303C	3rd & 4th Clutch 4L65E (127mm ID x 2.40mm x 20T)	02-ON	6	4L60E.STP06
304D	Low & Reverse (145mm ID x 1.73mm x 17T)	93-97	5	TH350.STP03
304D	Low & Rev Brake 4L60E With Turbulator Holes (145mm ID x 1.25mm x 17T)	97-ON	AR	TH700.STP20
304D	Low & Rev Brake 4L60E With Turbulator Holes (145mm ID x 2.26mm x 17T)	97-ON	AR	TH700.STP05
310B	Rev Input Dished (129mm ID x 1.30mm x 36T)	93-ON	1	TH700.STP08
310B	Rev Input Dished (129mm ID x 1.80mm x 36T)	93-ON	1	4L60E.STP05
310B	Rev Input Dished (129mm ID x 2.20mm x 36T)	93-ON	1	TH700.STP07
311C	Forward Waved (108mm ID x 1.80mm x 20T)	93-3/95	1	TH700.STP04
311C	Forward Waved (108mm ID x 1.80mm x 12T)	4/95-ON	1	4L60E.STP01
PRESSURE & SPACER PLATES				
400B	Reverse Input Clutch (6.7-6.9mm)	93-ON	1	TH700.PP15
401C	Apply Plate, Forward Clutch (4.32mm).....	93-ON	1	TH700.PP08
402C	Forward Clutch (5.87mm).....	93-ON	1	TH700.PP16
402C	Forward Clutch (6.43mm).....	93-ON	1	TH700.PP14
403C	Apply Plate, 3/4 Clutch (3.30mm Flat).....	93-ON	1	TH700.PP04
403C	Apply Plate, 3/4 Clutch (4.00mm Bevelled).....	93-ON	1	TH700.PP05

ILL NO.	DESCRIPTION	YEARS	QTY	PART NO
PRESSURE & SPACER PLATES Cont...				
403C	Apply Plate, 3/4 Clutch (With 5 Steps)	93-ON	1	TH700.PP17
404C	3/4 Clutch 4L60E (4.87mm) (Cast# B)	93-ON	1	TH700.PP10
404C	3/4 Clutch (5.65mm).....	93-ON	1	TH700.PP11
404C	3/4 Clutch (6.0-6.25mm Cast# 2).....	93-ON	1	TH700.PP12
404C	3/4 Clutch (7.0-7.25mm Cast# 1).....	93-ON	1	TH700.PP13
405D	Spacer Plate, Low/ Rev Brake (1.25mm Thick)	93-98	1	TH700.PP02
405D	Spacer Plate, Low/ Rev Brake (2.26mm Thick)	93-98	1	TH700.PP03
405D	Spacer Plate, Low/ Rev Brake (2.46mm Thick)	93-98	1	TH700.PP18
405D	Spacer Plate, Low/ Rev Brake (3.17mm Thick)	93-98	1	TH700.PP19
405D	Spacer Plate, Low/ Rev Brake (1.25mm Thick) With Holes.....	99-ON	1	TH700.PP20
405D	Spacer Plate, Low/ Rev Brake (2.26mm Thick) With Holes.....	99-ON	1	TH700.PP21
SPRINGS & CIRCLIPS				
Kit	Circlip Set (All Circlips)	93-ON	1	TH700.CIR10
410A	Pump Slide Spring, High Output (Sonnax ®, Replaces 2 OEM Springs) (5 Per Pack)	93-ON	1	TH700.SPR04
NI	Spacer, Pump Slide Spring (Performance) (Sonnax® Click here for Info) ...	93-ON	1	4L60E.SP01
NI	Spring, Fits Under Slide Pin.....	93-ON	1	TH700.PUM24
413C	Release Spring Assyembly 3-4 Clutch Load.....	93-ON	5	TH700.SPR09
415C	Return Spring Assembly Overrun Piston	93-ON	1	4L60E.SPR01
416D	Return Spring Assembly Low & Reverse Clutch	93-ON	1	TH700.SPR06
420E	Cushion Spring, Servo Apply Pin.....	93-ON	1	TH700.SPR03
421E	3-4 Accumulator Spring (Purple 5 Pack) (Sonnax® Click here for Info) ...	93-ON	1	4L60E.SPR02
421E	Performance 3-4 Accumulator Spring (Sonnax)	93-ON	1	TH700.ACC13
422E	Spring, 1-2 Accumulator (Purple) Outer	93-ON	1	TH700.ACC03
422E	1-2 Accumulator Spring (Purple 5 Pack) (Sonnax® Click here for Info) ...	93-ON	1	4L60E.SPR02
422E	Spring, 1-2 Accumulator (Red) Outer	93-ON	1	TH700.ACC04
422E	Spring, 1-2 Accumulator (White) Outer	93-ON	1	TH700.ACC05
422E	Spring, 1-2 Accumulator (Orange, Cone Shaped) Outer..	93-ON	1	TH700.ACC06
422E	Spring, 1-2 Accumulator (Yellow) Outer	93-ON	1	TH700.ACC07
422E	Spring, 1-2 Accumulator (Green) Outer.....	93-ON	1	TH700.ACC08
422E	Performance 1-2 Accumulator Spring (Sonnax)	93-ON	1	TH700.ACC13
423E	Return Spring, Band Apply Servo (Silver 30mm Dia x 25mm Long 3 Coils)	93-ON	1	TH700.SPR07
NI	Release Spring Assembly, 3-4 Clutch Load.....	93-ON	1	TH700.SPR01
432C	Circlip, Overrun Piston Return Spring.....	93-ON	1	4L60E.CIR01
445D	Circlip, Low & Reverse Clutch Spring Retainer	93-ON	1	TH700.CIR01

4L60E 93-ON, 4L65E 02-ON, 4L70/75E 06-ON 4 SPEED RWD (Electronic Control)



AUTOMATIC CHOICE



THE AUTOMATIC TRANSMISSION PARTS WAREHOUSE

ILL NO.	DESCRIPTION	YEARS	QTY	PART NO
FILTERS				
450E	Filter.....	93-ON	1	4L60E.FIL01
450E	Filter (Corvette Only) (30mm Spout).....	97-ON	1	4L60E.FIL04
450E	Filter (Light Truck + Van).....	98-ON	1	4L60E.FIL05
450E	Filter (Truck & Van Deep Pan) ..	97-ON	1	4L60E.FIL07
450E	Filter (Chevy Colorado+Canyon)	04-ON	1	4L60E.FIL08
450E	Filter (Hummer).....	06-ON	1	4L60E.FIL08
451E	Shift Solenoid (Small Rectangular) (Snaps on Valve Body Plate)	93-ON	1	4L60E.FIL03
452E	PWM Solenoid (Round) (Snaps on Valve Body Plate)	93-ON	1	4L60E.FIL02
453E	TCC Solenoid (Fits in Solenoid Snout).....	98-ON	1	4L60E.FIL10
BANDS				
500B	Second & Fourth Band (2 Tang) Retros All	93-94	1	TH700.BAN01
500B	Second & Fourth Band (Extra Wide 66.67mm).....	93-94	1	TH700.BAN02
500B	Second & Fourth Band (Wide With Carbon Lining).....	93-ON	1	TH700.BAN03
500B	Second & Fourth Band (Wide High Energy Lining).....	93-ON	1	TH700.BAN04
500B	Second & Fourth Band (Alto) (Heavy Duty Red Lining).....	93-ON	1	TH700.BAN05
500B	Second & Fourth Band 4L60E (2 Tang) (Hi-Energy Lining).....	95-ON	1	4L60E.BAN01
BUSHINGS				
Kit	Stator Bushings.....	93-ON	1	TH700.BUS15
550A	Front Pump Bush (Babbitt)	93-ON	1	TH700.BUS01
550A	Front Pump Bush (Dura Life)....	93-ON	1	TH700.BUS03
551A	Stator (Front) 25.40mm ID.....	93-ON	1	TH700.BUS06
553B	Reverse Input Housing (Front) ..	93-ON	1	TH700.BUS12
554B	Reverse Input Housing (Rear) ..	93-ON	1	TH700.BUS13
556C	Input Sun Gear (Front).....	93-ON	1	TH700.BUS07
557C	Input Sun Gear (Rear)	93-ON	1	TH700.BUS07
558C	Reaction Carrier Shaft (Front)...	93-ON	1	TH700.BUS08
559C	Reaction Carrier Shaft (Rear) ...	93-ON	1	TH700.BUS09
560D	Reaction Sun Gear	93-ON	1	TH700.BUS10
560D	Reaction Sun Gear (Wide) (Sonnax)	93-ON	1	TH700.BUS14
564E	Case Bronze	93-ON	1	TH700.BUS05
564E	Case Oversize (Sonnax).....	93-ON	1	4L60E.BUS10
565E	Extension Housing Babbitt.....	93-ON	1	TH700.BUS02
565E	Extension Housing (Teflon Coated)	93-ON	1	4L60E.BUS09
THRUST WASHERS & BEARINGS				
Kit	Thrust Washer Kit	93-ON	1	TH700.TWK01
Kit	Thrust Bearing Kit	93-ON	1	TH700.TWK02
Kit	End Play Shim Kit (Sonnax Contains 10 x 0.38mm Shims for Adjusting Front End Play)	93-ON	AR	TH700.TWK03
Kit	End Play Shim Kit (Sonnax Contains 10 x 0.254mm Shims for Adjusting Rear Unit End Play)	93-ON	AR	TH700.TWK04
600B	Pump to Reverse Drum	93-ON	1	TH700.THW01
604C	Reaction Shaft to Shell (Brass). ..	93-01	1	TH700.THW14
604C	Reaction Shaft to Shell, (The Beast)	93-01	1	TH700.THW03

ILL NO.	DESCRIPTION	YEARS	QTY	PART NO
THRUST WASHERS & BEARINGS Cont...				
604C	Reaction Shaft to Shell (Bearing Type) (4L65E)	02-ON	1	4L60E.TOR02
605D	Rear One Way Clutch Race To Driving Shell Washer.....	93-ON	1	TH700.THW19
650B	Stator Support to Input Drum Bearing.....	93-ON	1	TH700.THW02
651C	Input Drum to Sun Gear.....	93-ON	1	TH700.THW11
653C	Input Carrier to Reaction Shaft Bearing	93-ON	1	TH700.THW18
653C	Input Carrier to Reaction Shaft Bearing (4L65E)	01-ON	1	4L60E.TOR01
654D	Rear Planet to Support	93-ON	1	TH700.THW16
655D	Reaction Gear Support To Case Bearing	93-ON	1	TH700.THW18
ELECTRICAL COMPONENTS				
Kit	Solenoid, Master Kit (Manifold Press Switch Not Included).....	93-95	1	4L60E.SOL10
Kit	ECM Harness Repair Kit.....	93-ON	1	4L60E.ELE08
Kit	Inhibitor Switch Repair Kit.....	95-ON	1	4L60E.ELE10
Kit	External Harness Repair Kit (13 Wire, Plugs into Connector) ..	93-98	1	4L60E.ELE12
Kit	External Harness Repair Kit (20 Pin, Universal)	93-ON	1	4L60E.ELE17
701E	Vehicle Speed Sensor (VSS) (Also 96 Corvette)	93-E96	1	4L60E.ELE04
701E	Vehicle Speed Sensor (VSS) (Exc 96 Corvette)	L96-ON	1	4L60E.ELE06
702E	Solenoid, (TCC Control PWM) (Gray Connector)	95-ON	1	4L60E.SOL01
703E	Solenoid, (3-2 Down Shift) (PWM) Round (Front) (Gray Connector)	93-95	1	4L60E.SOL01
703E	Solenoid, (3-2 Down Shift) (Teckpack) 4L60E	93-95	1	4L60E.SOL02
703E	Solenoid, (3-2 Down Shift) (On-Off) (White Connector).....	96-ON	1	4L60E.SOL05
704E	Solenoid, Pressure Control (EPC) (Borg Warner)	93-02	1	4L30E.SOL01
704E	Solenoid, Pressure Control (EPC)	03-ON	1	4L60E.SOL06
NI	Bracket, EPC Solenoid (Second Design)	93-ON	1	TH700.RET01
705E	Solenoid, 'B' 1-2 & 3-4 Shift)	93-ON	1	4L60E.SOL04
705E	Solenoid, 'B' 1-2 & 3-4 Shift (Teckpack).....	93-ON	1	4L60E.SOL03
706E	Solenoid, 'A' 2-3 Shift.....	93-ON	1	4L60E.SOL04
706E	Solenoid, 'A' 2-3 Shift (Teckpack).....	93-ON	1	4L60E.SOL03
707E	Solenoid, TCC Universal (Teckpack).....	93-ON	1	TH700.SOL03
707E	Solenoid, TCC PWM Type (Round) (Front)	95-ON	1	4L60E.SOL01
707E	Solenoid, TCC & Wire Harness, (Replaces All 93-96 OE Harnesses).....	93-02	1	4L60E.ELE05
707E	Solenoid, TCC With Harness (Olive Green Connector).....	94-95	1	4L60E.ELE15
707E	Solenoid, TCC With Harness....	03-ON	1	4L60E.ELE09
707E	Solenoid, TCC With Harness....	06-ON	1	4L60E.ELE14
705E	Replacement TCC Solenoid Snout (Aluminium Non PWM Sonnax)	93-ON	1	TH700.SOL05
705E	Replacement TCC Solenoid Snout (Aluminium PWM Sonnax).....	95-ON	1	TH700.SOL06
709E	Manifold Pressure Switch	93-ON	1	4L60E.ELE02

4L60E 93-ON, 4L65E 02-ON, 4L70/75E 06-ON 4 SPEED RWD (Electronic Control)



AUTOMATIC CHOICE



THE AUTOMATIC TRANSMISSION PARTS WAREHOUSE

ILL NO.	DESCRIPTION	YEARS	QTY	PART NO
ELECTRICAL COMPONENTS Cont...				
710E	Switch, Park/Neutral, Backup (Single Plug 11 Pin)	04-ON	1	4L60E.ELE07
NI	Switch, MLP Sensor (PRNDL)	93-03	1	4L60E.ELE03
NI	Turbine Speed Sensor (4L60E/4L65E)	06-ON	1	4L60E.ELE13
NI	Speed Sensor Harness Repair Kit	93-ON	1	4L80E.ELE06
VALVE BODY PARTS				
750E	Plate, Valve Body (Universal - Replaces All 4L60E Codes JV-LE) (Transgo)	93-94	1	TH700.VB13
750E	Plate, Valve Body (Universal - Replaces All 4L60E Codes MP-NH) (Transgo)	1995	1	TH700.VB14
750E	Plate, Valve Body (Universal - Replaces All 4L60E Codes PA-SD) (Transgo)	96-01	1	TH700.VB15
750E	Plate, Valve Body (Bonded) (V8 Engine) (4L60E, 4L70E, 4L75E)	06-ON	1	4L60E.GAS08
751E	Valve Body 4L60E (Remanufactured) (Cut Corner, Offset EPC)	04-ON	1	4L60E.VB06
Kit	Valve Body Shift Kit®, 4L60E (Transgo Junior)	93-ON	1	4L60E.SK01
Kit	Boost Valve & Sleeve Kit, With 'O' Rings (12.45mm Sonnax)	93-ON	1	4L60E.VA04
Kit	TCC Regulator Valve Kit (Sonnax)	93-97	1	4L60E.VA05
Kit	TCC Regulator Valve Kit (Sonnax)	97-ON	1	4L60E.VA06
NI	Reamer (Sonnax) Needed For (4L60E.VA05 & VA06) Above (Use for Non GM Serviced Valve Bodies Only)	93-ON		4L60E.TOOL02
NI	Reamer (Sonnax) Needed For (4L60E.VA05 & VA06) Above (Use with GM Serviced Valve Bodies Only "SERV" Stamped Near Casting No)	93-ON		4L60E.VA16
Kit	Boost Valve & Sleeve Kit (Sonnax) With 'O' Rings (11.93mm)	93-ON	1	4L60E.VA07
Kit	Actuator Feed limit valve Kit (Sonnax)	93-ON	1	4L60E.VA08
Kit	Reamer Kit for 4L60E.VA08 (Sonnax)	93-ON		4L60E.VA09
Kit	Check Ball Repair Kit, Fixes 5 Valve Body Plate Holes Most w/ 1/4" Check Balls	93-ON	1	TH700.VB11
Kit	4L60E, 3-4 Relay Valve Plug and 'O' Ring Kit (Sonnax) .	93-ON	1	4L60E.PLU01
Kit	4L60E, Reverse Boost Valve Oversize (12.446mm) (Factory Style, Sonnax ®)	93-ON	1	4L60E.VA11
Kit	4L60E, 4-3 Sequence Valve Oversize Req 4L60E.VA15 Reamer to Fit (Sonnax)	93-ON	1	4L60E.VA14
Kit	Reamer for 4L60E.VA14	93-ON	1	4L60E.VA15
Kit	TCC Upgrade for SRTA/GM Rebuilt Valve Bodies	95-ON	1	4L60E.VA18
Kit	Forward + Reverse Abuse Valve Kit (4L60E/4L65E) (Sonnax®)	93-ON	1	4L60E.VA19
Kit	Reverse Boost Valve & Sleeve (4L65E, 4L70E) (Oversized 12.446mm EPC spool diameter for late pumps) (Sonnax® Click Here for Info) ...	93-ON	1	4L60E.VA21

ILL NO.	DESCRIPTION	YEARS	QTY	PART NO
VALVE BODY PARTS Cont...				
Kit	Isolator Valve Sleeve & Clip (Requires Reamer 4L60E.VA22) (Sonnax® Click Here for Info) ...	93-ON	1	4L60E.VA17
Kit	Reamer for 4L60E.VA17 (Sonnax® Click Here for Info) ...	93-ON	1	4L60E.VA22
NI	Pinless Forward Accumulator Piston (Sonnax®)	93-ON	1	TH700.ACC16
NI	Forward Accumulator Piston (Aluminium to Replace Plastic) .	93-ON	1	TH700.ACC17
Kit	Pressure Regulator Valve 4L60E (Sonnax) Requires Use of TH700.TOOL01 Reamer	93-ON	1	4L60E.VA02
Kit	Line Pressure Booster Kit (Long) (4L60E, 4L65E, 4L70E) (Sonnax® Click here for Info) ...	93-ON	1	4L60E.VA25
Kit	Line Pressure Booster Kit (Short) (4L60E, 4L65E, 4L70E) (Sonnax® Click here for Info) ...	93-ON	1	4L60E.VA26
NI	TCC Apply Valve, Aluminium with Teflon® Seal (Sonnax)	93-ON	1	4L60E.VA03
NI	Wiring Harness Connector Bracket (Sonnax)	93-ON	1	4L60E.VA12
NI	TCC Apply Valve (Sonnax) (4L60E Non PWM)	93-ON	1	TH700.VA04
NI	Accumulator Valve Train Assy (8.00mm Dia Light Vehicles) (Sonnax)	93-ON	1	TH700.VA07
NI	Accumulator Valve Train Assy (8.382mm Dia Medium Vehicles) (Sonnax)	93-ON	1	TH700.VA08
NI	Accumulator Valve Train Assy (8.661mm Dia Heavy Vehicles) (Sonnax)	93-ON	1	TH700.VA09
NI	Check Valve, Servo Release (Sonnax)	93-ON	1	TH700.VA12
NI	Plate Saver, (Inserts Between Accumulator Cover to Valve Body Plate)	93-ON	1	TH700.VB10
NI	2-2 Control Valve Spring (4L60E) (Sonnax™)	93-ON	1	TH700.VA20
NI	3-2 Control/Reverse Abuse Bore Plug (Sonnax ®)	93-ON	1	4L60E.VA13
NI	Low-Overrun/Forward Abuse Bore Plug (Sonnax ®)	93-ON	1	4L60E.VA13
NI	Aluminium 2-3 Shift Valve (Sonnax® Click Here for Info) ...	93-ON	1	4L60E.VA20
NI	Performance 2-3 Shift Valve (Sonnax® Click Here for Info) ...	93-ON	1	4L60E.VA24
Vacuum Test Point Locations (Sonnax®)				
HARD PARTS				
800A	Pump, (1 Piece Case) Non PWM	93-94	1	4L60E.PUM01
800A	Pump, (1 Piece Case) PWM	94-96	1	4L60E.PUM03
800A	Pump, (2 Piece Case) (298mm Converter)	96-E04	1	4L60E.PUM04
800A	Pump, (Without 'O' Ring) (298mm Converter)	04-ON	1	4L60E.PUM06
800A	Pump, (2 Piece Case) (310mm Converter)	97-E04	1	4L60E.PUM05
800A	Pump, (Without 'O' Ring) (310mm Converter)	04-ON	1	4L60E.PUM07

4L60E 93-ON, 4L65E 02-ON, 4L70/75E 06-ON 4 SPEED RWD (Electronic Control)



AUTOMATIC CHOICE



THE AUTOMATIC TRANSMISSION PARTS WAREHOUSE

ILL NO.	DESCRIPTION	YEARS	QTY	PART NO
HARD PARTS Cont...				
800A	Pump, (4L65E) (With Input Speed Sensor Hole and 177.80mm Stator)	06-ON	1	4L60E.PUM12
800A	Pump, (4L65E) (With Input Speed Sensor Hole and 165.10mm Stator)	06-ON	1	4L60E.PUM13
801A	Pump Slide, Aftermarket (17.955mm) (For 13 Vane Rotor) 4L60E	97-ON	1	TH700.PUM18
801A	Pump Slide, OEM (17.968mm) (For 13 Vane Rotor) 4L60E	97-ON	1	TH700.PUM04
802A	Rotor Kit, 10 Vane (17.95mm Rotor) (Heavy Duty)	93-96	1	TH700.PUM02
803A	Rotor Kit, 13 Vane (17.967mm) (With Slide)	97-ON	1	4L60E.PUM02
803A	Rotor Kit, 13 Vane (17.967mm OEM) (Without Slide #801)	97-ON	1	4L60E.PUM08
804A	Ring, Pump Rotor to Vane (Black Steel)	93-ON	2	TH700.PUM03
805A	Vane Kit (Package of 13)	93-ON	1	TH700.PUM08
806A	Rotor Guide, 10 Vane	93-96	1	TH700.PUM16
806A	Rotor Guide, 13 Vane	97-ON	1	TH700.PUM19
807A	Vane & Ring Kit, (10 Vane, Heavy Duty)	93-96	1	TH700.PUM13
808A	Stator Support Shaft (Sonnax) (298mm Converter)	93-98	1	TH700.PUM14
809A	Rotor, 10 Vane	93-96	1	TH700.PUM15
809A	Rotor, 13 Vane (17.957mm Thick)	97-ON	1	TH700.PUM20
NI	Pin, Pump Slide Pivot (Sonnax)	93-ON	1	TH700.PUM17
810B	Drum, Reverse Input (No Check Ball) (Large Feed Hole)	93-ON	1	4L60E.DRU01
810B	Drum Assy, Reverse Input (Replacement Kit)	93-ON	1	TH700.DRU04
811C	Input & Shaft w/ Pilot, (Exc 2.8L or 4 Cyl) (298mm/ 30 Spl Converter)	93-97	1	TH700.DRU03
811C	Input & Shaft no Pilot, (2.8L & 4 Cyl) (245mm/ 27 Spl Converter)	93-97	1	TH700.DRU06
811C	Input & Shaft (30 Spline 'O' Ring Behind Spline)	98-ON	1	4L60E.DRU03
812C	Apply Ring, 3-4 Clutch (5 Fingers) ...	82-93	1	TH700.RET06
Kit	Input Drum Reinforcement Sleeve, Seal & Piston Kit (Sonnax® Click Here for Info) ...	93-ON	1	4L60E.PIS06
815C	Sprag, Forward Clutch (29 Elements, Dual Cage)	93-ON	1	TH700.OWC04
818C	Sprag Assembly, Forward Clutch (29 Elements, Includes Sprag) ..	93-E95	1	TH700.OWC16
818C	Sprag Assembly, Forward Clutch (29 Elements, Includes Sprag & Sun Gear #824C)	L95-ON	1	TH700.OWC03
824C	Sun Gear, Input (Front)	93-ON	1	TH700.SUN01
825C	Front Planetary (w/ Batwing Washers) (4 Pinion)	93-ON	1	TH700.PL01
825C	Front Planetary (5 Pinion, Retro Fits All)	93-00	1	TH700.PL09
825C	Front Planetary Kit (5 Pinion, With Shaft)	01-ON	1	TH700.PL10
826C	Ring Gear, Front Planet (34.92mm Long Clutch Spline) ..	93-ON	1	TH700.PL07
827C	Hub w/ Shaft, Reaction Carrier (Use With 4L60E.TOR02)	93-ON	1	4L60E.PL03
828D	Shell, Reaction Sun (Std) (Washer Type)	93-01	1	TH700.POT01
828D	Shell, Reaction Sun (Hardened) (Washer Type)	93-01	1	TH700.POT02

ILL NO.	DESCRIPTION	YEARS	QTY	PART NO
HARD PARTS Cont...				
828D	Shell, Reaction Sun (Hardened) (Bearing Type)	02-ON	1	TH700.POT03
828D	Shell, Reaction Sun (Smart Shell®) (Sonnax® Click here for Info) ..	02-ON	1	TH700.POT04
829D	Sun Gear, Reaction (Rear)	93-ON	1	TH700.SUN02
830D	Inner Race, Low/Rev OWC	93-ON	1	TH700.OWC05
833D	Sprag, Low/ Reverse (Wide Plastic Cage)	93-96	1	TH700.OWC01
834aD	Inner & Outer Races Low/Rev Late Wide Type	93-ON	1	TH700.OWC15
834bD	Centre Support Assy Late Wide Sprag Type	93-ON	1	TH700.SUP01
835D	Rear Planetary (with Bat Wing Washers & with Oil Slinger) (Can Use TH700.PL06)	93-ON	1	TH700.PL05
835D	Rear Planetary (with Bat Wing Washers without Oil Slinger) (Can Use TH700.PL05)	93-ON	1	TH700.PL06
835D	Rear Planetary (5 Pinion) (Retrofits)	93-ON	1	TH700.PL08
NI	Repair Kit, Rear Planetary (Sonnax® Click here for Info) ...	82-93	1	TH700.PL11
837D	Ring Gear, Rear (Hardened)	93-ON	1	TH700.PL02
838D	Hub, Support Internal Reaction Gear Late (Cut For Oil Slinger) ..	93-ON	1	TH700.PL04
841D	Reluctor Ring Speed Sensor (40Teeth)	93-ON	1	TH700.GE02
843D	Piston, Low/ Reverse Clutch (Aluminium)	93-ON	1	4L60E.PIS04
844D	Reverse Piston Kit (Exc 2.8)	93-ON	1	TH700.PIS04
845E	Servo Assembly, 2-4 (Cast D758 # 8642093) (Corvette) High Output	93-ON	1	TH700.SER01
845E	Servo Assembly, 2-4 (Cast # 553) Medium Output	93-ON	1	TH700.SER02
845E	Servo Assembly, 2-4 (Cast # 554) Low Output	93-ON	1	TH700.SER03
847E	Piston, 4th Servo (Super Hold) (Sonnax®)	93-ON	1	TH700.ACC11
Kit	Replacement Seal Kit for Sonnax 4th Gear "Super Hold" Servo (TH700.SER04)	93-ON	1	TH700.SRK05
848E	2nd Gear Super Hold Servo Assy (Sonnax®)	93-ON	1	TH700.ACC19
848E	2nd Gear Small Size Servo	93-ON	1	TH700.SER08
848E	2nd Gear Super Servo (Superior ®)	93-ON	1	TH700.SER07
848E	Piston 2nd Servo (4L70E)	06-ON	1	4L60E.SER01
850E	Pin, 2nd Apply (1 Ring)	93-ON	AR	TH700.PIN01
850E	Pin, 2nd Apply (2 Ring)	93-ON	AR	TH700.PIN02
850E	Pin, 2nd Apply (3 Ring, & 1 Wide Band)	93-ON	AR	TH700.PIN03
853E	Detent/Selector Shaft	93-ON	1	4L60E.SH01
855E	Repair Kit, 3-4 Accumulator (Repair Sleeve, Piston & Pin) (Sonnax)	93-ON	1	TH700.SL01
856E	Pin & Reamer Kit 1-2 & 3-4 Accumulator (10 Pins & 1 Reamer)	93-ON	AR	4L60E.PIN02
856E	Pin, 1-2 & 3-4 Accumulator (Oversize) (Requires Reamer in 4L60E.PIN02) (Sonnax Pack of 4)	93-ON	AR	4L60E.PIN01
857E	Piston Kit, 1-2 Accumulator (5.84mm Pin Dia)	93-ON	1	TH700.ACC10
857E	Piston Aluminium, 1-2 Accumulator (5.99mm Pin Dia)	03-05	1	TH700.ACC18
859E	Cooler, Transmission Pan Type (Derale)	93-ON	1	TH700.PAN02

4L60E 93-ON, 4L65E 02-ON, 4L70/75E 06-ON 4 SPEED RWD (Electronic Control)



AUTOMATIC CHOICE



THE AUTOMATIC TRANSMISSION PARTS WAREHOUSE

ILL NO.	DESCRIPTION	YEARS	QTY	PART NO
HARD PARTS Cont...				
861B	Piston, Reverse Input Clutch (Aluminium 3 Plate Units)	93-96	1	TH700.PIS01
NI	Kit, 1-2 & 3-4 Pin less Accumulator Piston (Sonnax) ...	93-ON	1	TH700.ACC14
NI	Second Apply Servo Kit (Sonnax ®).....	93-ON	1	TH700.SER06
SPECIAL ITEMS				
900A	Retainer, (Front Seal Lock)	93-ON	1	TH700.RET03
901E	Connector, Cooler Line (Push In)	96-ON	2	4L60E.CON01
902E	Filler Tube & Dip Stick, Fitz All (Teckpak)	93-ON	1	TH700.TUB01
903E	Metal Case Breather	93-ON	1	TH700.BRE02
NI	Capsule, Reverse Piston (Package of 10).....	93-ON	AR	TH700.CAP01
NI	Capsule w/ Ck Ball, Input Drum (Fits In Turbine Shaft)	93-ON	1	TH700.CAP02
NI	Vacuum Pressure Control Kit (4L60E) (Replace Force Motor with Vacuum Modulator)	93-ON	1	4L60E.MOD01
NI	Capsule w/ Ck Ball, Under Low/ Reverse Piston	93-ON	1	TH700.VA11
NI	Check Valve, Servo Release (Sonnax)	93-ON	1	TH700.VA12
Kit	Bolt Kit Bel Housing to Case (Contains 8 Bolts)	93-ON	1	4L60E.NUT01
TOOLS & MANUALS				
NI	ATSG Rebuild Manual (4L60E)	93-ON		4L60E.MAN01
NI	ATSG Update Manual (4L60E)	93-ON		4L60E.MAN02
NI	ATSG Diagnostic Manual (4L60E/4L80E)	93-On		4L60E.MAN04
Click here to view special tools for this transmission				

ILL NO.	DESCRIPTION	YEARS	QTY	PART NO