

# TURBO HYDRAMATIC 400 (3L80, M-40)

## 3 SPEED RWD



AUTOMATIC CHOICE



THE AUTOMATIC TRANSMISSION PARTS WAREHOUSE

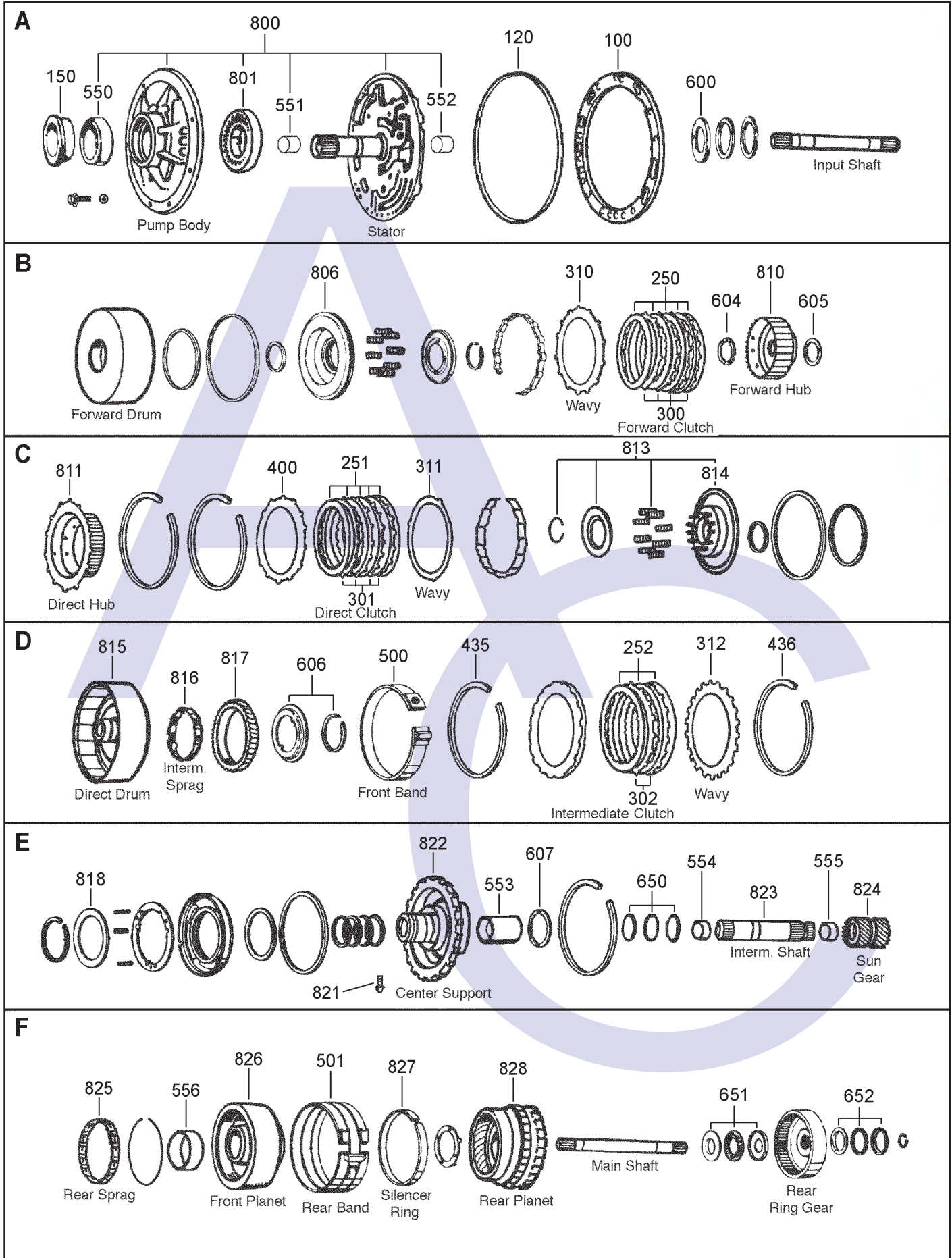

# TURBO HYDRAMATIC 400 (3L80, M-40)

## 3 SPEED RWD



AUTOMATIC CHOICE



THE AUTOMATIC TRANSMISSION PARTS WAREHOUSE

G

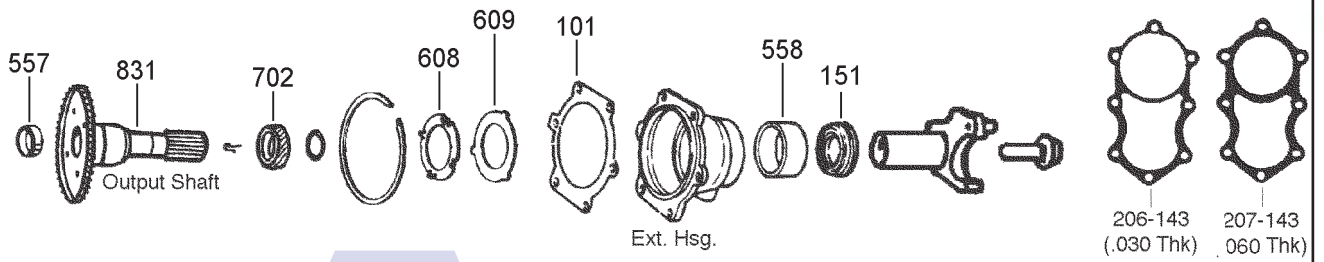

H

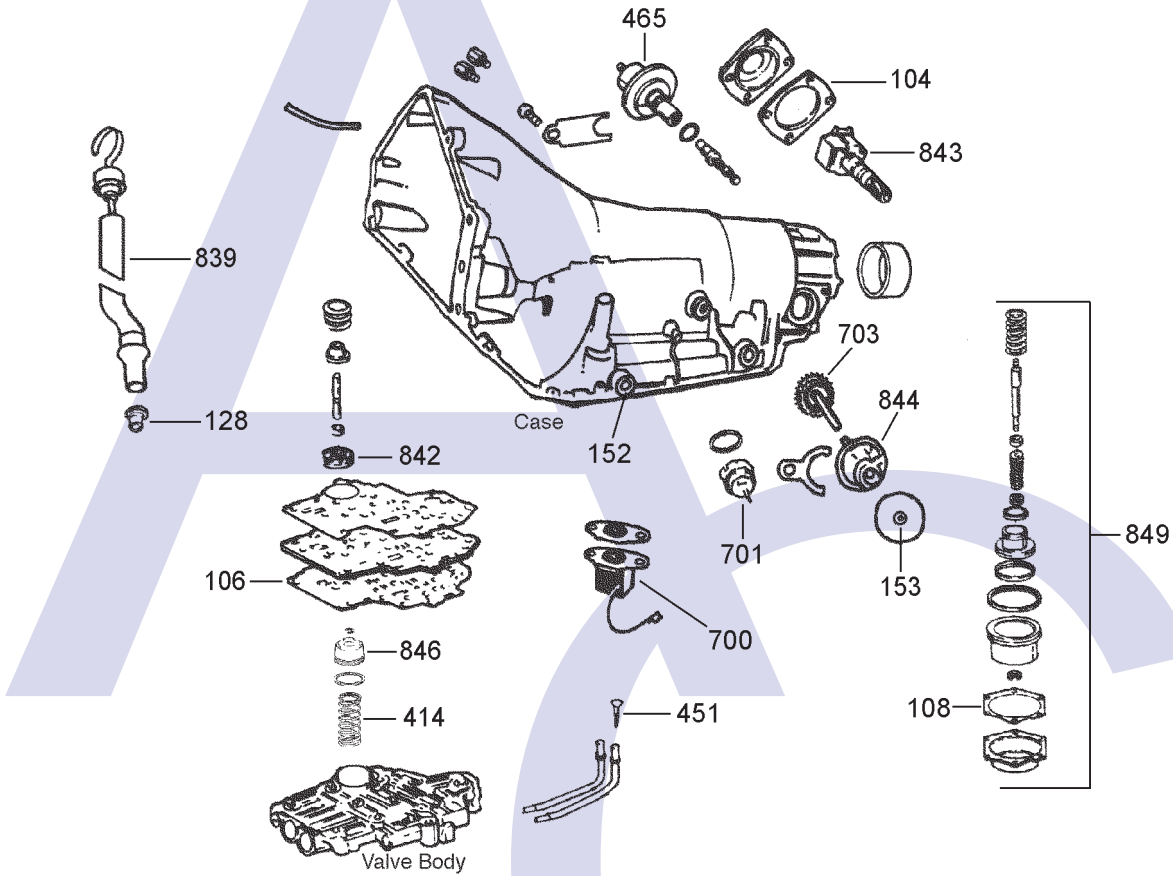

J

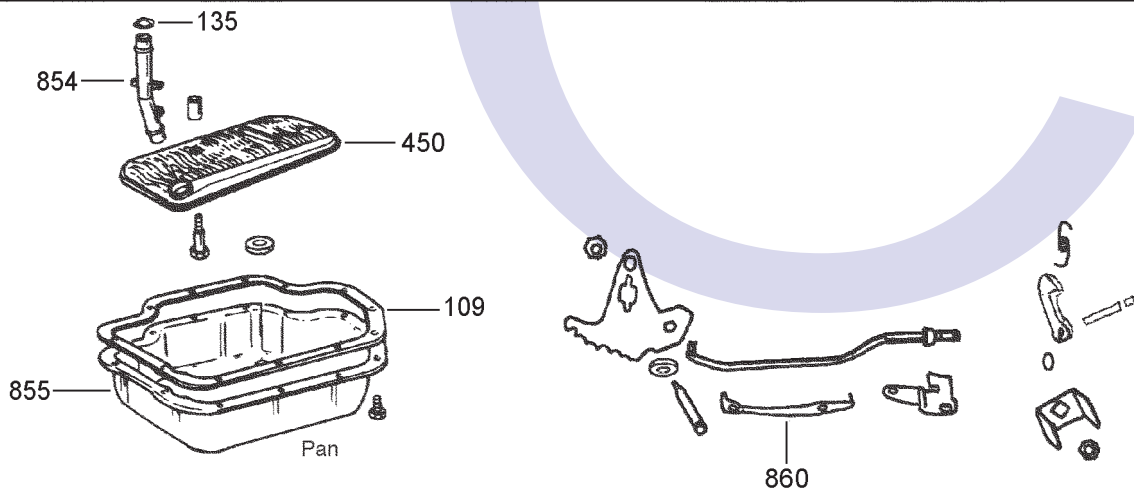

# TURBO HYDRAMATIC 400 (3L80, M-40)

## 3 SPEED RWD



AUTOMATIC CHOICE



THE AUTOMATIC TRANSMISSION PARTS WAREHOUSE

ILL NO.	DESCRIPTION	YEARS	QTY	PART NO
<b>KITS</b>				
Kit	Super Overhaul Kit.....	64-98	1	TH400.SOHK01
Kit	Banner Kit (Includes Frictions)..	64-98	1	TH400.BAK01
Kit	Overhaul Kit (Transtec).....	64-98	1	TH400.OHK01
Kit	Gasket & Rubber Kit .....	64-98	1	TH400.GSK01
<b>GASKETS</b>				
100A	Front Pump Gasket.....	64-98	1	TH400.GAS02
101G	Extension Housing Gasket.....	64-98	1	TH400.GAS03
104H	Governor Cover Gasket.....	64-98	1	TH400.GAS04
106H	Valve Body to Spacer Plate (7 Check Ball Type).....	L87-98	1	TH400.GAS05
108H	Low/Reverse Servo Cover.....	64-98	1	TH400.GAS06
109J	Pan Gasket TH400 .....	64-98	1	TH400.GAS01
109J	Pan Gasket (Fibre).....	64-98	1	TH400.GAS10
<b>RUBBER COMPONENTS</b>				
120A	Front Pump O Ring TH400 .....	64-98	1	TH400.SQR01
128H	Filler Tube Seal Multi Lip.....	64-98	1	TH125.LIP03
128H	Filler Tube Seal 'O' Ring (Rolls Royce) .....	64-98	1	TH400.OR03
135J	O-Ring, Filter Pick-Up Tube .....	64-98	1	TH400.OR02
<b>METAL CLAD SEALS</b>				
150A	Front Pump Seal.....	64-98	1	TH400.MCS03
151H	Ext Housing (63.53mm O.D).....	64-98	1	TH400.MCS02
151H	Ext Housing (68.60mm O.D).....	64-98	1	TH400.MCS01
151H	Ext Housing (73.15mm O.D) Motor Home. ....	64-98	1	TH400.MCS04
152H	Selector Shaft .....	64-98	1	TH180.MCS03
153H	Speedo Driven Gear Shaft (With Spring) .....	64-98	1	TH180.MCS04
153H	Speedo Driven Gear Shaft (Without Spring) .....	64-98	1	TH180.MCS05
<b>SEALING RINGS</b>				
Kit	Sealing Ring (Steel 10 Rings)...	64-98	1	TH400.SRK01
Kit	Sealing Ring (Teflon).....	64-98	1	TH400.SRK02
<b>FRICITION &amp; STEEL KITS</b>				
Kit	Friction & Steel, Forward Clutch (Alto Red Eagle™).....	64-98	1	TH400.CK51
Kit	Friction & Steel, Direct Clutch (Alto Red Eagle™) .....	64-98	1	TH400.CK52
Kit	Friction & Steel, Intermediate Clutch (Alto Red Eagle™).....	64-98	1	TH400.CK53
<b>FRICITION PLATES</b>				
Kit	Friction Plate .....	64-98	1	TH400.FRK01
Kit	Friction Plate (Alto) .....	64-98	1	TH400.FRK51
Kit	Friction Plate (Alto) (High Performance).....	64-95	1	TH400.FRK61
Kit	Friction Plate (Alto) (With Heg Frictions) .....	64-95	1	TH400.FRK62
250B	Forward Clutch (Smooth) (150mm OD x 2.00mm x 42T) ..	64-98	5	TH400.FRP01
250B	Forward Clutch (Smooth) (Alto) (150mm OD x 2.00mm x 42T) ..	64-98	5	TH400.FRP51

ILL NO.	DESCRIPTION	YEARS	QTY	PART NO
<b>FRICITION PLATES Cont...</b>				
250B	Forward Clutch (Waffle) (150mm OD x 2.00mm x 42T) ..	64-98	5	TH400.FRP03
250B	Forward Clutch (Radial Groove) (150mm OD x 2.00mm x 42T) ..	64-98	5	TH400.FRP05
251C	Direct Clutch (Smooth) (150mm OD x 2.00mm x 42T) ..	64-98	5	TH400.FRP01
251C	Direct Clutch (Waffle) (150mm OD x 2.00mm x 42T) ..	64-98	5	TH400.FRP03
252D	Intermediate (Smooth Waved) (167mm OD x 2.00mm x 47T) ..	64-98	3	TH400.FRP02
252D	Intermediate (Waffle Flat) (167mm OD x 2.00mm x 47T) ..	64-98	3	TH400.FRP04
<b>STEEL PLATES</b>				
Kit	Steel Plate Kit .....	64-98	1	TH400.STK01
Kit	Steel Plate Kit (Alto).....	64-98	1	TH400.STK51
Kit	Steel Plate Kit (Alto) (High Performance) With Turbulator Steels) .....	64-95	1	TH400.STK61
300B	Forward Clutch Flat (116mm ID x 1.96mm x 12T) ....	64-98	4-5	TH400.STP02
300B	Forward Clutch Flat (116mm ID x 2.30mm x 12T) ....	64-98	AR	TH400.STP03
301C	Direct Clutch Flat (116mm ID x 1.96mm x 12T) ....	64-98	4-5	TH400.STP02
301C	Direct Clutch Flat (116mm ID x 2.30mm x 12T) ....	64-98	4-5	TH400.STP03
302D	Intermediate Clutch (127mm ID x 2.54mm x 21T) ....	64-98	3	TH400.STP04
310B	Forward Clutch Waved (116mm ID x 1.52mm x 12T) ....	64-98	1	TH400.STP06
310B	Forward Clutch Waved (Alto) (116mm ID x 1.52mm x 12T) ....	64-98	1	TH400.STP07
310B	Forward Clutch Dished Steel (2 Tangs).....	65-98	1	TH400.DIA01
311C	Direct Clutch Waved (116mm ID x 1.52mm x 12T) ....	64-98	1	TH400.STP06
311C	Direct Clutch Waved (Alto) (116mm ID x 1.52mm x 12T) ....	64-98	1	TH400.STP07
311C	Direct Clutch Dished Steel (2 Tangs).....	65-98	1	TH400.DIA01
312D	Intermediate Waved (127mm ID x 1.78mm x 21T) ....	64-98	1	TH400.STP05
<b>PRESSURE PLATES</b>				
400C	Direct Clutch .....	64-98	1	TH400.PP01
<b>SPRINGS &amp; CIRCLIPS</b>				
Kit	Snap Ring .....	64-90	1	TH400.CIR10
Kit	Snap ring.....	64-98	1	TH400.SRK03
414H	Spring, Accumulator (Yellow) ....	65-98	1	TH400.SPR02
435D	Circlip, Intermediate Clutch (Outer).....	91-ON	1	4L80E.CIR05
436D	Circlip, Intermediate Clutch (Inner) .....	91-ON	1	4L80E.CIR06
<b>FILTERS</b>				
450J	Pan Filter.....	64-E67	1	TH400.FIL03
450J	Pan Filter.....	L67-98	1	TH400.FIL01
451H	Conical Governor Screen.....	64-98	1	TH400.FIL02



# TURBO HYDRAMATIC 400 (3L80E, M-40)

## 3 SPEED RWD



AUTOMATIC CHOICE



THE AUTOMATIC TRANSMISSION PARTS WAREHOUSE

ILL NO.	DESCRIPTION	YEARS	QTY	PART NO
<b>MODULATORS</b>				
465H	Modulator Adjustable (Red Stripe).....	64-98	1	TH350.MOD01
465H	Modulator Large Black Canister (Replaced By TH350.MOD01) ..	64-98	1	TH400.MOD02
<b>BANDS</b>				
500D	Intermediate Overrun (Front) ....	64-98	1	TH400.BAN01
500D	Intermediate Overrun (Front) (Alto High Performance) .....	64-98	1	TH400.BAN05
501F	Low & Reverse (New) .....	64-98	1	TH400.BAN02
501F	Low & Reverse (Reline) .....	64-98	1	TH400.BAN03
501F	Low & Reverse (Kevlar®) .....	64-98	1	TH400.BAN06
<b>BUSHES</b>				
Kit	Bush Kit (Less Extension Bush)	64-98	1	TH400.BK01
Kit	Bush Kit (Inc. Extension Bush) .	64-98	1	TH400.BK02
550A	Front Pump Bush .....	64-98	1	TH180.BUS01
550A	Front Pump Bush (PTFE Lined) (Sonnax® <a href="#">Click here for Info</a> ) .	64-98	1	TH180.BUS02
551A	Stator Support Front .....	64-98	1	TH400.BUS07
552A	Stator Support Rear .....	64-98	1	TH400.BUS07
553E	Centre Support.....	64-98	1	TH400.BUS03
554E	Sungear Shaft Front.....	64-98	1	TH400.BUS07
555E	Sungear Shaft Rear .....	64-98	1	TH400.BUS07
556F	Planetary Carrier.....	64-98	1	TH400.BUS05
557G	Output Shaft (10.40mm Wide) ..	74-98	1	TH400.BUS06
558G	Extension Housing (50.67mm OD x25.40mm Long)	64-98	1	TH400.BUS02
558G	Extension Housing (50.67mm OD x38.10mm Long)	64-98	1	TH400.BUS04
558G	Extension Housing (45.60mm OD x31.50mm Long)	64-98	1	TH400.BUS08
NI	Governor Bore Repair Sleeve (Requires Special Tool).....	64-98	AR	TH350.BUS02
<b>THRUST BEARINGS &amp; WASHERS</b>				
Kit	Thrust Washer Kit .....	64-98	1	TH400.TWK01
Kit	Thrust Bearing Kit .....	64-98	1	TH400.TWK02
600A	Front Pump Selective (2.41mm Thick) .....	64-98	AR	TH400.THW04
	Selective (2.69mm Thick) .....	64-98	AR	TH400.THW05
	Selective (2.97mm Thick) .....	64-98	AR	TH400.THW06
	Selective (3.25mm Thick) .....	64-98	AR	TH400.THW07
604B	Forward Clutch Hub to Forward Clutch Housing .....	64-98	1	TH400.THW08
605B	Forward Clutch Hub to Direct Clutch Housing .....	64-98	1	TH400.THW09
605B	Forward Clutch Hub to Direct Clutch Housing (Sonnax®) (1.98mm 5 Pack).....	64-98	1	TH400.THWK04
605B	Forward Clutch Hub to Direct Clutch Housing (Sonnax®) (2.39mm 5 Pack).....	64-98	1	TH400.THWK03
606D	Race/Retainer, Intermediate One Way Clutch (with Circlip) ...	64-98	1	TH400.THW22
607E	Center Support to Front Planet (Metal).....	64-98	1	TH400.THW10
608G	Output Shaft to Case (4-Tang) (Metal).....	64-98	1	TH400.THW15

ILL NO.	DESCRIPTION	YEARS	QTY	PART NO
<b>THRUST BEARINGS &amp; WASHERS Cont...</b>				
609G	Output Shaft to Case (3 Tang) Selective (1.93mm Thick) .....	64-98	AR	TH400.THW16
	Selective (2.13mm Thick) .....	64-98	AR	TH400.THW17
	Selective (2.34mm Thick) .....	64-98	AR	TH400.THW18
	Selective (2.54mm Thick) .....	64-98	AR	TH400.THW19
	Selective (2.74mm Thick) .....	64-98	AR	TH400.THW20
	Selective (2.95mm Thick) .....	64-98	AR	TH400.THW21
609G	Case Saver (3 Tang Washer Replacement) .	64-98	1	TH400.THW23
650E	Bearing w/ Race, Center Support to Sun Gear.....	64-98	1	TH400.THW11
651F	Bearing w/ Race, Sun Gear to Rear Ring Gear.....	64-98	1	TH400.THW13
652F	Bearing w/ Race, Rear Ring Gear to Output Shaft.....	64-98	1	TH400.THW14
<b>ELECTRICAL COMPONENTS</b>				
700H	Detent Solenoid .....	64-98	1	TH400.SOL01
701H	Connector, 1 Prong (Small OD) 1964		1	TH400.ELE03
701H	Connector, 1 Prong (Large OD)	68-98	1	TH400.ELE04
701H	Connector, 2 Prong.....	70-82	1	TH400.ELE01
702G	Rotor for Electronic VSS .....	65-98	1	TH400.ELE06
703H	Late Speed Sensor(VSS) (For Electronic Speedo) .....	65-98	1	TH400.ELE05
<b>VALVE BODY PARTS</b>				
Kit	Shift Kit®.....	64-98	1	TH400.SK01
Kit	Reprogramming Kit™, Heavy Duty & Competition.....	64-98	1	TH400.SK03
Kit	Reprogramming Kit™, Competition Only, Stick Shift Full Manual Control..	64-98	1	TH400.SK02
Kit	Reverse Cushion, Corrects Harsh Reverse.....	64-98	1	TH400.SK04
Kit	Pressure Regulator & Boost Valve (Sonnax, Fits in Pump) .....	64-98	1	TH400.VA01
<b>HARD PARTS</b>				
Kit	Front Servo, Piston & Sleeve Kit (Sonnax®).....	64-98	1	TH400.ACC02
800A	Pump, 6 Bolt(Body Cast # 895, Stator Cast # 896).....	71-98	1	TH400.PUM01
800A	Pump, 8 Bolt(Body Cast # 895, Stator Cast # 896).....	64-98	1	TH400.PUM03
801A	Pump Gears, (18.47mm Thick) .	64-98	1	TH400.PUM02
806B	Piston, Forward Clutch (Steel) ..	64-98	1	TH400.PIS03
810B	Clutch Hub, Forward Clutch.....	64-98	1	TH400.DRU04
810B	Clutch Hub, Forward Clutch (Heavy Duty) (Sonnax® <a href="#">Click here for Info</a> ) ..	64-98	1	TH400.DRU06
811C	Clutch Hub, Direct Clutch.....	64-98	1	TH400.DRU05
813C	Piston Kit, Direct Clutch (5 Plate Aluminium).....	64-98	1	TH400.PIS05
814C	Piston, Direct Clutch (Steel).....	64-98	1	TH400.PIS03
815D	Direct (5 Clutch No Check Ball) (Smooth Cam, Sprag Clutch)....	64-98	1	TH400.DRU01
815D	Direct (6 Clutch No Check Ball) (Lug Cam, Roller Clutch) .....	64-98	1	TH400.DRU03
816D	Sprag, Intermediate (16 Elements).....	65-77	1	4L80E.OWC04
816D	Sprag, Intermediate (34 Elements) Heavy Duty .....	64-77	1	TH400.OWC03

