

# NISSAN RL4F02A, RE4F02A/V

## 4 SPEED FWD (Electronic & Hydraulic Control)



AUTOMATIC CHOICE



THE AUTOMATIC TRANSMISSION PARTS WAREHOUSE

**A**

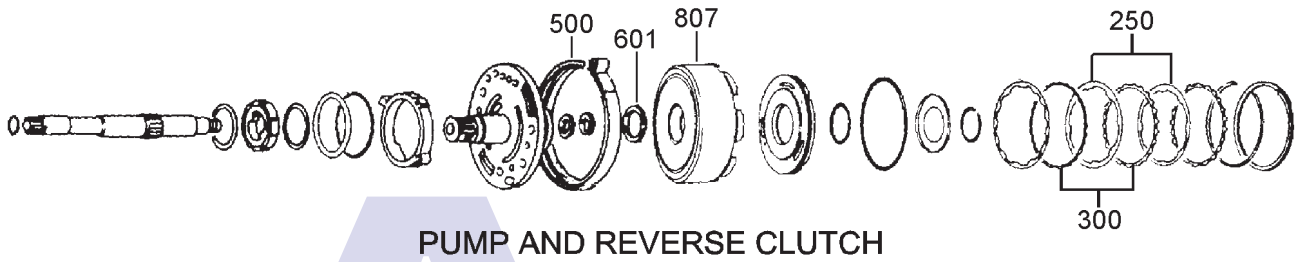

**PUMP AND REVERSE CLUTCH**

**B**

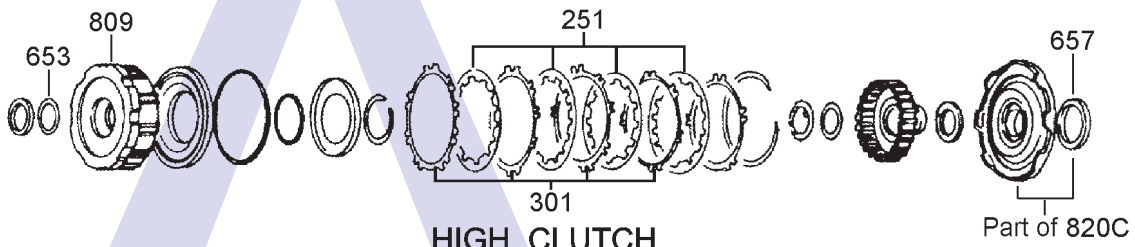

**HIGH CLUTCH**

**C**

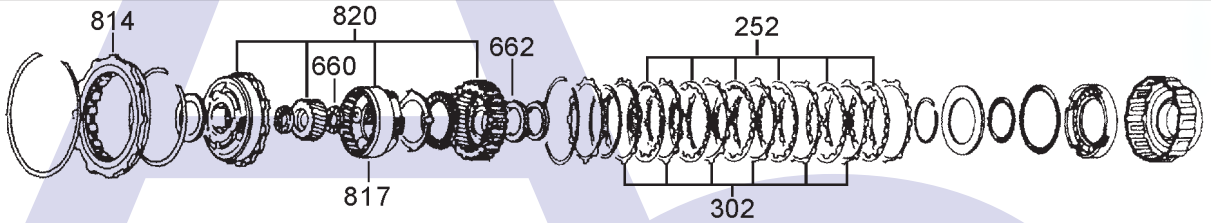

**PLANET SET AND LOW CLUTCH**

**D**

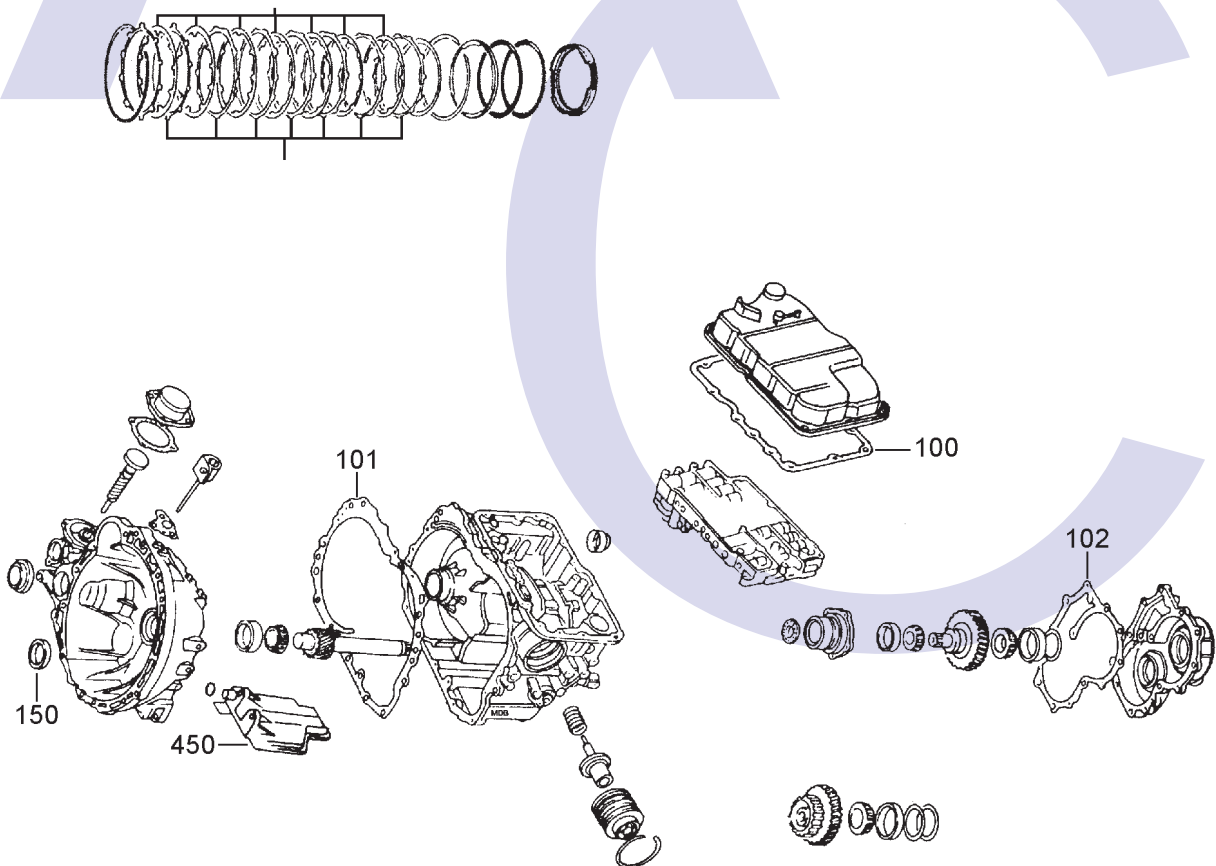

**LOW REVERSE CLUTCH AND CASE**

# NISSAN RL4F02A, RE4F02A/V 4 SPEED FWD (Electronic & Hydraulic Control)



AUTOMATIC CHOICE



THE AUTOMATIC TRANSMISSION PARTS WAREHOUSE

ILL NO.	DESCRIPTION	YEARS	QTY	PART NO
<b>KITS</b>				
Kit	Overhaul Kit RL4F02A (Transtec).....	85-7/88	1	<b>RL4.OHK01</b>
Kit	Overhaul Kit RL4F02A (Precision).....	85-7/88	1	<b>RL4.OHK52</b>
Kit	Overhaul Kit RL4F02A (Nissan) (Transtec) .....	7/88-ON	1	<b>RL4.OHK05</b>
Kit	Overhaul Kit RE4F02A/V (Maxima) (Transtec).....	89-94	1	<b>RL4.OHK02</b>
Kit	Overhaul Kit RE4F02A/V (Maxima) (Precision).....	89-94	1	<b>RL4.OHK54</b>
Kit	Gasket & Rubber Kit RL4F02A.....	85-ON	1	<b>RL4.GSK01</b>
Kit	Gasket & Rubber Kit RE4F02A Maxima .....	89-ON	1	<b>RL4.GSK02</b>
<b>GASKETS</b>				
100D	Valve Body Cover .....	85-ON	1	<b>RL4.GAS01</b>
101D	Case to Case Gasket.....	85-ON	1	<b>RL4.GAS03</b>
102D	Side Cover Gasket.....	85-ON	1	<b>RL4.GAS02</b>
NI	Upper V. Body Gasket Small (RL4F02A) .....	83-85	1	<b>RL4.GAS05</b>
NI	Upper V. Body Gasket Large (RL4F02A) .....	83-85	1	<b>RL4.GAS06</b>
NI	Lower V. Body Gasket Small (RL4F02A) .....	83-85	1	<b>RL4.GAS07</b>
NI	Lower V. Body Gasket Large (RL4F02A) .....	83-85	1	<b>RL4.GAS08</b>
NI	Upper V. Body Gasket Small (RL4F02A) .....	85-6/88	1	<b>RL4.GAS16</b>
NI	Lower V. Body Gasket Large (RL4F02A) .....	85-6/88	1	<b>RL4.GAS17</b>
NI	Lower V. Body Gasket Small (RL4F02A) .....	85-6/88	1	<b>RL4.GAS18</b>
NI	Upper V. Body Gasket Large (RL4F02A) .....	85-6/88	1	<b>RL4.GAS20</b>
NI	Upper V. Body Gasket Small (RL4F02A) .....	7/88-ON	1	<b>RL4.GAS13</b>
NI	Lower V. Body Gasket Large (RL4F02A) .....	7/88-ON	1	<b>RL4.GAS14</b>
NI	Upper V. Body Gasket Large (RL4F02A) .....	7/88-ON	1	<b>RL4.GAS15</b>
NI	Lower V. Body Gasket Small (RL4F02A) .....	7/88-ON	1	<b>RL4.GAS19</b>
NI	Lower V. Body Gasket Large (RE4F02A Maxima).....	85-ON	1	<b>RL4.GAS09</b>
NI	Upper V. Body Gasket Large (RE4F02A Maxima).....	85-ON	1	<b>RL4.GAS10</b>
NI	Upper V. Body Gasket Small (RE4F02A Maxima).....	85-ON	1	<b>RL4.GAS11</b>
NI	Lower V. Body Gasket Small (RE4F02A Maxima).....	85-ON	1	<b>RL4.GAS12</b>
Kit	Valve Body Gasket Kit Maxima .....	89-ON	1	<b>RL4.GK02</b>
<b>RUBBER COMPONENTS</b>				
Kit	Servo Seal Kit .....	85-ON	1	<b>RL4.ORK01</b>
<b>METAL CLAD SEALS</b>				
150D	Converter Seal.....	85-ON	1	<b>RL4.MCS01</b>

ILL NO.	DESCRIPTION	YEARS	QTY	PART NO
<b>SEALING RINGS</b>				
<b>FRICITION PLATES</b>				
Kit	Friction Plate (RE4F02A).....	89-94	1	<b>RL4.FRK01</b>
Kit	Friction Plate (Alto) (RL4F02A) (Bluebird/Maxima).....	85 Only	1	<b>RL4.FRK53</b>
Kit	Friction Plate (Alto) (RL4F02A) (Bluebird/Maxima).....	86-88	1	<b>RL4.FRK54</b>
Kit	Friction Plate (Alto) (RL4F02A) (Stanza) .....	86-89	1	<b>RL4.FRK55</b>
Kit	Friction Plate (Alto) (RL4F02A) (Stanza Combo Kit).....	85-89	1	<b>RL4.FRK57</b>
Kit	Friction Plate (Alto) (RL4F02A) (Pulsar) .....	87-90	1	<b>RL4.FRK56</b>
Kit	Friction Plate (Alto) (RE4F02A) (Maxima) .....	89-94	1	<b>RE4.FRK53</b>
Kit	Friction Plate (Alto) (RE4F02A) (Stanza) .....	90-92	1	<b>RE4.FRK54</b>
250A	Reverse Input (147mm OD x 2.00mm x 8T) ....	85-89	2	<b>RL4.FRP03</b>
250A	Reverse Input (Alto) (150mm OD x 2.00mm x 8T) ....	85-89	2	<b>RL4.FRP59</b>
250A	Reverse Input (150mm OD x 2.00mm x 34T) ..	87-94	2	<b>RL4.FRP09</b>
251B	High Square Teeth (128mm OD x 1.60mm x 30T) ..	85	3	<b>RL4.FRP07</b>
251B	High Square Teeth (Alto) (128mm OD x 1.60mm x 30T) ..	85	3	<b>RL4.FRP58</b>
251B	High Square Teeth (128mm OD x 2.00mm x 30T) ..	85	3	<b>RL4.FRP05</b>
251B	High Shark Tooth (Maxima) (128mm OD x 1.60mm x 30T) ..	85-94	4	<b>RL4.FRP02</b>
251B	High Shark Tooth (128mm OD x 2.00mm x 30T) ..	85-94	3	<b>RL4.FRP06</b>
251B	High Wide Tooth (Aftermarket) (132mm OD x 1.60mm x 30T) ..	87-94	4	<b>RL4.FRP08</b>
251B	High Wide Tooth (OEM) (132mm OD x 1.60mm x 30T) ..	87-94	4	<b>RL4.FRP18</b>
252C	Low Clutch (144mm OD x 2.00mm x 30T) ..	85-94	4-6	<b>RL4.FRP01</b>
253D	Low & Reverse (183mm OD x 2.00mm x 12T) ..	85-94	5-7	<b>RL4.FRP04</b>
253D	Low & Reverse (Alto) (183mm OD x 2.00mm x 12T) ..	85-94	5-7	<b>RL4.FRP57</b>
<b>STEEL PLATES</b>				
Kit	Steel Plate (RE4F02A).....	89-94	1	<b>RL4.STK01</b>
Kit	Steel Plate (Alto) (RL4F02A) (Bluebird/Maxima).....	85 Only	1	<b>RL4.STK53</b>
Kit	Steel Plate (Alto) (RL4F02A) (Bluebird/Maxima).....	86-88	1	<b>RL4.STK54</b>
Kit	Steel Plate (Alto) (RL4F02A) (Stanza Combo Kit).....	85-89	1	<b>RL4.STK55</b>
Kit	Steel Plate (Alto) (RL4F02A) (Pulsar) .....	87-90	1	<b>RL4.STK56</b>
Kit	Steel Plate (Alto) (RE4F02A) (Maxima) .....	89-94	1	<b>RE4.STK53</b>
Kit	Steel Plate (Alto) (RE4F02A) (Stanza) .....	90-92	1	<b>RE4.STK54</b>
300A	Reverse Input Shark Tooth (136mm ID x 2.00mm x 30T) ....	85-94	2	<b>RL4.STP03</b>
300A	Reverse Input Square Tooth (136mm ID x 2.00mm x 30T) ....	85-94	2-3	<b>RL4.STP09</b>

# NISSAN RL4F02A, RE4F02A/V

## 4 SPEED FWD (Electronic & Hydraulic Control)



AUTOMATIC CHOICE



THE AUTOMATIC TRANSMISSION PARTS WAREHOUSE

ILL NO.	DESCRIPTION	YEARS	QTY	PART NO
<b>STEEL PLATES Cont...</b>				
301B	High Cl;utch (Maxima) (112mm ID x 1.40mm x 24T) ....	87-94	7	<b>RL4.STP03</b>
301B	High Cl;utch (112mm ID x 1.80mm x 24T) ....	85-88	7	<b>RL4.STP01</b>
301B	High Cl;utch (112mm ID x 2.00mm x 24T) ....	85-88	1-5	<b>RL4.STP02</b>
301B	High Cl;utch (112mm ID x 2.70mm x 24T) ....	85-89	3	<b>RL4.STP16</b>
301B	High Cl;utch (112mm ID x 3.00mm x 24T) ....	85	3	<b>RL4.STP12</b>
301B	High Clutch (112mm ID x 1.70mm x 27T) ....	89-8/89	1	<b>RL4.STP13</b>
301B	High Clutch (112mm ID x 2.00mm x 27T) ....	8/89-94	1	<b>RL4.STP11</b>
301B	High Clutch (112mm ID x 2.40mm x 27T) ....	90-94	4	<b>RL4.STP15</b>
301B	High Clutch (112mm ID x 3.00mm x 27T) ....	87-94	3	<b>RL4.STP10</b>
302C	Low Clutch (123mm ID x 2.00mm x 12T) ....	85-94	5-7	<b>RL4.STP06</b>
303D	Low & Reverse (165mm ID x 2.00mm x 12T) ....	85-94	5-7	<b>RL4.STP07</b>
<b>PRESSURE PLATES</b>				
<b>SPRINGS &amp; CIRCLIPS</b>				
<b>FILTERS</b>				
450D	Filter .....	85-ON	1	<b>RL4.FIL01</b>
<b>BANDS</b>				
500A	Band.....	85-ON	1	<b>RL4.BAN01</b>
500A	Band (Borg Warner).....	85-ON	1	<b>RL4.BAN02</b>
<b>BUSHINGS</b>				
Kit	Bush Kit.....	85-ON	1	<b>RL4.BK01</b>
NI	Converter Bush.....	85-ON	1	<b>RL4.BUS01</b>
NI	Pump Cover (Front) .....	85-ON	1	<b>RL4.BUS02</b>
NI	Pump Stator (Centre).....	85-ON	1	<b>RL4.BUS03</b>
NI	Reverse Input Drum.....	85-ON	1	<b>RL4.BUS04</b>
<b>THRUST WASHERS &amp; BEARINGS</b>				
Kit	Planetary Bearing Kit .....	85-94	1	<b>RL4.TWK02</b>
601A	Thrust Washer Pump - Rev Input (Sel 0.89mm Thick Plastic) .....	85-94	AR	<b>RL4.THW01</b>
601A	Thrust Washer Pump - Rev Input (Sel 1.00mm Thick Plastic) .....	85-94	AR	<b>RL4.THW02</b>
601A	Thrust Washer Pump - Rev Input (Sel 1.30mm Thick Plastic) .....	85-94	AR	<b>RL4.THW03</b>
601A	Thrust Washer Pump - Rev Input (Sel 1.70mm Thick Plastic) .....	85-94	AR	<b>RL4.THW04</b>

ILL NO.	DESCRIPTION	YEARS	QTY	PART NO
<b>THRUST WASHERS &amp; BEARINGS Cont...</b>				
601A	Thrust Washer Pump - Rev Input (Sel 1.93mm Thick Plastic) .....	85-94	AR	<b>RL4.THW05</b>
653B	Race Pump to High Drum (Sel 1.60mm Thick 3 Tang) .....	85-94	AR	<b>RL4.THW10</b>
653B	Race Pump to High Drum (Sel 1.78mm Thick 3 Tang) .....	85-94	AR	<b>RL4.THW11</b>
653B	Race Pump to High Drum (Sel 2.00mm Thick 3 Tang) .....	85-94	AR	<b>RL4.THW112</b>
657B	Race Sun Shell to Planet.....	85-94	1	<b>RL4.THW07</b>
660C	Bearing Sun Gear to Planetary ..	85-94	1	<b>RL4.THW13</b>
662C	Race Rear Ring Gear to Case ..	85-94	1	<b>RL4.THW06</b>
<b>ELECTRICAL COMPONENTS</b>				
NI	Solenoid Block RE4F02A Maxima .....	89-ON	1	<b>RL4.SOL01</b>
NI	EPC Solenoid.....	89-94	1	<b>RL4.SOL02</b>
<b>VALVE BODY PARTS</b>				
NI	Boost Valve Sleeve .....	85-94	1	<b>RL4.SL01</b>
<b>HARD PARTS</b>				
807A	Reverse Input Drum (Cast).....	85-94	1	<b>RL4.DRU01</b>
807A	Reverse Input Drum (Steel).....	85-94	1	<b>RL4.DRU02</b>
809B	High Drum 24 Tooth.....	85-ON	1	<b>RL4.DRU03</b>
809B	High Drum 27 Tooth.....	85-ON	1	<b>RL4.DRU04</b>
814C	Low Roller Clutch.....	85-ON	1	<b>RL4.OWC01</b>
817C	Rear Planetary Assembly.....	85-ON	1	<b>RL4.PL06</b>
820C	Planetary Package (4 Cylinder Rebuilt) .....	85-ON	1	<b>RL4.PL03</b>
820C	Planetary Package (6 Cylinder Maxima Rebuilt).....	89-ON	1	<b>RL4.PL05</b>
<b>SPECIAL ITEMS</b>				
<b>TOOLS &amp; MANUALS</b>				
NI	ATSG Rebuild Manual (RL4F02A) .....	All		<b>RL4.MAN01</b>
NI	ATSG Rebuild Manual (RE4F02A Maxima).....	All		<b>RL4.MAN02</b>